

# Technical data sheet · Metal accessory expansion EW

Cable fittings and accessories



<b>Identification</b>	Type	EW MS M32/M40
	Part-No.	600284
<b>Use/Application/Characteristics</b>		
Characteristics	<ul style="list-style-type: none"><li>• Expansion from <b>metric to metric</b></li><li>• with small outer thread and large inner thread</li></ul>	
<b>Technical data</b>		
Outer Ø	42 mm	
Thread form	metric	
Thread G	M 32×1.5	
Thread G1	M 40×1.5	
L	24.5 mm	
L1	8 mm	
<b>Construction</b>		
Description	EW MS M32/M40	
Material	Brass nickel-plated	
<b>General</b>		
PU	50 Quantity	

28.01.2017 – Subject to technical modification

Part-No. 600284

USA: LUTZE INC.

13330 South Ridge Drive • Charlotte, NC 28273, USA  
Tel. +1 (704) 504-0222 • Fax +1 (704) 504-0223  
www.lutze.com • info@lutze.com

United Kingdom: LÜTZE Ltd.

Unit 3, Sandy Hill Park  
Sandy Way, Amington • GB-Tamworth, Staffs B77 4DU  
Tel. +44 (0)1827 31333-0 • Fax +44 (0)1827 31333-2  
www.lutze.com • sales.gb@lutze.co.uk

# Technical data sheet · Metal accessory expansion EW

---

## Dimensions

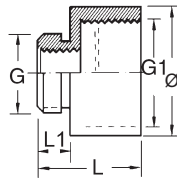

28.01.2017 – Subject to technical modification

Part-No. 600284

USA: LUTZE INC.

13330 South Ridge Drive • Charlotte, NC 28273, USA  
Tel. +1 (704) 504-0222 • Fax +1 (704) 504-0223  
www.lutze.com • info@lutze.com

United Kingdom: LÜTZE Ltd.

Unit 3, Sandy Hill Park  
Sandy Way, Amington • GB-Tamworth, Staffs B77 4DU  
Tel. +44 (0)1827 31333-0 • Fax +44 (0)1827 31333-2  
www.lutze.com • sales.gb@lutze.co.uk



SYSTEMATIC TECHNOLOGY