

Technical data sheet · Metal accessory Locknut GMS EMC

Cable fittings and accessories



Identification	Type	GMS EMV M50
	Part-No.	600466
Use/Application/Characteristics		
Characteristics	<ul style="list-style-type: none">• Hexagonal nut for potential equalisation• With cutting edges for cutting through layers of paint or power coating for optimal contact	
Technical data		
Thread form	metric	
Thread G	M 50×1.5	
SW	60 mm	
S1	6 mm	
S2	5 mm	
Construction		
Description	GMS EMC M50	
Material	Brass nickel-plated	
General		
PU	10 Quantity	

28.01.2017 – Subject to technical modification

Part-No. 600466

USA: LUTZE INC.

13330 South Ridge Drive • Charlotte, NC 28273, USA
Tel. +1 (704) 504-0222 • Fax +1 (704) 504-0223
www.lutze.com • info@lutze.com

United Kingdom: LÜTZE Ltd.

Unit 3, Sandy Hill Park
Sandy Way, Amington • GB-Tamworth, Staffs B77 4DU
Tel. +44 (0)1827 31333-0 • Fax +44 (0)1827 31333-2
www.lutze.com • sales.gb@lutze.co.uk



SYSTEMATIC TECHNOLOGY

Technical data sheet · Metal accessory Locknut GMS EMC

Dimensions

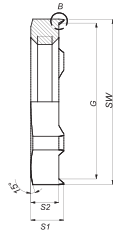

28.01.2017 – Subject to technical modification

Part-No. 600466

USA: LUTZE INC.

13330 South Ridge Drive • Charlotte, NC 28273, USA
Tel. +1 (704) 504-0222 • Fax +1 (704) 504-0223
www.lutze.com • info@lutze.com

United Kingdom: LÜTZE Ltd.

Unit 3, Sandy Hill Park
Sandy Way, Amington • GB-Tamworth, Staffs B77 4DU
Tel. +44 (0)1827 31333-0 • Fax +44 (0)1827 31333-2
www.lutze.com • sales.gb@lutze.co.uk



SYSTEMATIC TECHNOLOGY