

Technical data sheet · Metal accessory expansion EW

Cable fittings and accessories



Identification	Type	EW MS PG29/PG36
	Part-No.	600511
Use/Application/Characteristics		
Characteristics	<ul style="list-style-type: none">• Expansion from PG to PG• with small outer thread and large inner thread	
Technical data		
Outer Ø	50 mm	
Thread form	PG	
Thread G	PG 29	
Thread G1	PG 36	
L	27.5 mm	
L1	8 mm	
Construction		
Description	EW MS PG29/PG36	
Material	Brass nickel-plated	
General		
PU	25 Quantity	

28.01.2017 – Subject to technical modification

Part-No. 600511

USA: LUTZE INC.

13330 South Ridge Drive • Charlotte, NC 28273, USA
Tel. +1 (704) 504-0222 • Fax +1 (704) 504-0223
www.lutze.com • info@lutze.com

United Kingdom: LÜTZE Ltd.

Unit 3, Sandy Hill Park
Sandy Way, Amington • GB-Tamworth, Staffs B77 4DU
Tel. +44 (0)1827 31333-0 • Fax +44 (0)1827 31333-2
www.lutze.com • sales.gb@lutze.co.uk



SYSTEMATIC TECHNOLOGY

Technical data sheet · Metal accessory expansion EW

Dimensions

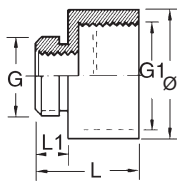

28.01.2017 – Subject to technical modification

Part-No. 600511

USA: LUTZE INC.

13330 South Ridge Drive • Charlotte, NC 28273, USA

Tel. +1 (704) 504-0222 • Fax +1 (704) 504-0223

www.lutze.com • info@lutze.com

United Kingdom: LÜTZE Ltd.

Unit 3, Sandy Hill Park

Sandy Way, Amington • GB-Tamworth, Staffs B77 4DU

Tel. +44 (0)1827 31333-0 • Fax +44 (0)1827 31333-2

www.lutze.com • sales.gb@lutze.co.uk



SYSTEMATIC TECHNOLOGY