

Identification	Type	LCOS-FTE-PE-700-NC-01-1
	Part-No.	780701.700.1
Use/Application/Properties		
Description	Function carrier 70 mm, with supply AC 240 V, no FBS, with PE direct contact, ready for connection	
Technical data		
Operating voltage	max. AC/DC 500 V UL max. 300 V max. AC/DC 16 A, 100 % ED	
Voltage drop	Powerbus at $I_{max} < 80$ mV	
General		
Dimensions (w x h x d)	70.0 x 110.0 x 39.0 mm	
Material	Polyamid PA 6.6 (UL 94 V0, NFF I2, F2)	
Field installation	Din rail TS35 (EN 60715)	
Marking	2 x Labelling plates 5x5 mm	
General ambient conditions		
Operation temperature range	-40 °C – 85 °C	
Storage temperature range	-40 °C – 85 °C	
Relative humidity	5 % – 95 % without condensing	
Protection class	IP 20	

03.04.2016 – Subject to technical modification

Part-No. 780701.700.1

USA: LUTZE INC.

13330 South Ridge Drive • Charlotte, NC 28273, USA
Tel. +1 (704) 504-0222 • Fax +1 (704) 504-0223
www.lutze.com • info@lutze.com

United Kingdom: LUTZE Ltd.

Unit 3, Sandy Hill Park
Sandy Way, Amington • GB-Tamworth, Staffs B77 4DU
Tel. +44 (0)1827 31333-0 • Fax +44 (0)1827 31333-2
www.lutze.com • sales.gb@lutze.co.uk



SYSTEMATIC TECHNOLOGY

Technical data sheet - Modular housing system

Standards

Loads from pollutants IEC 60068-2-42, IEC 60068-2-43
Insulation coordination EN 60064-1, EN 60947-1, EN 50175, EN 50124-1
Shock resistance 15 G/11 ms, IEC 60068-2-27
Vibration resistance 4 G, IEC 60068-2-8

Approvals

cURus

Dimensions

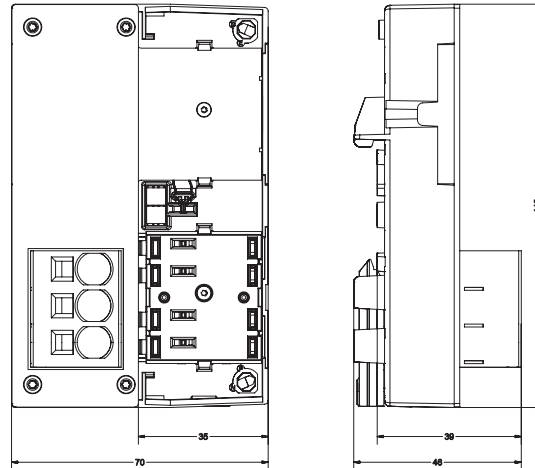

03.04.2016 – Subject to technical modification

Part-No. 780701.700.1

USA: LUTZE INC.

13330 South Ridge Drive • Charlotte, NC 28273, USA
Tel. +1 (704) 504-0222 • Fax +1 (704) 504-0223
www.lutze.com • info@lutze.com

United Kingdom: LUTZE Ltd.

Unit 3, Sandy Hill Park
Sandy Way, Amington • GB-Tamworth, Staffs B77 4DU
Tel. +44 (0)1827 31333-0 • Fax +44 (0)1827 31333-2
www.lutze.com • sales.gb@lutze.co.uk