

M12 female recept. 8p. shielded RM Ethernet

TPE 4x2xAWG24 shielded bl UL/CSA+drag chain 10.0m

Flange M12 female

USA

8-pole, shielded

Rear mounting

Mounting nut

With open ended wires

Further cable lengths on request. The resistance to aggressive media should be individually tested for your application. Further details on request.

[Link to Product](#)**Illustration**

1	■	white/blue
2	■	white/brown
3	■	brown
4	■	orange
5	■	white/green
6	■	white/orange
7	■	blue
8	■	green
		shield

Female

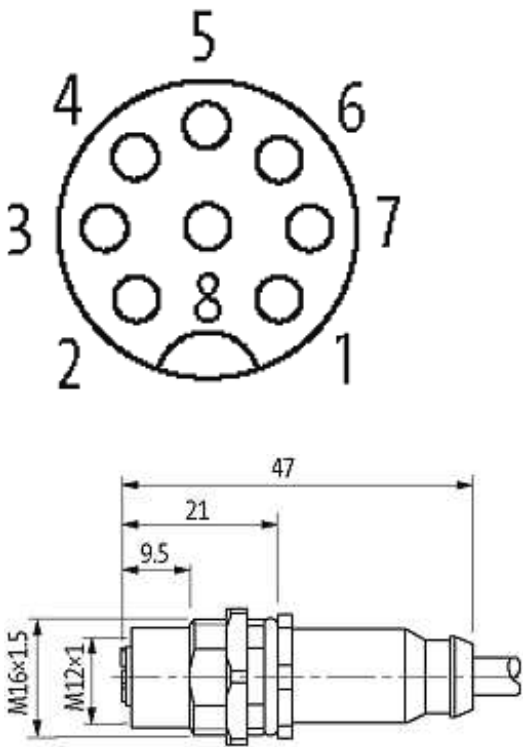

Product may differ from Image

Approvals

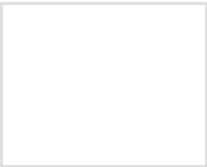

More Info



Form

Form 17511

Cables

Cable number	S4W
No./diameter of wires	4 × 2 × AWG 24
Wire isolation	HDPE (whbl, bl, whor, or, whgn, gn, whbr, br)
C-track properties	1 Mio.
Torsion	3 Mio.
Jacket Color	blue
Shore hardness outer jacket	80 ± 5A

Material (jacket)	TPE (UL/CSA)
Outer Ø	approx. 7.6 mm
Bend radius (fixed)	5 × outer Ø
Bend radius (moving)	10 × outer Ø
Temperature range (fixed)	-40...+80 °C
Temperature range (mobile)	-40...+80 °C
Shielded	yes

Technical Data

Operating voltage	max. 30 V AC/DC
Operating current per contact	max. 2 A
Transfer parameters	CAT5, class D (ISO/IEC 11801:2002), (EN 50173-1)
Transfer rate	to 100 Mbit/s Full Duplex
Coding	8-pole
Locking of ports	Screw thread M12 × 1 mm (recommended torque 0.6 Nm) self-securing
Protection	IP66K, IP67 inserted and tightened (EN 60529)
Locking material	CuZn, nickel plated

Commercial data

country of origin	DE
customs tariff number	85444290
minimum order quantity	1