

**Description:**

The DOL range of motor starters and DOLSD range of motor starters with switch disconnectors are safely protected in flame-proof enclosures. They are suitable for Ex e motors. They are available with various contactor ratings and coil voltages.

**Application:**

The DOL and DOLSD ranges of motor starters are designed for safe operation of machinery and drives in gas or dust explosion hazardous areas.

**Materials:**

Body: Cast iron, aluminium and stainless steel.  
Screws: Stainless steel.  
For details see data tables overleaf.

**Certification characteristics:**

Marking to 94/9/EC: II 2GD  
Zones: 1 – 21 – 2 – 22

For type of protection, certificates, ambient temperature ranges and ingress protection please see data tables overleaf.

**Threads:**

Metric threaded, for details see Mechanical Specification.

**Inhibiting treatments:**

Zinc rich epoxy powder primer plus epoxy powder top coat black.

**Features:**

Labeling: OFF – ON (DOLSD range only)  
Operator lock: Padlockable in OFF position (DOLSD range only)  
Enclosure cover: hinged non-detachable  
Mounting: 2 x fabricated stainless steel mounting straps.

**Drawing DOL**

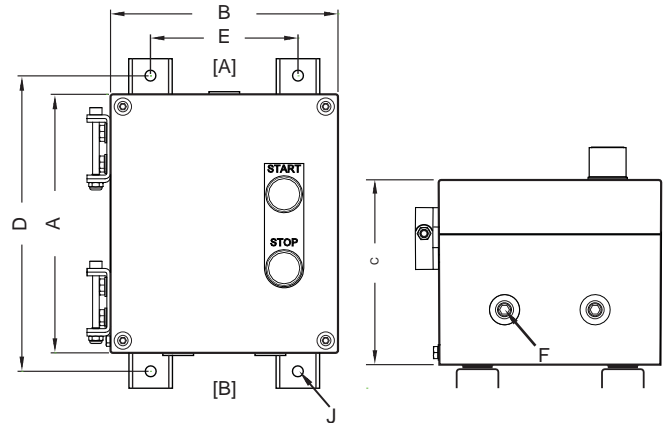

**Legend:**

- A - Maximum external dimension.
- B - Maximum external dimension.
- C - Maximum external dimension.
- D - Fixing holes wheel base.
- E - Fixing holes wheel base.
- F - Cable entry diameter.
- J - Fixing holes diameter.
- [A] - Entry face.
- [B] - Entry face.

For details see Dimensions Data Table.

**Enclosure types:**

For drawing references, dimensions [mm] and approx. weight [kg] see Dimensions Data Table.

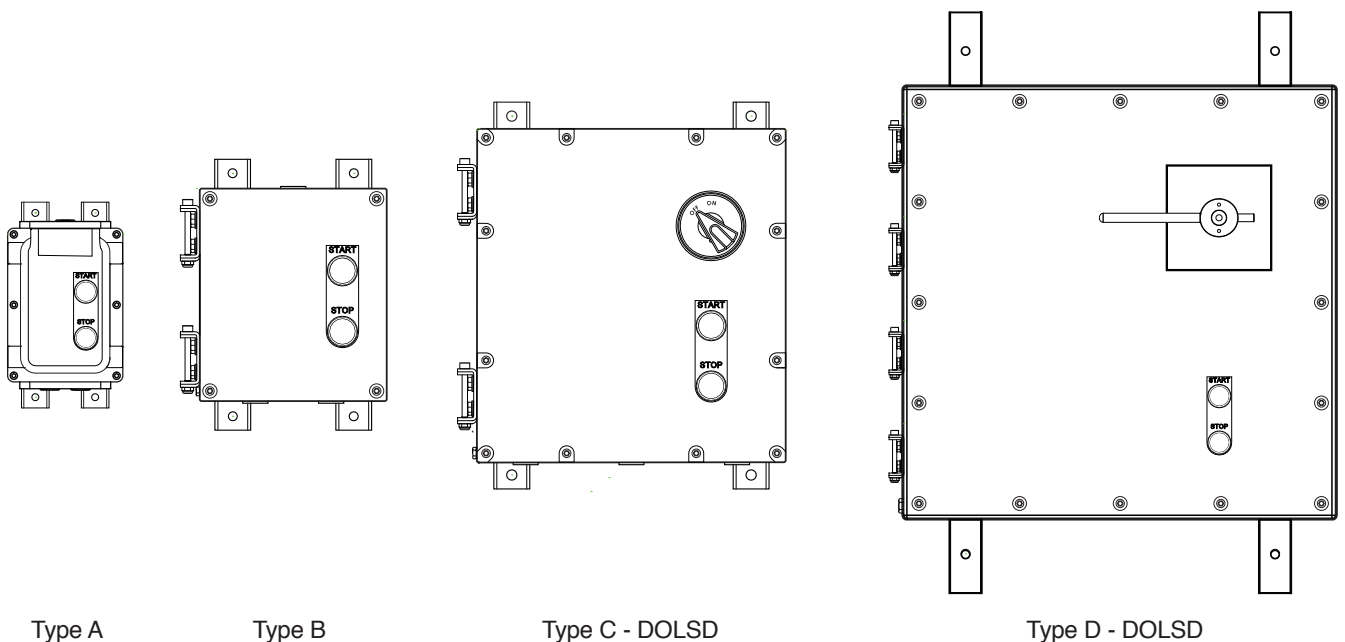

Release date 2013-09-20 T164876

## DOL/DOLSD - Electrical Specification

Type	Power	Current AC3	Coil Voltage	Terminal capacity	Grounding	Overload relay	Poles *2*	Enclosure material
	[kW]	[A]	[V]	[mm <sup>2</sup> ]	see *1*		qty.	
DOL1.1/240	1.1	7	240	2x 1 ... 6, 2x 1 ... 4	-	4 ... 6 A	-	cast iron
DOL1.5/240	1.5	7	240	2x 1 ... 6, 2x 1 ... 4	-	6 ... 10 A	-	cast iron
DOL2.2/240	2.2	7	240	2x 1 ... 6, 2x 1 ... 4	-	6 ... 10 A	-	cast iron
DOL3/240	3	7	240	2x 1 ... 6, 2x 1 ... 4	-	6 ... 10 A	-	cast iron
DOL4/240	4	9	240	2x 1 ... 6, 2x 1 ... 4	-	6 ... 10 A	-	cast iron
DOL4/415	4	9	415	2x 1 ... 6, 2x 1 ... 4	-	6 ... 10 A	-	cast iron
DOL5.5/240	5.5	12	240	2x 1 ... 6, 2x 1 ... 4	-	9 ... 12 A	-	cast iron
DOL5.5/415	5.5	12	415	2x 1 ... 6, 2x 1 ... 4	-	9 ... 12 A	-	cast iron
DOL7.5/240	7.5	15	240	2x 1 ... 6, 2x 1 ... 4	-	12 ... 16 A	-	cast iron
DOL7.5/415	7.5	15	415	2x 1 ... 6, 2x 1 ... 4	-	12 ... 16 A	-	cast iron
DOL11/240/AL	11	25	240	7x 1.5 ... 16	1x	16 ... 24 A	-	cast aluminium
DOL11/240/CI	11	25	240	7x 1.5 ... 16	1x	16 ... 24 A	-	cast iron
DOL11/240/SS	11	25	240	7x 1.5 ... 16	1x	16 ... 24 A	-	cast stainless steel
DOL11/415/AL	11	25	415	7x 1.5 ... 16	1x	16 ... 24 A	-	cast aluminium
DOL11/415/CI	11	25	415	7x 1.5 ... 16	1x	16 ... 24 A	-	cast iron
DOL11/415/SS	11	25	415	7x 1.5 ... 16	1x	16 ... 24 A	-	cast stainless steel
DOL15/240/AL	15	32	240	7x 1.5 ... 16	1x	24 ... 32 A	-	cast aluminium
DOL15/240/CI	15	32	240	7x 1.5 ... 16	1x	24 ... 32 A	-	cast iron
DOL15/240/SS	15	32	240	7x 1.5 ... 16	1x	24 ... 32 A	-	cast stainless steel
DOL15/415/AL	15	32	415	7x 1.5 ... 16	1x	24 ... 32 A	-	cast aluminium
DOL15/415/CI	15	32	415	7x 1.5 ... 16	1x	24 ... 32 A	-	cast iron
DOL15/415/SS	15	32	415	7x 1.5 ... 16	1x	24 ... 32 A	-	cast stainless steel
DOL18.5/240/AL	18.5	40	240	8x 1.5 ... 16, 6x 0.5 ... 4	2x	24 ... 40 A	-	cast aluminium
DOL18.5/240/CI	18.5	40	240	8x 1.5 ... 16, 6x 0.5 ... 4	2x	24 ... 40 A	-	cast iron
DOL18.5/240/SS	18.5	40	240	8x 1.5 ... 16, 6x 0.5 ... 4	2x	24 ... 40 A	-	cast stainless steel
DOL18.5/415/AL	18.5	40	415	8x 1.5 ... 16, 6x 0.5 ... 4	2x	24 ... 40 A	-	cast aluminium
DOL18.5/415/CI	18.5	40	415	8x 1.5 ... 16, 6x 0.5 ... 4	2x	24 ... 40 A	-	cast iron
DOL18.5/415/SS	18.5	40	415	8x 1.5 ... 16, 6x 0.5 ... 4	2x	24 ... 40 A	-	cast stainless steel
DOL22/240/AL	22	50	240	8x 1.5 ... 16, 6x 0.5 ... 4	2x	40 ... 57 A	-	cast aluminium
DOL22/240/CI	22	50	240	8x 1.5 ... 16, 6x 0.5 ... 4	2x	40 ... 57 A	-	cast iron
DOL22/240/SS	22	50	240	8x 1.5 ... 16, 6x 0.5 ... 4	2x	40 ... 57 A	-	cast stainless steel
DOL22/415/AL	22	50	415	8x 1.5 ... 16, 6x 0.5 ... 4	2x	40 ... 57 A	-	cast aluminium
DOL22/415/CI	22	50	415	8x 1.5 ... 16, 6x 0.5 ... 4	2x	40 ... 57 A	-	cast iron
DOL22/415/SS	22	50	415	8x 1.5 ... 16, 6x 0.5 ... 4	2x	40 ... 57 A	-	cast stainless steel
DOLSD22/240/AL	22	50	240	8x 1.5 ... 16, 6x 0.5 ... 4	2x	40 ... 57 A	4	cast aluminium
DOLSD22/240/CI	22	50	240	8x 1.5 ... 16, 6x 0.5 ... 4	2x	40 ... 57 A	4	cast iron
DOLSD22/240/SS	22	50	240	8x 1.5 ... 16, 6x 0.5 ... 4	2x	40 ... 57 A	4	cast stainless steel
DOLSD22/415/AL	22	50	415	8x 1.5 ... 16, 6x 0.5 ... 4	2x	40 ... 57 A	4	cast aluminium
DOLSD22/415/CI	22	50	415	8x 1.5 ... 16, 6x 0.5 ... 4	2x	40 ... 57 A	4	cast iron
DOLSD22/415/SS	22	50	415	8x 1.5 ... 16, 6x 0.5 ... 4	2x	40 ... 57 A	4	cast stainless steel

Table continues overleaf

## DOL/DOLSD - Electrical Specification continued

Type	Power	Current AC3	Coil Voltage	Terminal capacity	Grounding	Overload relay	Poles *2*	Enclosure material
	[kW]	[A]	[V]	[mm <sup>2</sup> ]	see *1*		qty.	
DOL30/240/AL	30	65	240	8x 1.5 ... 16, 6x 0.5 ... 4	2x	40...57 A	-	cast aluminium
DOL30/240/CI	30	65	240	8x 1.5 ... 16, 6x 0.5 ... 4	2x	40...57 A	-	cast iron
DOL30/240/SS	30	65	240	8x 1.5 ... 16, 6x 0.5 ... 4	2x	40...57 A	-	cast stainless steel
DOL30/415/AL	30	65	415	8x 1.5 ... 16, 6x 0.5 ... 4	2x	40...57 A	-	cast aluminium
DOL30/415/CI	30	65	415	8x 1.5 ... 16, 6x 0.5 ... 4	2x	40...57 A	-	cast iron
DOL30/415/SS	30	65	415	8x 1.5 ... 16, 6x 0.5 ... 4	2x	40...57 A	-	cast stainless steel
DOLSD30/240/AL	30	65	240	8x 1.5 ... 16, 6x 0.5 ... 4	2x	40...57 A	4	cast aluminium
DOLSD30/240/CI	30	65	240	8x 1.5 ... 16, 6x 0.5 ... 4	2x	40...57 A	4	cast iron
DOLSD30/240/SS	30	65	240	8x 1.5 ... 16, 6x 0.5 ... 4	2x	40...57 A	4	cast stainless steel
DOLSD30/415/AL	30	65	415	8x 1.5 ... 16, 6x 0.5 ... 4	2x	40...57 A	4	cast aluminium
DOLSD30/415/CI	30	65	415	8x 1.5 ... 16, 6x 0.5 ... 4	2x	40...57 A	4	cast iron
DOLSD30/415/SS	30	65	415	8x 1.5 ... 16, 6x 0.5 ... 4	2x	40...57 A	4	cast stainless steel
DOL55/240/AL	55	115	240	8x 10 ... 50, 6x 0.5 ... 4	2x	95...125 A	-	cast aluminium
DOL55/240/CI	55	115	240	8x 10 ... 50, 6x 0.5 ... 4	2x	95...125 A	-	cast iron
DOL55/240/SS	55	115	240	8x 10 ... 50, 6x 0.5 ... 4	2x	95...125 A	-	cast stainless steel
DOL55/415/AL	55	115	415	8x 10 ... 50, 6x 0.5 ... 4	2x	95...125 A	-	cast aluminium
DOL55/415/CI	55	115	415	8x 10 ... 50, 6x 0.5 ... 4	2x	95...125 A	-	cast iron
DOL55/415/SS	55	115	415	8x 10 ... 50, 6x 0.5 ... 4	2x	95...125 A	-	cast stainless steel
DOLSD55/240/AL	55	115	240	8x 10 ... 50, 6x 0.5 ... 4	2x	95...125 A	4	cast aluminium
DOLSD55/240/CI	55	115	240	8x 10 ... 50, 6x 0.5 ... 4	2x	95...125 A	4	cast iron
DOLSD55/240/SS	55	115	240	8x 10 ... 50, 6x 0.5 ... 4	2x	95...125 A	4	cast stainless steel
DOLSD55/415/AL	55	115	415	8x 10 ... 50, 6x 0.5 ... 4	2x	95...125 A	4	cast aluminium
DOLSD55/415/CI	55	115	415	8x 10 ... 50, 6x 0.5 ... 4	2x	95...125 A	4	cast iron
DOLSD55/415/SS	55	115	415	8x 10 ... 50, 6x 0.5 ... 4	2x	95...125 A	4	cast stainless steel
DOL75/240/AL	75	150	240	8x 10 ... 70, 6x 0.5 ... 4	2x	120...142 A	-	cast aluminium
DOL75/240/CI	75	150	240	8x 10 ... 70, 6x 0.5 ... 4	2x	120...142 A	-	cast iron
DOL75/240/SS	75	150	240	8x 10 ... 70, 6x 0.5 ... 4	2x	120...142 A	-	cast stainless steel
DOL75/415/AL	75	150	415	8x 10 ... 70, 6x 0.5 ... 4	2x	120...142 A	-	cast aluminium
DOL75/415/CI	75	150	415	8x 10 ... 70, 6x 0.5 ... 4	2x	120...142 A	-	cast iron
DOL75/415/SS	75	150	415	8x 10 ... 70, 6x 0.5 ... 4	2x	120...142 A	-	cast stainless steel
DOLSD75/240/AL	75	150	240	8x 10 ... 70, 6x 0.5 ... 4	2x	120...142 A	4	cast aluminium
DOLSD75/240/CI	75	150	240	8x 10 ... 70, 6x 0.5 ... 4	2x	120...142 A	4	cast iron
DOLSD75/240/SS	75	150	240	8x 10 ... 70, 6x 0.5 ... 4	2x	120...142 A	4	cast stainless steel
DOLSD75/415/AL	75	150	415	8x 10 ... 70, 6x 0.5 ... 4	2x	120...142 A	4	cast aluminium
DOLSD75/415/CI	75	150	415	8x 10 ... 70, 6x 0.5 ... 4	2x	120...142 A	4	cast iron
DOLSD75/415/SS	75	150	415	8x 10 ... 70, 6x 0.5 ... 4	2x	120...142 A	4	cast stainless steel

Phases: 3

Grounding: Internal &amp; external brass grounding terminals on base and lid

\*1\* number of Ground Terminals

\*2\* Switch Disconnectors only: Auxiliary contacts: 2 x n/o early break

Labelling: OFF – ON

Operator Lock: Padlockable in OFF position

**DOL/DOLSD - Certification characteristics****Marking to 94/9/EC**

II 2 GD

**Type of protection**

- 1.1 Ex d IIB T5 Gb, Ex tb IIIC T82°C Db ( ta ... +55°C )
- 1.2 Ex d IIB T5 Gb, Ex tb IIIC T87°C Db
- 1.3 Ex d IIB T5 Gb, Ex tb IIIC T95°C ( ta ... +55°C )
- 1.4 Ex d IIB T6 Gb, Ex tb IIIC T85°C Db

**Certificate**

- 2.1 SIRA 02 ATEX 1332
- 2.2 SIRA 03 ATEX 1215
- 2.3 SIRA 04 ATEX 1266X
- 2.4 SIRA 04 ATEX 1267X

**Ambient temperature**

- 3.1 -20 ... 55 °C (-4 ... 131 °F)
- 3.2 -40 ... 55 °C (-40 ... 131 °F)

**IECEX approval**

- 4.1 IECEX SIR 08.0056X
- 4.2 IECEX SIR 08.0057X
- 4.3 IECEX SIR 08.0066X
- 4.4 IECEX SIR 08.0055

**GOST-R approval**

- 5.1 GOST-R B01008

Cross-references to product type please see table below

**DOL/DOLSD - Certification cross-reference**

for certification characteristics please see table above

Type	Type of protection	Ambient temperature	Certificate	IECEX	GOST-R
			see (2)	(4)	(5)
<b>DOL1.1/240</b>	Ex d IIB T6 Gb, Ex tb IIIC T85 °C Db	-40 ... 55 °C (-40 ... 131 °F)	2.1	4.3	5.1
<b>DOL1.5/240</b>	Ex d IIB T6 Gb, Ex tb IIIC T85 °C Db	-40 ... 55 °C (-40 ... 131 °F)	2.1	4.3	5.1
<b>DOL2.2/240</b>	Ex d IIB T6 Gb, Ex tb IIIC T85 °C Db	-40 ... 55 °C (-40 ... 131 °F)	2.1	4.3	5.1
<b>DOL3/240</b>	Ex d IIB T6 Gb, Ex tb IIIC T85 °C Db	-40 ... 55 °C (-40 ... 131 °F)	2.1	4.3	5.1
<b>DOL4/240</b>	Ex d IIB T6 Gb, Ex tb IIIC T85 °C Db	-40 ... 55 °C (-40 ... 131 °F)	2.1	4.3	5.1
<b>DOL4/415</b>	Ex d IIB T6 Gb, Ex tb IIIC T85 °C Db	-40 ... 55 °C (-40 ... 131 °F)	2.1	4.3	5.1
<b>DOL5.5/240</b>	Ex d IIB T6 Gb, Ex tb IIIC T85 °C Db	-40 ... 55 °C (-40 ... 131 °F)	2.1	4.3	5.1
<b>DOL5.5/415</b>	Ex d IIB T6 Gb, Ex tb IIIC T85 °C Db	-40 ... 55 °C (-40 ... 131 °F)	2.1	4.3	5.1
<b>DOL7.5/240</b>	Ex d IIB T6 Gb, Ex tb IIIC T85 °C Db	-40 ... 55 °C (-40 ... 131 °F)	2.1	4.3	5.1
<b>DOL7.5/415</b>	Ex d IIB T6 Gb, Ex tb IIIC T85 °C Db	-40 ... 55 °C (-40 ... 131 °F)	2.1	4.3	5.1
<b>DOL11/240/AL</b>	Ex d IIB T5 Gb, Ex tb IIIC T95 °C ( ta ... +55 °C )	-20 ... 55 °C (-4 ... 131 °F)	2.2	4.4	5.1
<b>DOL11/240/CI</b>	Ex d IIB T5 Gb, Ex tb IIIC T95 °C ( ta ... +55 °C )	-20 ... 55 °C (-4 ... 131 °F)	2.2	4.4	5.1
<b>DOL11/240/SS</b>	Ex d IIB T5 Gb, Ex tb IIIC T95 °C ( ta ... +55 °C )	-20 ... 55 °C (-4 ... 131 °F)	2.2	4.4	5.1
<b>DOL11/415/AL</b>	Ex d IIB T5 Gb, Ex tb IIIC T95 °C ( ta ... +55 °C )	-20 ... 55 °C (-4 ... 131 °F)	2.2	4.4	5.1
<b>DOL11/415/CI</b>	Ex d IIB T5 Gb, Ex tb IIIC T95 °C ( ta ... +55 °C )	-20 ... 55 °C (-4 ... 131 °F)	2.2	4.4	5.1
<b>DOL11/415/SS</b>	Ex d IIB T5 Gb, Ex tb IIIC T95 °C ( ta ... +55 °C )	-20 ... 55 °C (-4 ... 131 °F)	2.2	4.4	5.1
<b>DOL15/240/AL</b>	Ex d IIB T5 Gb, Ex tb IIIC T82 °C Db ( ta ... +55 °C )	-20 ... 55 °C (-4 ... 131 °F)	2.2	4.4	5.1
<b>DOL15/240/CI</b>	Ex d IIB T5 Gb, Ex tb IIIC T82 °C Db ( ta ... +55 °C )	-20 ... 55 °C (-4 ... 131 °F)	2.2	4.4	5.1
<b>DOL15/240/SS</b>	Ex d IIB T5 Gb, Ex tb IIIC T82 °C Db ( ta ... +55 °C )	-20 ... 55 °C (-4 ... 131 °F)	2.2	4.4	5.1
<b>DOL15/415/AL</b>	Ex d IIB T5 Gb, Ex tb IIIC T82 °C Db ( ta ... +55 °C )	-20 ... 55 °C (-4 ... 131 °F)	2.2	4.4	5.1
<b>DOL15/415/CI</b>	Ex d IIB T5 Gb, Ex tb IIIC T82 °C Db ( ta ... +55 °C )	-20 ... 55 °C (-4 ... 131 °F)	2.2	4.4	5.1
<b>DOL15/415/SS</b>	Ex d IIB T5 Gb, Ex tb IIIC T82 °C Db ( ta ... +55 °C )	-20 ... 55 °C (-4 ... 131 °F)	2.2	4.4	5.1

Table continues overleaf

Release date 2013-09-20 T164876

This datasheet does not constitute any contract obligation.

Pepperl+Fuchs reserves the right to modify the products herein illustrated without prior notice. Copyright Pepperl+Fuchs srl - Italy: +39 039 6292 1

Pepperl+Fuchs Group USA: +1 330 486 0002  
www.pepperl-fuchs.com pa-info@us.pepperl-fuchs.com

Germany: +49 621 776 2222  
pa-info@de.pepperl-fuchs.com

Singapore: +65 6779 9091  
pa-info@sg.pepperl-fuchs.com

**PF** PEPPERL+FUCHS  
PROTECTING YOUR PROCESS

**DOL/DOLSD - Certification cross-reference continued**

for certification characteristics please see table above

Type	Type of protection	Ambient temperature	Certificate	IECEX	GOST-R
			see (2)	(4)	(5)
DOL18.5/240/AL	Ex d IIB T5 Gb, Ex tb IIIC T82 °C Db (ta ... +55 °C)	-40 ... 55 °C (-40 ... 131 °F)	2.3	4.1	5.1
DOL18.5/240/CI	Ex d IIB T5 Gb, Ex tb IIIC T82 °C Db (ta ... +55 °C)	-40 ... 55 °C (-40 ... 131 °F)	2.3	4.1	5.1
DOL18.5/240/SS	Ex d IIB T5 Gb, Ex tb IIIC T82 °C Db (ta ... +55 °C)	-40 ... 55 °C (-40 ... 131 °F)	2.3	4.1	5.1
DOL18.5/415/AL	Ex d IIB T5 Gb, Ex tb IIIC T82 °C Db (ta ... +55 °C)	-40 ... 55 °C (-40 ... 131 °F)	2.3	4.1	5.1
DOL18.5/415/CI	Ex d IIB T5 Gb, Ex tb IIIC T82 °C Db (ta ... +55 °C)	-40 ... 55 °C (-40 ... 131 °F)	2.3	4.1	5.1
DOL18.5/415/SS	Ex d IIB T5 Gb, Ex tb IIIC T82 °C Db (ta ... +55 °C)	-40 ... 55 °C (-40 ... 131 °F)	2.3	4.1	5.1
DOL22/240/AL	Ex d IIB T5 Gb, Ex tb IIIC T82 °C Db (ta ... +55 °C)	-40 ... 55 °C (-40 ... 131 °F)	2.3	4.1	5.1
DOL22/240/CI	Ex d IIB T5 Gb, Ex tb IIIC T82 °C Db (ta ... +55 °C)	-40 ... 55 °C (-40 ... 131 °F)	2.3	4.1	5.1
DOL22/240/SS	Ex d IIB T5 Gb, Ex tb IIIC T82 °C Db (ta ... +55 °C)	-40 ... 55 °C (-40 ... 131 °F)	2.3	4.1	5.1
DOL22/415/AL	Ex d IIB T5 Gb, Ex tb IIIC T82 °C Db (ta ... +55 °C)	-40 ... 55 °C (-40 ... 131 °F)	2.3	4.1	5.1
DOL22/415/CI	Ex d IIB T5 Gb, Ex tb IIIC T82 °C Db (ta ... +55 °C)	-40 ... 55 °C (-40 ... 131 °F)	2.3	4.1	5.1
DOL22/415/SS	Ex d IIB T5 Gb, Ex tb IIIC T82 °C Db (ta ... +55 °C)	-40 ... 55 °C (-40 ... 131 °F)	2.3	4.1	5.1
DOLSD22/240/AL	Ex d IIB T5 Gb, Ex tb IIIC T82 °C Db (ta ... +55 °C)	-40 ... 55 °C (-40 ... 131 °F)	2.3	4.1	5.1
DOLSD22/240/CI	Ex d IIB T5 Gb, Ex tb IIIC T82 °C Db (ta ... +55 °C)	-40 ... 55 °C (-40 ... 131 °F)	2.3	4.1	5.1
DOLSD22/240/SS	Ex d IIB T5 Gb, Ex tb IIIC T82 °C Db (ta ... +55 °C)	-40 ... 55 °C (-40 ... 131 °F)	2.3	4.1	5.1
DOLSD22/415/AL	Ex d IIB T5 Gb, Ex tb IIIC T82 °C Db (ta ... +55 °C)	-40 ... 55 °C (-40 ... 131 °F)	2.3	4.1	5.1
DOLSD22/415/CI	Ex d IIB T5 Gb, Ex tb IIIC T82 °C Db (ta ... +55 °C)	-40 ... 55 °C (-40 ... 131 °F)	2.3	4.1	5.1
DOLSD22/415/SS	Ex d IIB T5 Gb, Ex tb IIIC T82 °C Db (ta ... +55 °C)	-40 ... 55 °C (-40 ... 131 °F)	2.3	4.1	5.1
DOL30/240/AL	Ex d IIB T5 Gb, Ex tb IIIC T82 °C Db (ta ... +55 °C)	-40 ... 55 °C (-40 ... 131 °F)	2.3	4.1	5.1
DOL30/240/CI	Ex d IIB T5 Gb, Ex tb IIIC T82 °C Db (ta ... +55 °C)	-40 ... 55 °C (-40 ... 131 °F)	2.3	4.1	5.1
DOL30/240/SS	Ex d IIB T5 Gb, Ex tb IIIC T82 °C Db (ta ... +55 °C)	-40 ... 55 °C (-40 ... 131 °F)	2.3	4.1	5.1
DOL30/415/AL	Ex d IIB T5 Gb, Ex tb IIIC T82 °C Db (ta ... +55 °C)	-40 ... 55 °C (-40 ... 131 °F)	2.3	4.1	5.1
DOL30/415/CI	Ex d IIB T5 Gb, Ex tb IIIC T82 °C Db (ta ... +55 °C)	-40 ... 55 °C (-40 ... 131 °F)	2.3	4.1	5.1
DOL30/415/SS	Ex d IIB T5 Gb, Ex tb IIIC T82 °C Db (ta ... +55 °C)	-40 ... 55 °C (-40 ... 131 °F)	2.3	4.1	5.1
DOLSD30/240/AL	Ex d IIB T5 Gb, Ex tb IIIC T82 °C Db (ta ... +55 °C)	-40 ... 55 °C (-40 ... 131 °F)	2.3	4.3	5.1
DOLSD30/240/CI	Ex d IIB T5 Gb, Ex tb IIIC T82 °C Db (ta ... +55 °C)	-40 ... 55 °C (-40 ... 131 °F)	2.3	4.3	5.1
DOLSD30/240/SS	Ex d IIB T5 Gb, Ex tb IIIC T82 °C Db (ta ... +55 °C)	-40 ... 55 °C (-40 ... 131 °F)	2.3	4.3	5.1
DOLSD30/415/AL	Ex d IIB T5 Gb, Ex tb IIIC T82 °C Db (ta ... +55 °C)	-40 ... 55 °C (-40 ... 131 °F)	2.3	4.3	5.1
DOLSD30/415/CI	Ex d IIB T5 Gb, Ex tb IIIC T82 °C Db (ta ... +55 °C)	-40 ... 55 °C (-40 ... 131 °F)	2.3	4.3	5.1
DOLSD30/415/SS	Ex d IIB T5 Gb, Ex tb IIIC T82 °C Db (ta ... +55 °C)	-40 ... 55 °C (-40 ... 131 °F)	2.3	4.3	5.1
DOL55/240/AL	Ex d IIB T5 Gb, Ex tb IIIC T87 °C Db	-40 ... 55 °C (-40 ... 131 °F)	2.4	4.2	5.1
DOL55/240/CI	Ex d IIB T5 Gb, Ex tb IIIC T87 °C Db	-40 ... 55 °C (-40 ... 131 °F)	2.4	4.2	5.1
DOL55/240/SS	Ex d IIB T5 Gb, Ex tb IIIC T87 °C Db	-40 ... 55 °C (-40 ... 131 °F)	2.4	4.2	5.1
DOL55/415/AL	Ex d IIB T5 Gb, Ex tb IIIC T87 °C Db	-40 ... 55 °C (-40 ... 131 °F)	2.4	4.2	5.1
DOL55/415/CI	Ex d IIB T5 Gb, Ex tb IIIC T87 °C Db	-40 ... 55 °C (-40 ... 131 °F)	2.4	4.2	5.1
DOL55/415/SS	Ex d IIB T5 Gb, Ex tb IIIC T87 °C Db	-40 ... 55 °C (-40 ... 131 °F)	2.4	4.2	5.1
DOLSD55/240/AL	Ex d IIB T5 Gb, Ex tb IIIC T87 °C Db	-40 ... 55 °C (-40 ... 131 °F)	2.4	4.2	5.1
DOLSD55/240/CI	Ex d IIB T5 Gb, Ex tb IIIC T87 °C Db	-40 ... 55 °C (-40 ... 131 °F)	2.4	4.2	5.1
DOLSD55/240/SS	Ex d IIB T5 Gb, Ex tb IIIC T87 °C Db	-40 ... 55 °C (-40 ... 131 °F)	2.4	4.2	5.1
DOLSD55/415/AL	Ex d IIB T5 Gb, Ex tb IIIC T87 °C Db	-40 ... 55 °C (-40 ... 131 °F)	2.4	4.2	5.1
DOLSD55/415/CI	Ex d IIB T5 Gb, Ex tb IIIC T87 °C Db	-40 ... 55 °C (-40 ... 131 °F)	2.4	4.2	5.1
DOLSD55/415/SS	Ex d IIB T5 Gb, Ex tb IIIC T87 °C Db	-40 ... 55 °C (-40 ... 131 °F)	2.4	4.2	5.1
DOL75/240/AL	Ex d IIB T5 Gb, Ex tb IIIC T87 °C Db	-40 ... 55 °C (-40 ... 131 °F)	2.4	4.2	5.1
DOL75/240/CI	Ex d IIB T5 Gb, Ex tb IIIC T87 °C Db	-40 ... 55 °C (-40 ... 131 °F)	2.4	4.2	5.1
DOL75/240/SS	Ex d IIB T5 Gb, Ex tb IIIC T87 °C Db	-40 ... 55 °C (-40 ... 131 °F)	2.4	4.2	5.1
DOL75/415/AL	Ex d IIB T5 Gb, Ex tb IIIC T87 °C Db	-40 ... 55 °C (-40 ... 131 °F)	2.4	4.2	5.1
DOL75/415/CI	Ex d IIB T5 Gb, Ex tb IIIC T87 °C Db	-40 ... 55 °C (-40 ... 131 °F)	2.4	4.2	5.1
DOL75/415/SS	Ex d IIB T5 Gb, Ex tb IIIC T87 °C Db	-40 ... 55 °C (-40 ... 131 °F)	2.4	4.2	5.1
DOLSD75/240/AL	Ex d IIB T5 Gb, Ex tb IIIC T87 °C Db	-40 ... 55 °C (-40 ... 131 °F)	2.4	4.2	5.1
DOLSD75/240/CI	Ex d IIB T5 Gb, Ex tb IIIC T87 °C Db	-40 ... 55 °C (-40 ... 131 °F)	2.4	4.2	5.1
DOLSD75/240/SS	Ex d IIB T5 Gb, Ex tb IIIC T87 °C Db	-40 ... 55 °C (-40 ... 131 °F)	2.4	4.2	5.1
DOLSD75/415/AL	Ex d IIB T5 Gb, Ex tb IIIC T87 °C Db	-40 ... 55 °C (-40 ... 131 °F)	2.4	4.2	5.1
DOLSD75/415/CI	Ex d IIB T5 Gb, Ex tb IIIC T87 °C Db	-40 ... 55 °C (-40 ... 131 °F)	2.4	4.2	5.1
DOLSD75/415/SS	Ex d IIB T5 Gb, Ex tb IIIC T87 °C Db	-40 ... 55 °C (-40 ... 131 °F)	2.4	4.2	5.1

Release date: 2013-05-20 T164876

This datasheet does not constitute any contract obligation.

Pepperl+Fuchs reserves the right to modify the products herein illustrated without prior notice. Copyright Pepperl+Fuchs srl - Italy: +39 039 6292 1

Pepperl+Fuchs Group  
www.pepperl-fuchs.comUSA: +1 330 486 0002  
pa-info@us.pepperl-fuchs.comGermany: +49 621 776 2222  
pa-info@de.pepperl-fuchs.comSingapore: +65 6779 9091  
pa-info@sg.pepperl-fuchs.com

**PEPPERL+FUCHS**  
 PROTECTING YOUR PROCESS

## DOL/DOLSD - Dimensions Data Table

Type	Power [kW]	Dimensions [mm]			Fixation [mm]			Enclosure material	Weight approx. [kg]	Drawing reference see *1*
		A	B	C	D	E	Diam. J			
DOL1.1/240	1.1	218	150	104	240	78	7.25	cast iron	11	A
DOL1.5/240	1.5	218	150	104	240	78	7.25	cast iron	11	A
DOL2.2/240	2.2	218	150	104	240	78	7.25	cast iron	11	A
DOL3/240	3	218	150	104	240	78	7.25	cast iron	11	A
DOL4/240	4	218	150	104	240	78	7.25	cast iron	11	A
DOL4/415	4	218	150	104	240	78	7.25	cast iron	11	A
DOL5.5/240	5.5	218	150	104	240	78	7.25	cast iron	11	A
DOL5.5/415	5.5	218	150	104	240	78	7.25	cast iron	11	A
DOL7.5/240	7.5	218	150	104	240	78	7.25	cast iron	11	A
DOL7.5/415	7.5	218	150	104	240	78	7.25	cast iron	11	A
DOL11/240/AL	11	210	185	156	240	120	9.1	cast aluminium	8	B
DOL11/240/CI	11	210	185	156	240	120	9.1	cast iron	20	B
DOL11/240/SS	11	210	185	156	240	120	9.1	cast stainless steel	21	B
DOL11/415/AL	11	210	185	156	240	120	9.1	cast aluminium	8	B
DOL11/415/CI	11	210	185	156	240	120	9.1	cast iron	20	B
DOL11/415/SS	11	210	185	156	240	120	9.1	cast stainless steel	21	B
DOL15/240/AL	15	210	185	156	240	120	9.1	cast aluminium	8	B
DOL15/240/CI	15	210	185	156	240	120	9.1	cast iron	20	B
DOL15/240/SS	15	210	185	156	240	120	9.1	cast stainless steel	21	B
DOL15/415/AL	15	210	185	156	240	120	9.1	cast aluminium	8	B
DOL15/415/CI	15	210	185	156	240	120	9.1	cast iron	20	B
DOL15/415/SS	15	210	185	156	240	120	9.1	cast stainless steel	21	B
DOL18.5/240/AL	18.5	335	310	205	360	240	10.2	cast aluminium	19	C
DOL18.5/240/CI	18.5	335	310	205	360	240	10.2	cast iron	50	C
DOL18.5/240/SS	18.5	335	310	205	360	240	10.2	cast stainless steel	52	C
DOL18.5/415/AL	18.5	335	310	205	360	240	10.2	cast aluminium	19	C
DOL18.5/415/CI	18.5	335	310	205	360	240	10.2	cast iron	50	C
DOL18.5/415/SS	18.5	335	310	205	360	240	10.2	cast stainless steel	52	C
DOL22/240/AL	22	335	310	205	360	240	10.2	cast aluminium	19	C
DOL22/240/CI	22	335	310	205	360	240	10.2	cast iron	50	C
DOL22/240/SS	22	335	310	205	360	240	10.2	cast stainless steel	52	C
DOL22/415/AL	22	335	310	205	360	240	10.2	cast aluminium	19	C
DOL22/415/CI	22	335	310	205	360	240	10.2	cast iron	50	C
DOL22/415/SS	22	335	310	205	360	240	10.2	cast stainless steel	52	C
DOLSD22/240/AL	22	335	310	205	360	240	10.2	cast aluminium	19	C
DOLSD22/240/CI	22	335	310	205	360	240	10.2	cast iron	50	C
DOLSD22/240/SS	22	335	310	205	360	240	10.2	cast stainless steel	52	C
DOLSD22/415/AL	22	335	310	205	360	240	10.2	cast aluminium	19	C
DOLSD22/415/CI	22	335	310	205	360	240	10.2	cast iron	50	C
DOLSD22/415/SS	22	335	310	205	360	240	10.2	cast stainless steel	52	C

Table continues overleaf, \*1\* reference drawings see at first page DOL / DOLSD

## DOL/DOLSD - Dimensions Data Table continued

Type	Power [kW]	Dimensions [mm]			Fixation [mm]			Enclosure material	Weight approx. [kg]	Drawing reference see *1*
		A	B	C	D	E	Diam. J			
DOL30/240/AL	30	335	310	205	360	240	10.2	cast aluminium	19	C
DOL30/240/CI	30	335	310	205	360	240	10.2	cast iron	50	C
DOL30/240/SS	30	335	310	205	360	240	10.2	cast stainless steel	52	C
DOL30/415/AL	30	335	310	205	360	240	10.2	cast aluminium	19	C
DOL30/415/CI	30	335	310	205	360	240	10.2	cast iron	50	C
DOL30/415/SS	30	335	310	205	360	240	10.2	cast stainless steel	52	C
DOLSD30/240/AL	30	335	310	205	360	240	10.2	cast aluminium	19	C
DOLSD30/240/CI	30	335	310	205	360	240	10.2	cast iron	50	C
DOLSD30/240/SS	30	335	310	205	360	240	10.2	cast stainless steel	52	C
DOLSD30/415/AL	30	335	310	205	360	240	10.2	cast aluminium	19	C
DOLSD30/415/CI	30	335	310	205	360	240	10.2	cast iron	50	C
DOLSD30/415/SS	30	335	310	205	360	240	10.2	cast stainless steel	52	C
DOL55/240/AL	55	560	560	266	650	400	10.2	cast aluminium	72	D
DOL55/240/CI	55	560	560	266	650	400	10.2	cast iron	172	D
DOL55/240/SS	55	560	560	266	650	400	10.2	cast stainless steel	184	D
DOL55/415/AL	55	560	560	266	650	400	10.2	cast aluminium	72	D
DOL55/415/CI	55	560	560	266	650	400	10.2	cast iron	172	D
DOL55/415/SS	55	560	560	266	650	400	10.2	cast stainless steel	184	D
DOLSD55/240/AL	55	560	560	266	650	400	10.2	cast aluminium	72	D
DOLSD55/240/CI	55	560	560	266	650	400	10.2	cast iron	172	D
DOLSD55/240/SS	55	560	560	266	650	400	10.2	cast stainless steel	184	D
DOLSD55/415/AL	55	560	560	266	650	400	10.2	cast aluminium	72	D
DOLSD55/415/CI	55	560	560	266	650	400	10.2	cast iron	172	D
DOLSD55/415/SS	55	560	560	266	650	400	10.2	cast stainless steel	184	D
DOL75/240/AL	75	560	560	266	650	400	10.2	cast aluminium	72	D
DOL75/240/CI	75	560	560	266	650	400	10.2	cast iron	172	D
DOL75/240/SS	75	560	560	266	650	400	10.2	cast stainless steel	184	D
DOL75/415/AL	75	560	560	266	650	400	10.2	cast aluminium	72	D
DOL75/415/CI	75	560	560	266	650	400	10.2	cast iron	172	D
DOL75/415/SS	75	560	560	266	650	400	10.2	cast stainless steel	184	D
DOLSD75/240/AL	75	560	560	266	650	400	10.2	cast aluminium	72	D
DOLSD75/240/CI	75	560	560	266	650	400	10.2	cast iron	172	D
DOLSD75/240/SS	75	560	560	266	650	400	10.2	cast stainless steel	184	D
DOLSD75/415/AL	75	560	560	266	650	400	10.2	cast aluminium	72	D
DOLSD75/415/CI	75	560	560	266	650	400	10.2	cast iron	172	D
DOLSD75/415/SS	75	560	560	266	650	400	10.2	cast stainless steel	184	D

\*1\* Reference drawings see at first page of DOL / DOLSD

## DOL/DOLSD - Mechanical Specification

Type	Power [kW]	Cable entries		Cover fixing screws Stainless steel	Ingress protection EN60529	Seal see *1*	Enclosure material
		Face [A]	Face [B]				
DOL1.1/240	1.1	1 x M20	2 x M20	M6	IP65	1	cast iron
DOL1.5/240	1.5	1 x M20	2 x M20	M6	IP65	1	cast iron
DOL2.2/240	2.2	1 x M20	2 x M20	M6	IP65	1	cast iron
DOL3/240	3	1 x M20	2 x M20	M6	IP65	1	cast iron
DOL4/240	4	1 x M20	2 x M20	M6	IP65	1	cast iron
DOL4/415	4	1 x M20	2 x M20	M6	IP65	1	cast iron
DOL5.5/240	5.5	1 x M20	2 x M20	M6	IP65	1	cast iron
DOL5.5/415	5.5	1 x M20	2 x M20	M6	IP65	1	cast iron
DOL7.5/240	7.5	1 x M20	2 x M20	M6	IP65	1	cast iron
DOL7.5/415	7.5	1 x M20	2 x M20	M6	IP65	1	cast iron
DOL11/240/AL	11	1 x M20	2 x M20	M8	IP66	2	cast aluminium
DOL11/240/CI	11	1 x M20	2 x M20	M8	IP66	2	cast iron
DOL11/240/SS	11	1 x M20	2 x M20	M8	IP66	2	cast stainless steel
DOL11/415/AL	11	1 x M20	2 x M20	M8	IP66	2	cast aluminium
DOL11/415/CI	11	1 x M20	2 x M20	M8	IP66	2	cast iron
DOL11/415/SS	11	1 x M20	2 x M20	M8	IP66	2	cast stainless steel
DOL15/240/AL	15	1 x M20	2 x M20	M8	IP66	2	cast aluminium
DOL15/240/CI	15	1 x M20	2 x M20	M8	IP66	2	cast iron
DOL15/240/SS	15	1 x M20	2 x M20	M8	IP66	2	cast stainless steel
DOL15/415/AL	15	1 x M20	2 x M20	M8	IP66	2	cast aluminium
DOL15/415/CI	15	1 x M20	2 x M20	M8	IP66	2	cast iron
DOL15/415/SS	15	1 x M20	2 x M20	M8	IP66	2	cast stainless steel
DOL18.5/240/AL	18.5	1 x M25	2 x M25	M8	IP66	2	cast aluminium
DOL18.5/240/CI	18.5	1 x M25	2 x M25	M8	IP66	2	cast iron
DOL18.5/240/SS	18.5	1 x M25	2 x M25	M6	IP66	1	cast stainless steel
DOL18.5/415/AL	18.5	1 x M25	2 x M25	M8	IP66	2	cast aluminium
DOL18.5/415/CI	18.5	1 x M25	2 x M25	M8	IP66	2	cast iron
DOL18.5/415/SS	18.5	1 x M25	2 x M25	M6	IP66	1	cast stainless steel
DOL22/240/AL	22	1 x M25	2 x M25	M8	IP66	2	cast aluminium
DOL22/240/CI	22	1 x M25	2 x M25	M8	IP66	2	cast iron
DOL22/240/SS	22	1 x M25	2 x M25	M6	IP66	1	cast stainless steel
DOL22/415/AL	22	1 x M25	2 x M25	M8	IP66	2	cast aluminium
DOL22/415/CI	22	1 x M25	2 x M25	M8	IP66	2	cast iron
DOL22/415/SS	22	1 x M25	2 x M25	M6	IP66	1	cast stainless steel
DOLSD22/240/SS	22	1 x M25	2 x M25	M8	IP66	1	cast stainless steel
DOLSD22/240/AL	22	1 x M25	2 x M25	M8	IP66	1	cast aluminium
DOLSD22/240/CI	22	1 x M25	2 x M25	M8	IP66	1	cast iron
DOLSD22/415/AL	22	1 x M25	2 x M25	M8	IP66	1	cast aluminium
DOLSD22/415/CI	22	1 x M25	2 x M25	M8	IP66	1	cast iron
DOLSD22/415/SS	22	1 x M25	2 x M25	M8	IP66	1	cast stainless steel

Table continues overleaf



## DOL/DOLSD - Mechanical Specification continued

Type	Power [kW]	Cable entries		Cover fixing screws Stainless steel	Ingress protection EN60529	Seal see *1*	Enclosure material
		Face [A]	Face [B]				
DOL30/240/AL	30	1 x M25	2 x M25	M8	IP66	2	cast aluminium
DOL30/240/CI	30	1 x M25	2 x M25	M8	IP66	2	cast iron
DOL30/240/SS	30	1 x M25	2 x M25	M6	IP66	1	cast stainless steel
DOL30/415/AL	30	1 x M25	2 x M25	M8	IP66	2	cast aluminium
DOL30/415/CI	30	1 x M25	2 x M25	M8	IP66	2	cast iron
DOL30/415/SS	30	1 x M25	2 x M25	M6	IP66	1	cast stainless steel
DOLSD30/240/AL	30	1 x M25	2 x M25	M8	IP66	1	cast aluminium
DOLSD30/240/CI	30	1 x M25	2 x M25	M8	IP66	1	cast iron
DOLSD30/240/SS	30	1 x M25	2 x M25	M8	IP66	1	cast stainless steel
DOLSD30/415/AL	30	1 x M25	2 x M25	M8	IP66	1	cast aluminium
DOLSD30/415/CI	30	1 x M25	2 x M25	M8	IP66	1	cast iron
DOLSD30/415/SS	30	1 x M25	2 x M25	M8	IP66	1	cast stainless steel
DOL55/240/AL	55	1 x M32	2 x M32	M10	IP66	1	cast aluminium
DOL55/240/CI	55	1 x M32	2 x M32	M10	IP66	1	cast iron
DOL55/240/SS	55	1 x M32	2 x M32	M10	IP66	1	cast stainless steel
DOL55/415/AL	55	1 x M32	2 x M32	M10	IP66	1	cast aluminium
DOL55/415/CI	55	1 x M32	2 x M32	M10	IP66	1	cast iron
DOL55/415/SS	55	1 x M32	2 x M32	M10	IP66	1	cast stainless steel
DOLSD55/240/AL	55	1 x M32	2 x M32	M10	IP66	1	cast aluminium
DOLSD55/240/CI	55	1 x M32	2 x M32	M10	IP66	1	cast iron
DOLSD55/240/SS	55	1 x M32	2 x M32	M10	IP66	1	cast stainless steel
DOLSD55/415/AL	55	1 x M32	2 x M32	M10	IP66	1	cast aluminium
DOLSD55/415/CI	55	1 x M32	2 x M32	M10	IP66	1	cast iron
DOLSD55/415/SS	55	1 x M32	2 x M32	M10	IP66	1	cast iron
DOL75/240/AL	75	1 x M40	2 x M40	M10	IP66	1	cast aluminium
DOL75/240/CI	75	1 x M40	2 x M40	M10	IP66	1	cast iron
DOL75/240/SS	75	1 x M40	2 x M40	M10	IP66	1	cast stainless steel
DOL75/415/AL	75	1 x M40	2 x M40	M10	IP66	1	cast aluminium
DOL75/415/CI	75	1 x M40	2 x M40	M10	IP66	1	cast iron
DOL75/415/SS	75	1 x M40	2 x M40	M10	IP66	1	cast stainless steel
DOLSD75/240/AL	75	1 x M40	2 x M40	M10	IP66	1	cast aluminium
DOLSD75/240/CI	75	1 x M40	2 x M40	M10	IP66	1	cast iron
DOLSD75/240/SS	75	1 x M40	2 x M40	M10	IP66	1	cast stainless steel
DOLSD75/415/AL	75	1 x M40	2 x M40	M10	IP66	1	cast aluminium
DOLSD75/415/CI	75	1 x M40	2 x M40	M10	IP66	1	cast iron
DOLSD75/415/SS	75	1 x M40	2 x M40	M10	IP66	1	cast stainless steel

\*1\* Seal:

1 - Seal by grease

2 - One piece closed cell neoprene

**Description:**

The SDS range of star delta motor starters are safely protected in flameproof enclosures. They are suitable for Ex e motors and available with various contactor ratings and coil voltages.

**Application:**

The SDS range of motor starters is designed for safe operation of machinery and drives in gas or dust explosion hazardous areas.

**Materials:**

Body: Cast iron, aluminium and stainless steel.  
Screws: Stainless steel.  
For details see data tables overleaf.

**Certification characteristics:**

Marking to 94/9/EC: II 2GD  
Zones: 1 – 21 – 2 – 22

For type of protection, certificates and ambient temperature range please see certification characteristics table overleaf.

**Threads:**

Metric threaded, for details see Mechanical Specification.

**Inhibiting treatments:**

Zinc rich epoxy powder primer plus epoxy powder top coat black.

**Features:**

Enclosure cover: hinged non-detachable  
Mounting: 2 x fabricated stainless steel mounting straps.

**Mechanical Specification:**

For drawing references, dimensions [mm] and approx. weight [kg] see Dimensions Data Table.

Cable entries (dimension F):

Face [A]: 1 x M25  
Face [B]: 1 x M20, 2 x M25  
Cover fixing screws: M8 stainless steel  
Ingress protection to EN60529: IP66  
Seal: One piece closed cell neoprene.

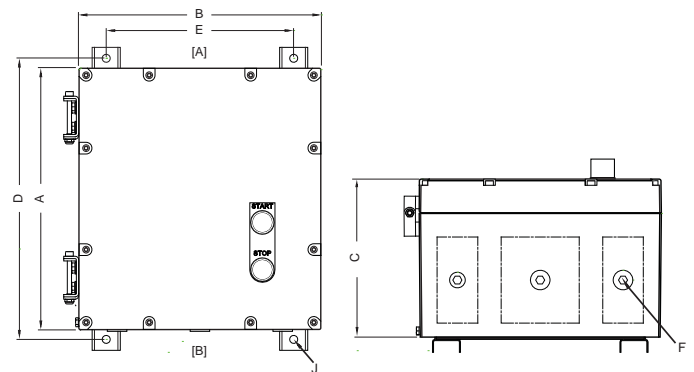
**Drawing SDS****Legend:**

- A - Maximum external dimension.
- B - Maximum external dimension.
- C - Maximum external dimension.
- D - Fixing holes wheel base.
- E - Fixing holes wheel base.
- F - Cable entry diameter.
- J - Fixing holes diameter.
- [A] - Entry face.
- [B] - Entry face.

For details see Dimensions Data Table.

## SDS - Electrical Specification

Type	Power	Current AC3	Coil Voltage	Terminal capacity		Overload relay	Enclosure material
	[kW]	[V]	[V]	[mm <sup>2</sup> ] *1*	[mm <sup>2</sup> ] *2*	[A]	
SDS11/240/AL	11	22	240	6	9.6	15 ... 26	cast aluminium
SDS11/240/CI	11	22	240	6	9.6	15 ... 26	cast iron
SDS11/240/SS	11	22	240	6	9.6	15 ... 26	cast stainless steel
SDS11/415/AL	11	22	415	6	9.6	15 ... 26	cast aluminium
SDS11/415/CI	11	22	415	6	9.6	15 ... 26	cast iron
SDS11/415/SS	11	22	415	6	9.6	15 ... 26	cast stainless steel
SDS15/240/AL	15	29	240	6	9.6	24 ... 40	cast aluminium
SDS15/240/CI	15	29	240	6	9.6	24 ... 40	cast iron
SDS15/240/SS	15	29	240	6	9.6	24 ... 40	cast stainless steel
SDS15/415/AL	15	29	415	6	9.6	24 ... 40	cast aluminium
SDS15/415/CI	15	29	415	6	9.6	24 ... 40	cast iron
SDS15/415/SS	15	29	415	6	9.6	24 ... 40	cast stainless steel
SDS22/240/AL	22	43	240	10	16	30 ... 45	cast aluminium
SDS22/240/CI	22	43	240	10	16	30 ... 45	cast iron
SDS22/240/SS	22	43	240	10	16	30 ... 45	cast stainless steel
SDS22/415/AL	22	43	415	10	16	30 ... 45	cast aluminium
SDS22/415/CI	22	43	415	10	16	30 ... 45	cast iron
SDS22/415/SS	22	43	415	10	16	30 ... 45	cast stainless steel
SDS30/240/AL	30	55	240	25	40	35 ... 57	cast aluminium
SDS30/240/CI	30	55	240	25	40	35 ... 57	cast iron
SDS30/240/SS	30	55	240	25	40	35 ... 57	cast stainless steel
SDS30/415/AL	30	55	415	25	40	35 ... 57	cast aluminium
SDS30/415/CI	30	55	415	25	40	35 ... 57	cast iron
SDS30/415/SS	30	55	415	25	40	35 ... 57	cast stainless steel

Phases: 3

Grounding: internal &amp; external brass grounding terminals on base and lid

\*1\* for flexible cable

\*2\* for solid cable

## SDS - Certification characteristics

## Marking to 94/9/EC

II 2 GD

## Type of protection

1.1 Ex d IIB T6 Gb, Ex tb IIIC T76 °C Db (ta ... +50 °C)

1.2 Ex d IIB T5 Gb, Ex tb IIIC T82 °C Db (ta ... +55 °C)

## Certificate

2.1 SIRA 04 ATEX 1266X

## Ambient temperature

3.1 -40 ... 55 °C (-40 ... 131 °F)

## IECEx approval

4.1 IECEx SIR 08.0056X

## GOST-R approval

5.1 GOST-R B00218

Release date 2013-09-20 T164876

This datasheet does not constitute any contract obligation.

Pepperl+Fuchs reserves the right to modify the products herein illustrated without prior notice. Copyright Pepperl+Fuchs srl - Italy: +39 039 6292 1

Pepperl+Fuchs Group  
www.pepperl-fuchs.comUSA: +1 330 486 0002  
pa-info@us.pepperl-fuchs.comGermany: +49 621 776 2222  
pa-info@de.pepperl-fuchs.comSingapore: +65 6779 9091  
pa-info@sg.pepperl-fuchs.com

**PEPPERL+FUCHS**  
 PROTECTING YOUR PROCESS

**SDS - Dimensions Data Table**

Type	Power [kW]	Dimensions [mm]			Fixation [mm]			Enclosure material	Weight approx. [kg]
		A	B	C	D	E	Diam. J		
SDS11/240/AL	11	335	310	205	360	240	10.2	cast aluminium	19
SDS11/240/CI	11	335	310	205	360	240	10.2	cast iron	50
SDS11/240/SS	11	335	310	205	360	240	10.2	cast stainless steel	52
SDS11/415/AL	11	335	310	205	360	240	10.2	cast aluminium	19
SDS11/415/CI	11	335	310	205	360	240	10.2	cast iron	50
SDS11/415/SS	11	335	310	205	360	240	10.2	cast stainless steel	52
SDS15/240/AL	15	335	310	205	360	240	10.2	cast aluminium	19
SDS15/240/CI	15	335	310	205	360	240	10.2	cast iron	50
SDS15/240/SS	15	335	310	205	360	240	10.2	cast stainless steel	52
SDS15/415/AL	15	335	310	205	360	240	10.2	cast aluminium	19
SDS15/415/CI	15	335	310	205	360	240	10.2	cast iron	50
SDS15/415/SS	15	335	310	205	360	240	10.2	cast stainless steel	52
SDS22/240/AL	22	335	310	205	360	240	10.2	cast aluminium	19
SDS22/240/CI	22	335	310	205	360	240	10.2	cast iron	50
SDS22/240/SS	22	335	310	205	360	240	10.2	cast stainless steel	52
SDS22/415/AL	22	335	310	205	360	240	10.2	cast aluminium	19
SDS22/415/CI	22	335	310	205	360	240	10.2	cast iron	50
SDS22/415/SS	22	335	310	205	360	240	10.2	cast stainless steel	52
SDS30/240/AL	30	335	310	205	360	240	10.2	cast aluminium	19
SDS30/240/CI	30	335	310	205	360	240	10.2	cast iron	50
SDS30/240/SS	30	335	310	205	360	240	10.2	cast stainless steel	52
SDS30/415/AL	30	335	310	205	360	240	10.2	cast aluminium	19
SDS30/415/CI	30	335	310	205	360	240	10.2	cast iron	50
SDS30/415/SS	30	335	310	205	360	240	10.2	cast stainless steel	52

Reference drawing see at first page SDS

Release date 2013-09-20 T164876

This datasheet does not constitute any contract obligation.

Pepperl+Fuchs reserves the right to modify the products herein illustrated without prior notice. Copyright Pepperl+Fuchs srl - Italy: +39 039 6292 1

Pepperl+Fuchs Group  
www.pepperl-fuchs.com

USA: +1 330 486 0002  
pa-info@us.pepperl-fuchs.com

Germany: +49 621 776 2222  
pa-info@de.pepperl-fuchs.com

Singapore: +65 6779 9091  
pa-info@sg.pepperl-fuchs.com

