

Accessories

Mounting accessories

Mounting kit 091



Features

- Suitable for an electrically isolated mounting.
- For low-dynamic applications and constant movements.

Description

Torque support onto encoder by help of the attached screws. Push encoder onto the drive shaft and mount torque support onto the client side. Fastening clamping ring by the screw provided.

Part number

11066208 Mounting kit 091

Scope of delivery

Included:
torque support, two screws M3 x 12 (DIN 7985 - TX10) with two electrically insulated spacers 7 mm and insulating sockets.

Dimensions

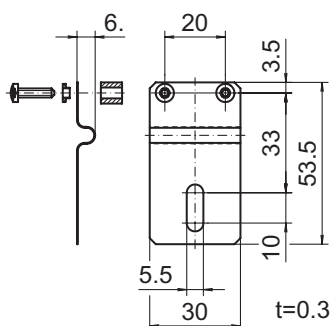

Z00465

Assembly drawing

