

Accessories

Mounting accessories

Mounting kit 092



Features

- For low-dynamic applications and constant movements

Description

Torque support onto encoder by help of the attached screws. Push encoder onto the drive shaft and mount torque support onto the client side. Fastening clamping ring by the screw provided.

Part number

11069239 Torque arm, 1-arm, bolt circle $\varnothing 110 \dots 130$ mm, mounting M5 (mounting kit 092)

Scope of delivery

Included:
torque support, two screws M3 x 6 (DIN 7985 - TX10)

Suitable for

ATD2AH00, ITD21H00, ITD21H00 HT, ITD22H00

Dimensions

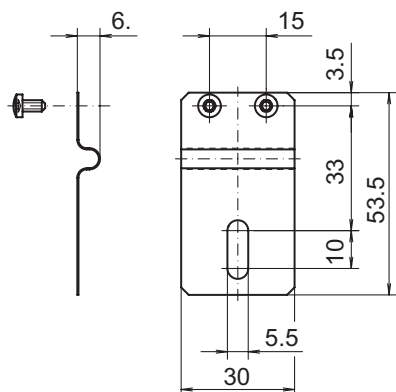

Z00539

Assembly drawing

