



## Features

- Gateway with integrated PROFINET switch to connect VeriSens® via RS485 interface
- Allows PROFINET implementation in addition to visualization or FTP image transfer
- Supports PROFINET line topology due to integrated switch
- Efficient – possible implementation of up to 4 VeriSens®
- PROFINET certified (Version 2.2)
- Requires VeriSens® type VS xxxxxxxxxxxRx (supporting RS485) with software release v2.5.0 or later



## electrical data

voltage supply range + Vs	10 ... 33V DC (must have the same ground potential as the VeriSens®)
power consumption	typ. 120 mA, max 150 mA
transfer rate	230 kBit/s
protective functions	integrated termination resistor
PROFINET	PROFINET I/O, RT-Class 1 (unsynchronized real-time-communication for the I/O-data exchange), Conformance Class B, integrated switch

## mechanical data

fixation	standard mounting channel (deep DIN-rail to EN 50022)
installation position	any
weight	approx. 150 g

## environmental data

operating temperature	-25°C ... +85°C
protection class	IP 20 (for switch cabinet use)
conformity	CE, RoHS

## dimension drawing

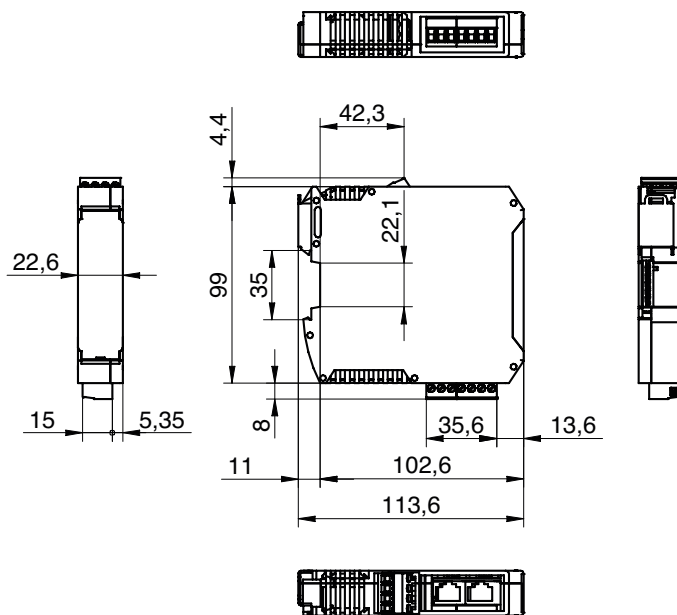

## topology and wiring

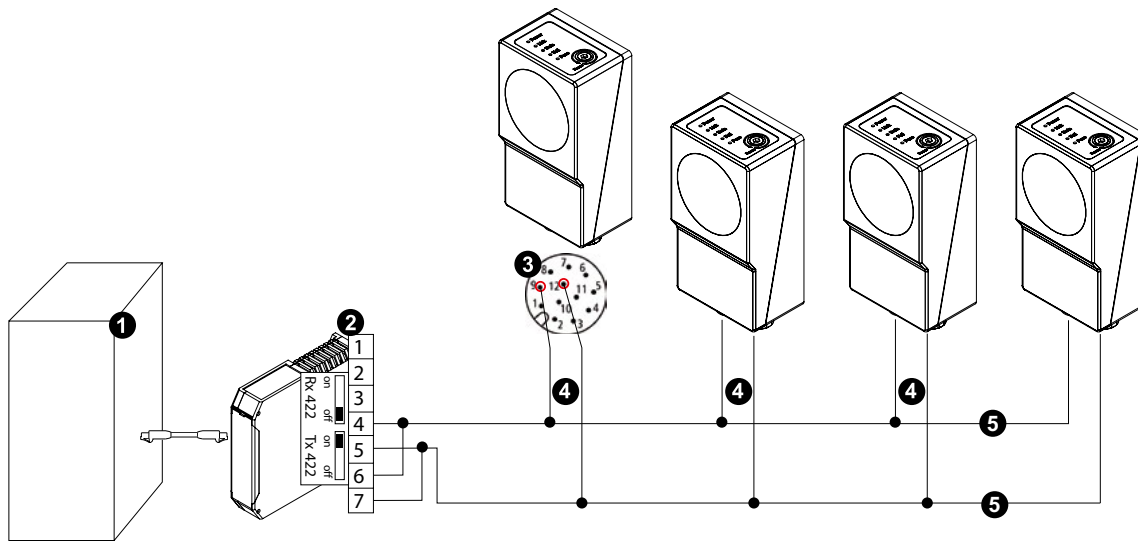
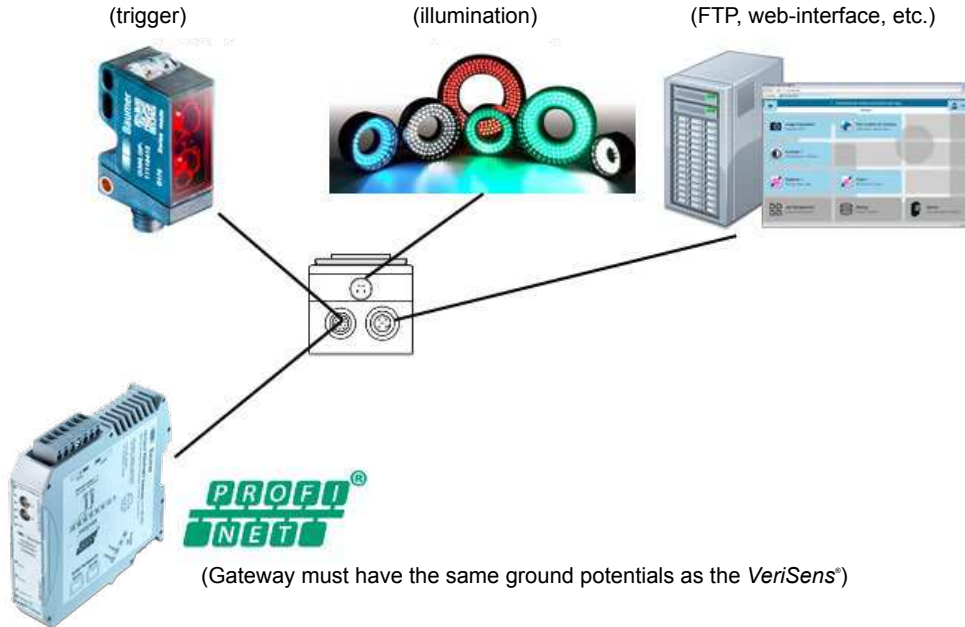

## electrical connection

- 1 PLC
- 2 PROFINET gateway and switch position for activating the resistance for RS485  
Pin 4, 6: RS485+  
Pin 5, 7: RS485-
- 3 Pin assignment on the devices (max. 4)  
  
Pin 9 (red): RS485+  
Pin 12 (red/blue): RS485-
- 4 Branch lines (AWG26 recommended, thicker cross sections possible, twisted)  
  
Max. length of the branch lines for all devices: < 20 m
- 5 Max. cable length at 230400 baud: 200 m (AWG26 recommended, thicker cross sections possible, twisted, shielded)