

# Diffuse sensors with background suppression

## FHDK 10P5110/S35A

### dimension drawing

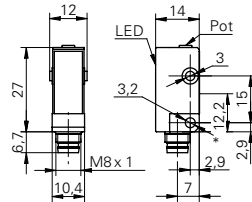

\* emitter axis

### general data

type	background suppression
version	point source LED
light source	pulsed point source LED
sensing distance $T_w$	25 ... 120 mm
sensing range $T_b$ (at $T_w$ max.)	5 ... 120 mm
sensing range $T_b$ (at $T_w$ min.)	5 ... 25 mm
alignment / soiled lens indicator	flashing light indicator
light indicator	LED yellow
sensing distance adjustment	mechanical, 5 turn
distance to focus	35 ... 45 mm
wave length	660 nm
beam diameter	2 mm at focus
suppression of reciprocal influence	yes

### photo



### electrical data

response time / release time	< 1 ms
voltage supply range +Vs	10 ... 30 VDC
current consumption max. (no load)	30 mA
current consumption typ.	20 mA
voltage drop $V_d$	< 1,8 VDC
output function	light / dark operate
output circuit	PNP
output current	< 100 mA
short circuit protection	yes
reverse polarity protection	yes

### connection diagram

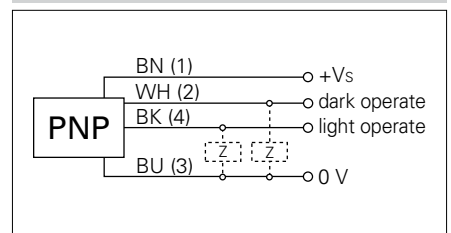

### mechanical data

width / diameter	10,4 mm
height / length	27 mm
depth	14 mm
type	rectangular
housing material	plastic (ASA)
front (optics)	PMMA
connection types	connector M8 4 pin



## Diffuse sensors with background suppression

## FHDK 10P5110/S35A

### ambient conditions

operating temperature	-25 ... +65 °C
protection class	IP 67