

Diffuse sensors with intensity difference

FZDK 10P5101

dimension drawing

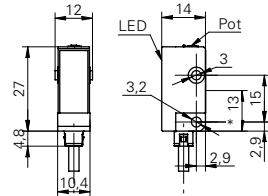

* emitter axis

general data

| | |
|-------------------------------------|--------------------------|
| type | intensity difference |
| light source | pulsed red LED |
| sensing distance Tw | 5 ... 200 mm |
| alignment / soiled lens indicator | flashing light indicator |
| light indicator | LED yellow |
| sensitivity adjustment | potentiometer, 270° |
| wave length | 660 nm |
| suppression of reciprocal influence | yes |

electrical data

| | |
|------------------------------------|----------------------|
| response time / release time | < 1 ms |
| voltage supply range +Vs | 10 ... 30 VDC |
| current consumption max. (no load) | 30 mA |
| current consumption typ. | 20 mA |
| voltage drop Vd | < 1,8 VDC |
| output function | light / dark operate |
| output circuit | PNP |
| output current | < 100 mA |
| short circuit protection | yes |
| reverse polarity protection | yes |

mechanical data

| | |
|------------------|------------------|
| width / diameter | 10,4 mm |
| height / length | 27 mm |
| depth | 14 mm |
| type | rectangular |
| housing material | plastic (ASA) |
| front (optics) | PMMA |
| connection types | cable 4 pin, 2 m |

ambient conditions

| | |
|-----------------------|----------------|
| operating temperature | -25 ... +65 °C |
| protection class | IP 65 |

photo



connection diagram

