

Diffuse sensors with background suppression

OHDK 10P5101

dimension drawing

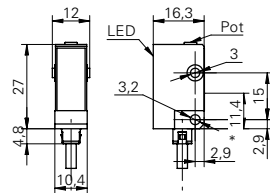

* emitter axis

general data

| | |
|-------------------------------------|-------------------------|
| type | background suppression |
| light source | pulsed red laser diode |
| sensing distance T_w | 22 ... 130 mm |
| sensing range T_b (at T_w max.) | 3 ... 130 mm |
| sensing range T_b (at T_w min.) | 3 ... 22 mm |
| repeat accuracy | < 0,2 mm at laser focus |
| power on indication | LED green |
| light indicator | LED yellow |
| sensing distance adjustment | mechanical, 5 turn |
| laser class | 2 |
| distance to focus | 40 mm |
| wave length | 650 nm |
| suppression of reciprocal influence | yes |

electrical data

| | |
|------------------------------------|----------------------|
| response time / release time | < 0,25 ms |
| voltage supply range +Vs | 11 ... 30 VDC |
| current consumption max. (no load) | 30 mA |
| current consumption typ. | 25 mA |
| voltage drop V_d | < 1,8 VDC |
| output function | light / dark operate |
| output circuit | PNP |
| output current | < 100 mA |
| short circuit protection | yes |
| reverse polarity protection | yes, supply only |

mechanical data

| | |
|------------------|------------------|
| width / diameter | 10,4 mm |
| height / length | 27 mm |
| depth | 16,3 mm |
| type | rectangular |
| housing material | plastic (ASA) |
| front (optics) | PMMA |
| connection types | cable 4 pin, 2 m |

photo



connection diagram

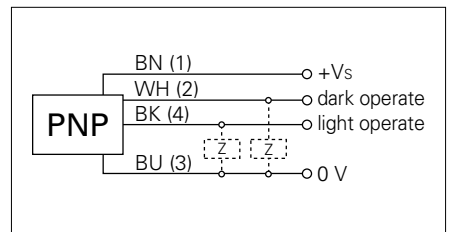

laser warning

LASER RADIATION
DO NOT STARE INTO BEAM
Wavelength: 620...680nm
Max. av. Output: < 1mW
IEC 60825-1, Ed. 2, 2007
CLASS 2 LASER PRODUCT

Complies with 21 CFR 1040.10 and 1040.11 except for deviations pursuant to laser notice No. 50, dated June 24, 2007



Diffuse sensors with background suppression

OHDK 10P5101**ambient conditions**

| | |
|-----------------------|----------------|
| operating temperature | -10 ... +50 °C |
| protection class | IP 65 |