

Diffuse sensors with background suppression

OHDK 10P5150/S35A

dimension drawing

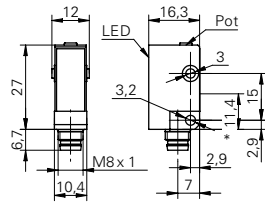

* emitter axis

general data

type	background suppression
version	line beam
light source	pulsed red laser diode
sensing distance T_w	22 ... 130 mm
sensing range T_b (at T_w max.)	3 ... 130 mm
sensing range T_b (at T_w min.)	3 ... 22 mm
repeat accuracy	< 0,2 mm at laser focus
power on indication	LED green
light indicator	LED yellow
sensing distance adjustment	mechanical, 5 turn
laser class	1
distance to focus	40 mm
wave length	650 nm
suppression of reciprocal influence	yes

electrical data

response time / release time	< 0,25 ms
voltage supply range +Vs	11 ... 30 VDC
current consumption max. (no load)	30 mA
current consumption typ.	25 mA
voltage drop V_d	< 1,8 VDC
output function	light / dark operate
output circuit	PNP
output current	< 100 mA
short circuit protection	yes
reverse polarity protection	yes, supply only

mechanical data

width / diameter	10,4 mm
height / length	27 mm
depth	16,3 mm
type	rectangular
housing material	plastic (ASA)
front (optics)	PMMA
connection types	connector M8 4 pin

photo



connection diagram

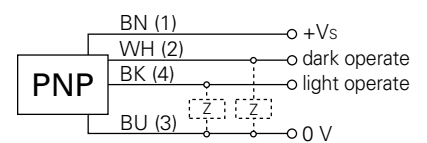

laser warning

CLASS 1 LASER PRODUCT

Complies with 21 CFR 1040.10 and 1040.11 except for deviations pursuant to laser notice No. 50, dated June 24, 2007



Diffuse sensors with background suppression

OHDK 10P5150/S35A

ambient conditions

operating temperature	-10 ... +50 °C
protection class	IP 67