

Technical Information

Flowfit CUA252

Flow assembly for turbidity sensor CUS52D



Application

The CUA252 flow assembly is designed for the installation of turbidity sensor CUS52D. It can be used anywhere medium is conducted in pipelines or, following sampling, held in closed pipes.

Its main areas of application are:

- Turbidity measurement in all process steps
- Final turbidity measurement in the outlet of water works
- Turbidity measurement in the inlet of water works
- Turbidity measurement during filter inspection and filter backwashing
- Turbidity measurement in drinking water distribution networks

Your benefits

- Easy wall or pipe mounting
- Variable mounting
- Vertical installation allows self-venting
- Suitable for use in drinking water owing to PE100 material

Function and system design

Measuring arrangement

A complete measuring system comprises:

- Flow assembly Flowfit CUA252
- Turbimax CUS52D sensor
- Transmitter, e.g. Liquiline CM442
- Measuring cable

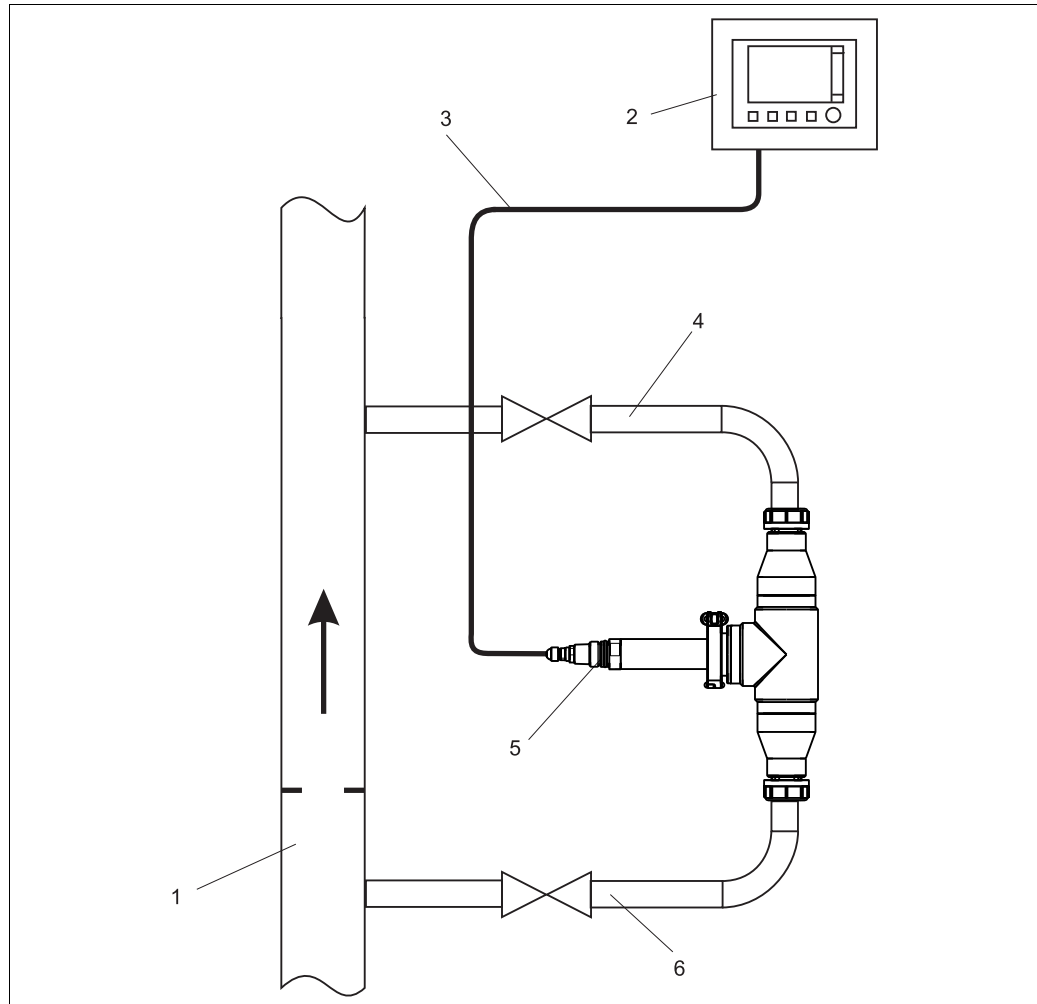

a0022262

Measuring system (example)

- | | |
|---|---|
| 1 | Process pipe |
| 2 | Liquiline CM442 transmitter |
| 3 | Measuring cable |
| 4 | Return line with shutoff valve |
| 5 | Flow assembly CUA252 with sensor CUS52D |
| 6 | Inlet with shutoff valve |

Installation

Installation instructions

To ensure that medium flows through the assembly in a bypass configuration, the pressure p_1 must be greater than the pressure p_2 . This is achieved by installing an orifice plate in the main pipe.

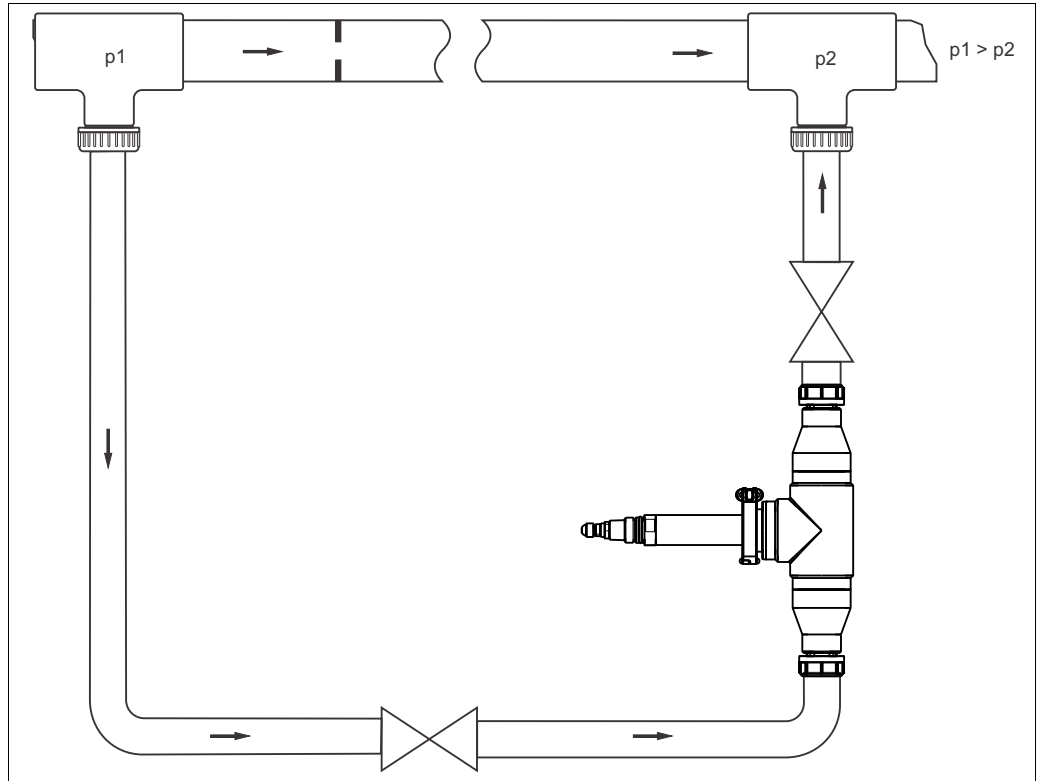

Connection example with a bypass and an orifice plate in the main pipe (supply from below)

a0022258

No measures to increase pressure are required for branch pipes that branch off from the main pipe.

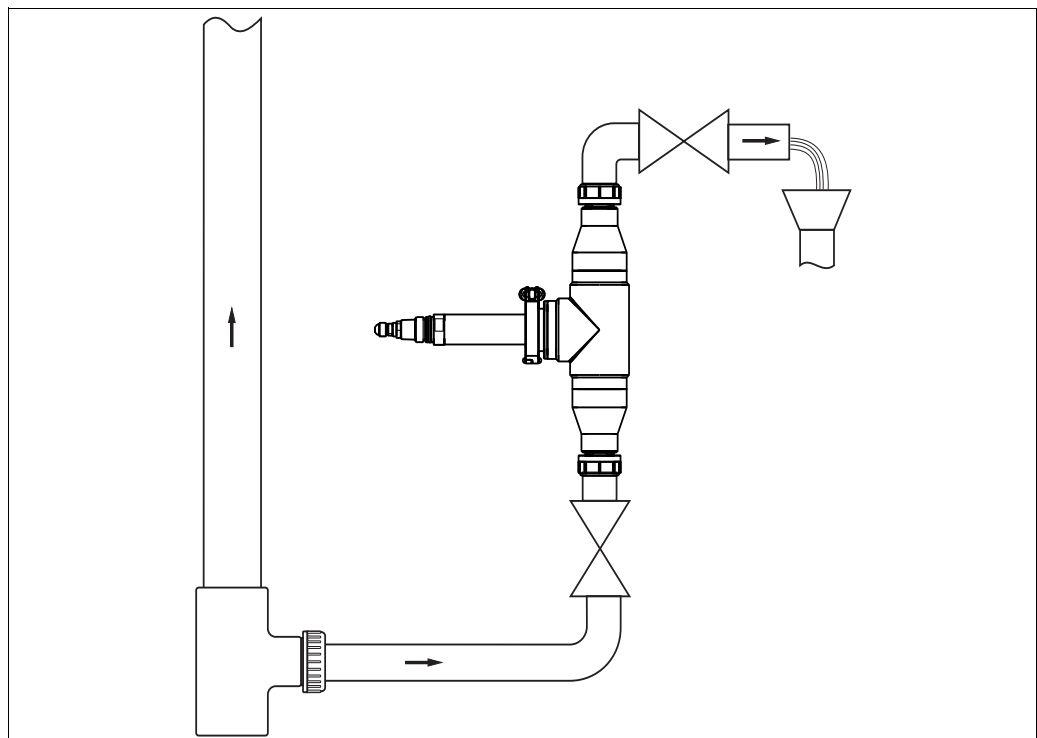

Connection example with an open outlet

The inlet and outlet connection of the flow assembly are always identical, the system is symmetrical. Install the flow assembly vertically. The supply must be connected at the bottom (upward flow in the pipe). Avoid buckles and loops in the hose system.

- i** Pay attention to the installation instructions (flow direction) for the sensor.
- i** Many fluids tend to develop gas bubbles in a depressurized state. Operating the flow assembly under pressure (adjustable valve after the flow assembly) prevents this behavior in many cases.

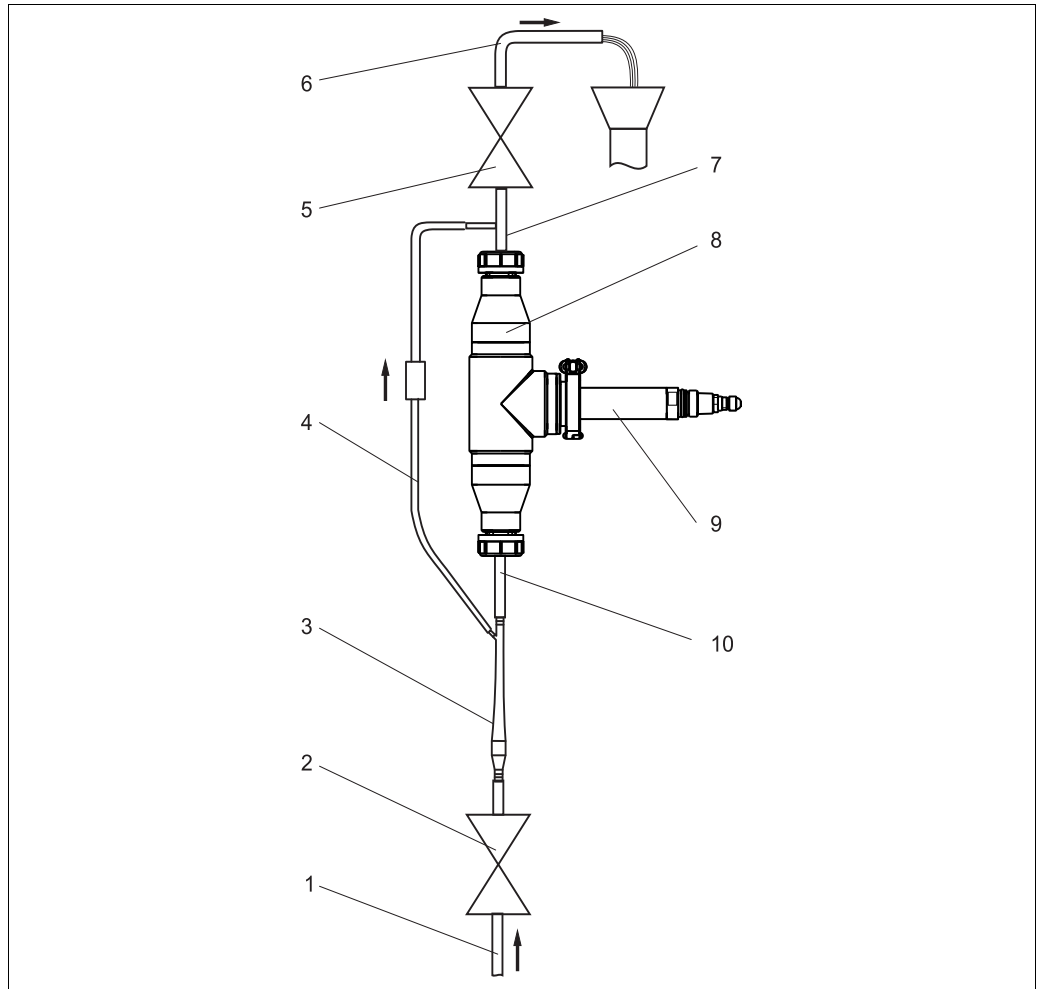

Connection example with bubble trap

- 1 Supply from below
- 2 Shutoff valve
- 3 Bubble trap
- 4 Bubble trap venting (included in the delivery)
- 5 Shutoff valve (throttle to increase pressure)
- 6 Outlet
- 7 Transition to D 12 with connection for vent line (included in the delivery)
- 8 CUA252 flow assembly
- 9 CUS52D turbidity sensor
- 10 Transition to D 12

i The lost water resulting from the bubble trap is not suitable for feedback into the process.

For the hose system, use PVC hoses with an internal diameter of 12 mm (3/8").
Secure the hose system with worm drive hose clips (not included in the delivery).

The inlet and outlet connection of the flow assembly are always identical, the system is symmetrical.
Install the flow assembly vertically.

The supply must be connected at the bottom (upward flow in the pipe).

Avoid buckles and loops in the hose system.

i Pay attention to the installation instructions (flow direction) for the sensor.

i Observe the maximum pressure and maximum temperature when operating the bubble trap.

Wall holder unit

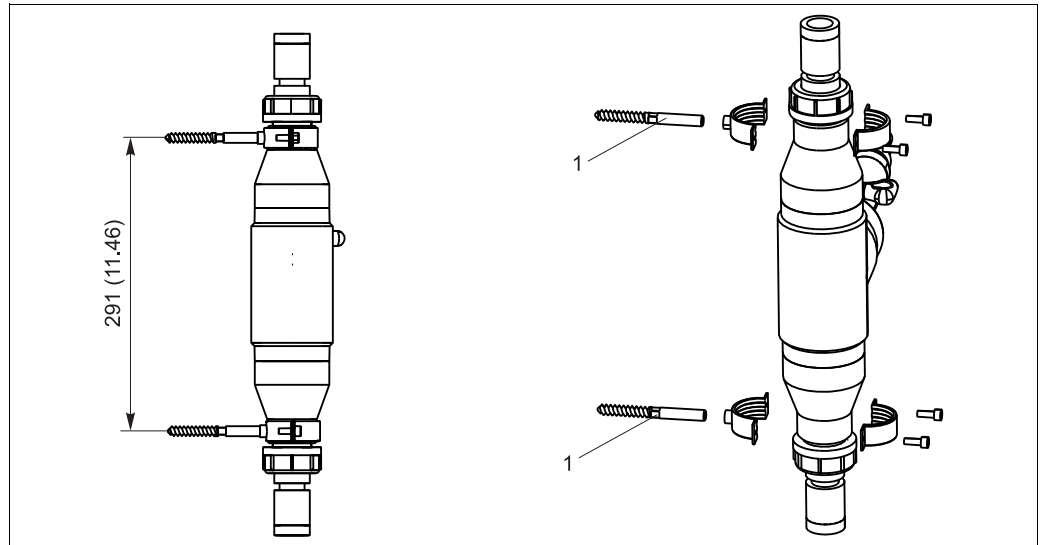

Wall holder unit

- 1 Hanger bolt STST 10x60 (included in the wall mounting kit)

Environment

Ambient temperature range 0 to 55 °C (32 to 131 °F)

Storage temperature 0 to 60 °C (32 to 140 °F), in the original packaging

Process

Process temperature range 0 to 60 °C (32 to 140 °F)

Process pressure range 0 to 6 bar (0 to 87 psi)

Pressure-temperature ratings

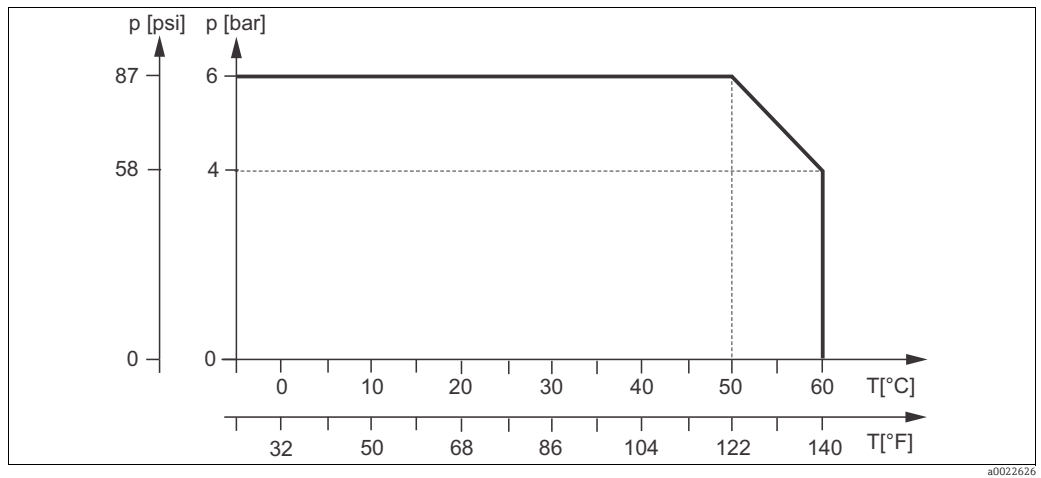

Pressure-temperature ratings

Flow velocity Max. 2 m/s (6.6 ft/s) for low-viscosity media in pipe DN 50

Flow Recommended flow: 60 l/h (15.84 gal/hr)
 Range: 10 to 100 l/h (2.64 to 26.4 gal/hr)
 When operating with lost sample (lost water)

Pressure loss < 0.05 bar (0.7 psi) for flow rates up to 100 l/h (26.4 gal/hr)

Mechanical construction

Dimensions

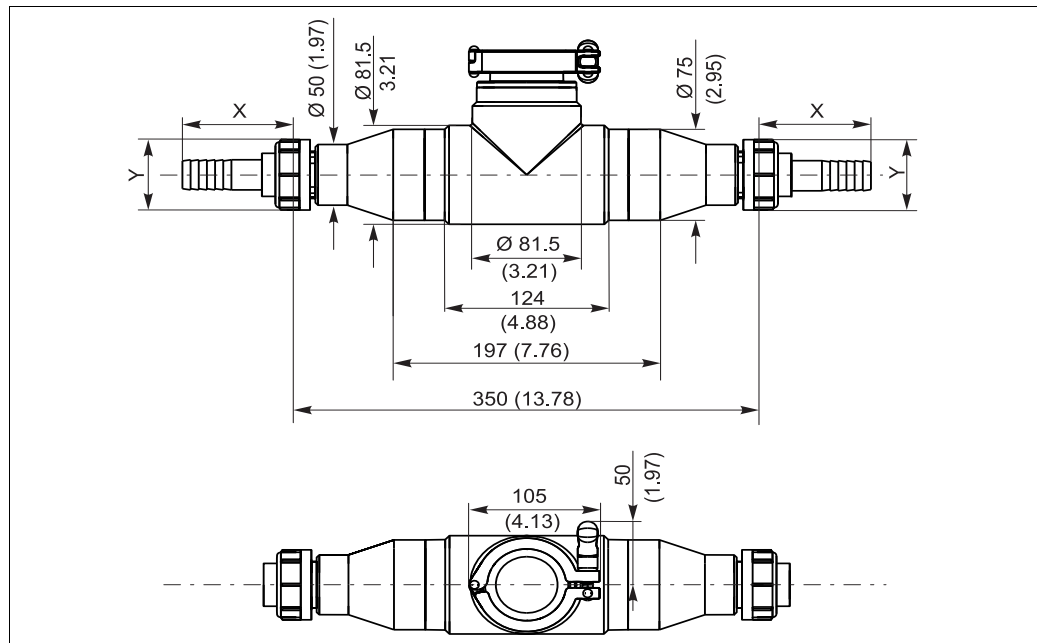

Dimensions in mm (inch)

Connections	NPT ¾"	Rp ¾"	Glue-in port D25	ANSI 2"	Hose D25	Hose D12	G1¼
X mm(inch)	70 (2.76)	64 (2.52)	22 (0.87)	71 (2.80)	74 (2.91)	74 (2.91)	0
Y mm(inch)	Ø 58(2.28)	Ø 58(2.28)	Ø 58(2.28)	Ø 152(5.98)	Ø 58(2.28)	Ø 58(2.28)	Ø 58(2.28)

Process connections

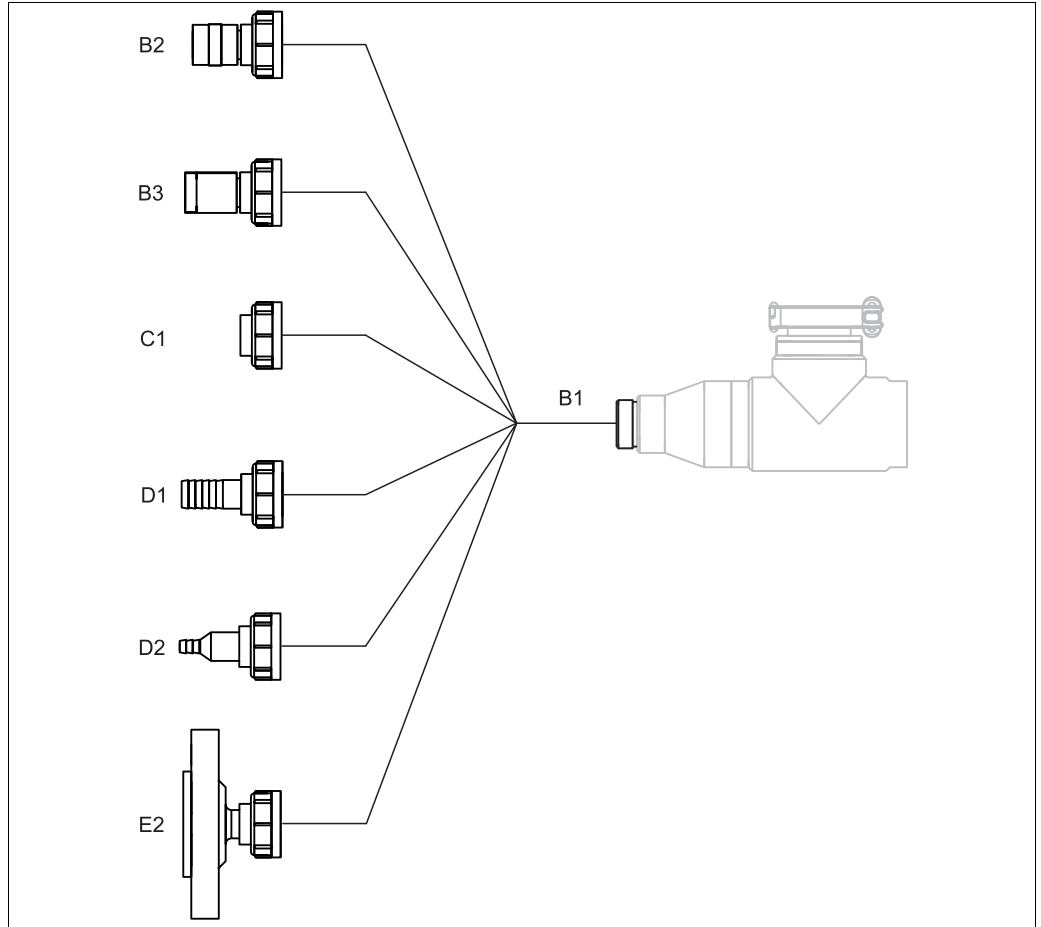

a0022263

Process connections

- B1 External thread G1¼ (standard)
- B2 Internal thread Rp ¾"
- B3 Internal thread NPT ¾"
- C1 Glue-in port D 25 PVC
- D1 Hose D 25 PVC
- D2 Hose D 12 PVC
- E2 Flange ANSI 2"

Weight 1.17 kg (2.58 lbs) without process connection

Materials	Assembly housing: PE Seals: EPDM Flange: PP-GF Dummy cover: Stainless steel 1.4404 (AISI 316 L) Bubble trap: Polycarbonate Process connections: PE Bubble trap process connection: PVC
------------------	--

Ordering information

Product structure

You can create a valid and complete order code online using the Configurator tool:
www.products.endress.com/cua252

1. You can choose from the following options on the right of the product page:

Product page function
:: Add to product list
:: Price & order information
:: Compare this product
:: Configure this product

2. Click "Configure this product".
3. The Configurator opens in a separate window. You can now configure your device and you will receive the complete order code valid for that device.
4. Now export the order code as a PDF file or Excel file. To do so, click the appropriate button at the top of the page.

Scope of delivery

The delivery comprises:

- Flow assembly in the version ordered
- Operating Instructions, English

Accessories

-  The most important accessories available at the time this document went to print are listed below. Contact your Service Department or sales center for accessories that are not listed here.

Connection accessories

Description	Order number
Dummy cover for clamp connection, 1 pc	71242180
Adapter, internal thread, RP 3/4", material: PE; 1 pc	71242172
Adapter, internal thread, NPT 3/4", material: PE; 1 pc	71242173
Adapter, welded connection, D 25, material: PE; 1 pc	71242174
Adapter, hose connection nipple, D 25, material: PE; 1 pc	71242175
Adapter, hose connection nipple, D 12, material: PE; 1 pc	71242176
Adapter, flange ANSI 2", 1 pc	71242177

Air trap

Bubble trap

- For sensor CUS52D
- Process pressure: up to 3 bar (43.5 psi)
- Process temperature: 0 to 50 °C (32 to 122 °F)
- Adapter to D 12 with connection for vent line (top connection on CUA252), is included in the delivery.
- Orifice plates for the following volume flow rates:
 - < 60 l/h (15.8 gal/hr)
 - 60 to 100 l/h (15.8 to 26.4 gal/hr)
 - > 100 l/h (26.4 gal/hr)
- The vent line is fitted with a PVC hose, hose check valve and a Luer lock adapter.
- Order number, suitable for assembly CUA252: 71242170
- Order number, suitable for assembly S of CUS31: 71247364



Air trap, dimensions in mm (inch)

- 1 Medium inlet (excluding hose system)
- 2 Air bubble outlet (hose system included in the delivery)
- 3 Medium outlet (excluding hose system)

Wall mounting kit

Wall mounting kit for CUA252

- Order number: 71242171

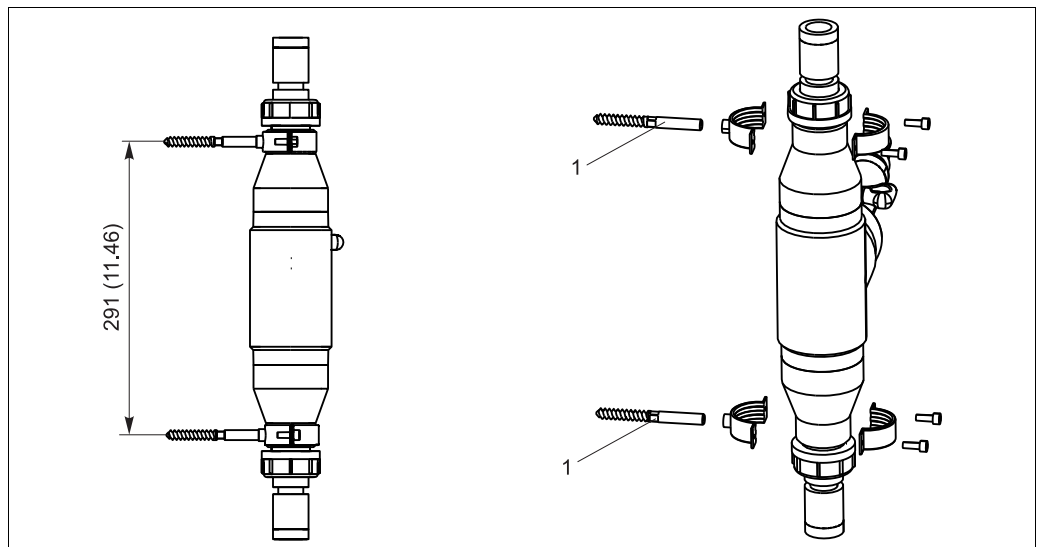

Wall mounting kit

- 1 Hanger bolt STST 10x60 mm (forms part of the delivery)

www.addresses.endress.com
