

en 05-2014/08 50112701



- Configurable with screw terminals or insulation displacement technology
- Very good resistance against oil, cooling agents, lubricants, and chemicals
- Protection class IP 67

**Dimensioned drawing**

M8 connector, axial, 3-/4-pin  
**D M8A-3P-SK**  
**D M8A-4P-SK**

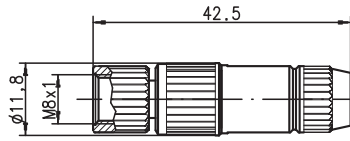

M12 connector, axial, 4-pin  
**KD 095-4A**

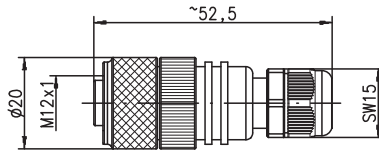

M12 connector, angular, 4-pin  
**KD 095-4**

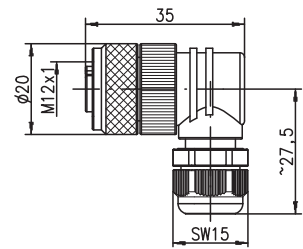

M12 cable plug, axial, 4-/5-pin  
**KS 095-4A**  
**KS 095-5A**

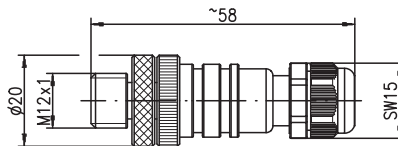

M12 connector, axial, 5-pin  
**KD 095-5A**  
**KD 095-5A-PG9**

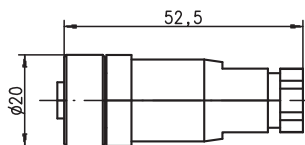

M12 connector, angular, 5-pin  
**KD 095-5**

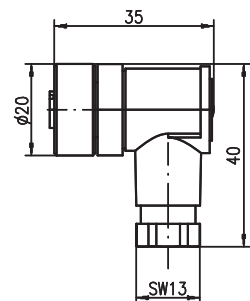

**Contact arrangement**

**M8 connector, 3-pin**

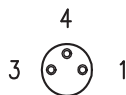

**M12 connector, 4-pin**



**M12 cable plug, 4-pin**

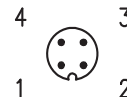

**M8 connector, 4-pin**



**M12 connector, 5-pin**

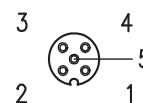

**M12 cable plug, 5-pin**

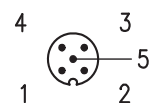

1) only 4-pin M12 connectors and 5-pin M12 plug



We reserve the right to make changes • DS\_Accessory/KDKS\_en\_50112701.fm

## Specifications

### Electrical data

Operating voltage

Operating current  
Insulation grade

### Mechanical data

Connection type  
Conductor cross-section  
Sheath diameter

### Environmental data

Operating temperature range

### M8 connector

≤ 32VAC/DC

≤ 4A per contact  
category II acc. to IEC 60664-1

insulation displacement technology  
0.14 ... 0.34mm<sup>2</sup>  
2.5 ... 5.1 mm (black seal)

-25°C ... +85°C

### M12 connector

4-pin: ≤ 250VAC/DC

5-pin: ≤ 125VAC/DC

≤ 4A per contact  
category II acc. to IEC 60664-1

screw connection  
0.14 ... 0.75mm<sup>2</sup>  
3.0 ... 6.5mm  
PG9: 4.0 ... 8.0mm

## Tables

## Diagrams

## Order guide

### M8 connector

Designation	Part No.	Design	Contacts	Connection type	Other features
D M8A-3P-SK	50104582	axial socket	3	insulation displacement technology	
D M8A-4P-SK	50104583	axial socket	4	insulation displacement technology	

### M12 connector

Designation	Part No.	Design	Contacts	Connection type	Other features
KD 095-4A	50031323	axial socket	4	screw connection	cURus
KD 095-4	50031324	angular socket	4	screw connection	cURus
KS 095-4A	50040155	axial plug	4	screw connection	cURus
KD 095-5A	50020501	axial socket	5	screw connection	
KD 095-5	50020502	angular socket	5	screw connection	
KD 095-5A-PG9	50081461	axial socket	5	screw connection	for cables Ø 4 ... 8mm
KS 095-5A	50114223	axial plug	5	screw connection	cURus

## Remarks