

# Technical data sheet · Plastic elbow fitting AWK-P

Cable fittings and accessories



<b>Identification</b>	Type	AWK-P PG 21
	Part-No.	600276

## Use/Area of application

Properties	<ul style="list-style-type: none"><li>• Elbow fitting with O-Ring seal and additional locking nut</li><li>• Direction of reduction continuously adjustable</li></ul>
------------	--

## Technical data

Material	Polyamide 6 GF 30
Colour	grey or black
Protection class	IP 65
SW	32 mm
O-Ring (OR)	Neoprene
Locking nut	Polyamide 6 GF 30
weight approx.	2.98 kg/100 piece
Thread	PG

## Design

D	32.0 mm
G	PG 21
H	30.0 mm
K	22.0 mm
L 4	9 mm
L	34.5 mm

24.11.2007 – Subject to technical modification

Part-No. 600276

USA: LUTZE INC.

13330 South Ridge Drive • Charlotte, NC 28273  
Tel.: +1 (704) 504-0222 • Fax: +1 (704) 504-0223  
www.lutze.com • info@lutze.com

United Kingdom: LÜTZE Ltd.

Unit 3 Sandy Hill Park  
Sandy Way, Amington • GB-Tamworth, Staffs, B77 4DU  
Tel.: +44 (0)1827 31333-0 • Fax: +44 (0)1827 31333-2  
www.lutze.com • sales.gb@lutze.co.uk

# Technical data sheet · Plastic elbow fitting AWK-P

SW	32 mm
SW 1 = across flats	36 mm

## General

PU	1 piece
----	---------

## Dimensions

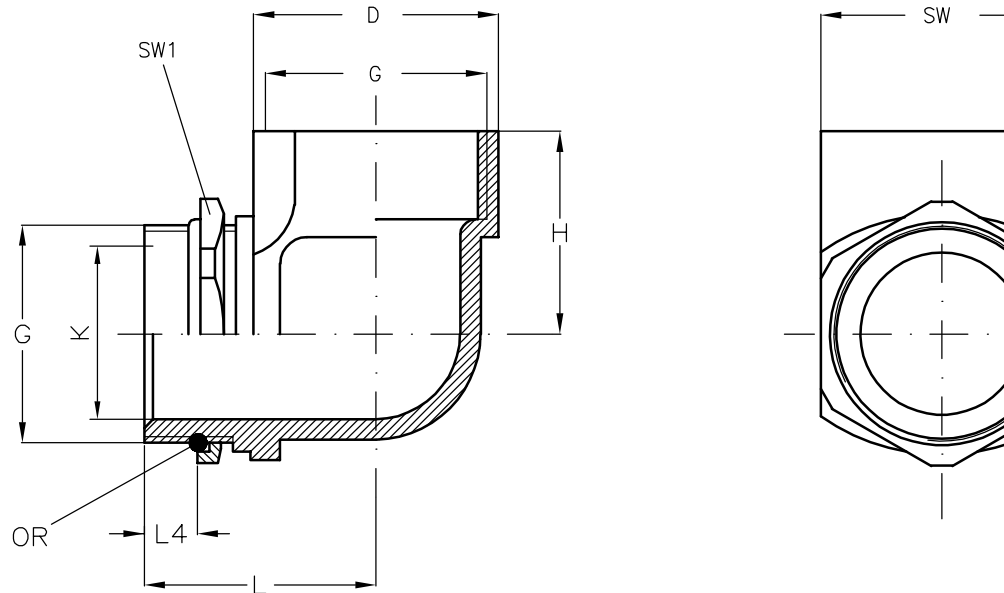

24.11.2007 – Subject to technical modification

Part-No. 600276

USA: LUTZE INC.

13330 South Ridge Drive • Charlotte, NC 28273  
Tel.: +1 (704) 504-0222 • Fax: +1 (704) 504-0223  
www.lutze.com • info@lutze.com

United Kingdom: LÜTZE Ltd.

Unit 3 Sandy Hill Park  
Sandy Way, Amington • GB-Tamworth, Staffs, B77 4DU  
Tel.: +44 (0)1827 31333-0 • Fax: +44 (0)1827 31333-2  
www.lutze.com • sales.gb@lutze.co.uk