

Technical data sheet · Metal accessory expansion EW

Cable fittings and accessories



Identification	Type	EW MS M50/M63
	Part-No.	600286
Use/Application/Characteristics		
Characteristics	<ul style="list-style-type: none">• Expansion from metric to metric• with small outer thread and large inner thread	
Technical data		
Outer Ø	66 mm	
Thread form	metric	
Thread G	M 50×1.5	
Thread G1	M 63×1.5	
L	31 mm	
L1	9 mm	
Construction		
Description	EW MS M50/M63	
Material	Brass nickel-plated	
General		
PU	10 Quantity	

28.01.2017 – Subject to technical modification

Part-No. 600286

USA: LUTZE INC.

13330 South Ridge Drive • Charlotte, NC 28273, USA
Tel. +1 (704) 504-0222 • Fax +1 (704) 504-0223
www.lutze.com • info@lutze.com

United Kingdom: LÜTZE Ltd.

Unit 3, Sandy Hill Park
Sandy Way, Amington • GB-Tamworth, Staffs B77 4DU
Tel. +44 (0)1827 31333-0 • Fax +44 (0)1827 31333-2
www.lutze.com • sales.gb@lutze.co.uk



SYSTEMATIC TECHNOLOGY

Technical data sheet · Metal accessory expansion EW

Dimensions

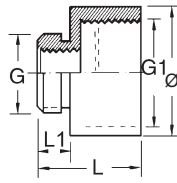

28.01.2017 – Subject to technical modification

Part-No. 600286

USA: LUTZE INC.

13330 South Ridge Drive • Charlotte, NC 28273, USA
Tel. +1 (704) 504-0222 • Fax +1 (704) 504-0223
www.lutze.com • info@lutze.com

United Kingdom: LÜTZE Ltd.

Unit 3, Sandy Hill Park
Sandy Way, Amington • GB-Tamworth, Staffs B77 4DU
Tel. +44 (0)1827 31333-0 • Fax +44 (0)1827 31333-2
www.lutze.com • sales.gb@lutze.co.uk



SYSTEMATIC TECHNOLOGY