

# Technical data sheet · Metal accessory reducing ring RR

Cable fittings and accessories



<b>Identification</b>	Type	RR MS PG16/PG11
	Part-No.	600410
<b>Use/Application/Characteristics</b>		
Characteristics	<ul style="list-style-type: none"><li>• Reducing ring from <b>PG</b> to <b>PG</b></li><li>• with large outer thread and small inner thread</li></ul>	
<b>Technical data</b>		
Outer Ø	24 mm	
Thread form	PG	
Thread G	PG 16	
Thread G1	PG 11	
L	9.5 mm	
L1	6.5 mm	
<b>Construction</b>		
Description	RR MS PG16/PG11	
Material	Brass nickel-plated	
<b>General</b>		
PU	100 Quantity	

28.01.2017 – Subject to technical modification

Part-No. 600410

USA: LUTZE INC.

13330 South Ridge Drive • Charlotte, NC 28273, USA  
Tel. +1 (704) 504-0222 • Fax +1 (704) 504-0223  
www.lutze.com • info@lutze.com

United Kingdom: LÜTZE Ltd.

Unit 3, Sandy Hill Park  
Sandy Way, Amington • GB-Tamworth, Staffs B77 4DU  
Tel. +44 (0)1827 31333-0 • Fax +44 (0)1827 31333-2  
www.lutze.com • sales.gb@lutze.co.uk



SYSTEMATIC TECHNOLOGY

# Technical data sheet · Metal accessory reducing ring RR

---

## Dimensions

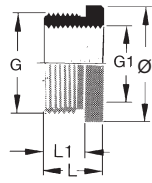

28.01.2017 – Subject to technical modification

Part-No. 600410

USA: LUTZE INC.

13330 South Ridge Drive • Charlotte, NC 28273, USA

Tel. +1 (704) 504-0222 • Fax +1 (704) 504-0223

www.lutze.com • info@lutze.com

United Kingdom: LÜTZE Ltd.

Unit 3, Sandy Hill Park

Sandy Way, Amington • GB-Tamworth, Staffs B77 4DU

Tel. +44 (0)1827 31333-0 • Fax +44 (0)1827 31333-2

www.lutze.com • sales.gb@lutze.co.uk



SYSTEMATIC TECHNOLOGY