

# Technical data sheet · Metal accessory expansion EW

Cable fittings and accessories



<b>Identification</b>	Type	EW MS PG9/PG13,5
	Part-No.	600502
<b>Use/Application/Characteristics</b>		
Characteristics	<ul style="list-style-type: none"><li>• Expansion from <b>PG</b> to <b>PG</b></li><li>• with small outer thread and large inner thread</li></ul>	
<b>Technical data</b>		
Outer Ø	22 mm	
Thread form	PG	
Thread G	PG 9	
Thread G1	PG 13.5	
L	17.5 mm	
L1	6 mm	
<b>Construction</b>		
Description	EW MS PG9/PG13.5	
Material	Brass nickel-plated	
<b>General</b>		
PU	100 Quantity	

28.01.2017 – Subject to technical modification

Part-No. 600502

USA: LUTZE INC.

13330 South Ridge Drive • Charlotte, NC 28273, USA  
Tel. +1 (704) 504-0222 • Fax +1 (704) 504-0223  
www.lutze.com • info@lutze.com

United Kingdom: LÜTZE Ltd.

Unit 3, Sandy Hill Park  
Sandy Way, Amington • GB-Tamworth, Staffs B77 4DU  
Tel. +44 (0)1827 31333-0 • Fax +44 (0)1827 31333-2  
www.lutze.com • sales.gb@lutze.co.uk



SYSTEMATIC TECHNOLOGY

# Technical data sheet · Metal accessory expansion EW

---

## Dimensions

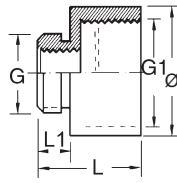

28.01.2017 – Subject to technical modification

Part-No. 600502

USA: LUTZE INC.

13330 South Ridge Drive • Charlotte, NC 28273, USA

Tel. +1 (704) 504-0222 • Fax +1 (704) 504-0223

www.lutze.com • info@lutze.com

United Kingdom: LÜTZE Ltd.

Unit 3, Sandy Hill Park

Sandy Way, Amington • GB-Tamworth, Staffs B77 4DU

Tel. +44 (0)1827 31333-0 • Fax +44 (0)1827 31333-2

www.lutze.com • sales.gb@lutze.co.uk



SYSTEMATIC TECHNOLOGY