

Technical data sheet · Metal fitting TOP-T

Cable fittings and accessories



Identification	Type	TOP-T MS PG16
	Part-No.	600714

Use/Application/Characteristics

Characteristics	<ul style="list-style-type: none">• Cable fitting with hexagon base• Strain relief• Gasket and O-Ring
-----------------	---

Technical data

Clamping range D	8 – 14 mm
Protection class	IP68
	Up to 5 bar
Thread form	PG
Thread G	PG 16
SW 1	24 mm
SW 2	24 mm
L	31.6 mm
L1	6.5 mm

Construction

Description	TOP-T MS PG16
Material	Brass nickel-plated
Material O-ring	Perbunan®
Material sealing ring	NBR

28.01.2017 – Subject to technical modification

Part-No. 600714

USA: LUTZE INC.

13330 South Ridge Drive • Charlotte, NC 28273, USA
Tel. +1 (704) 504-0222 • Fax +1 (704) 504-0223
www.lutze.com • info@lutze.com

United Kingdom: LÜTZE Ltd.

Unit 3, Sandy Hill Park
Sandy Way, Amington • GB-Tamworth, Staffs B77 4DU
Tel. +44 (0)1827 31333-0 • Fax +44 (0)1827 31333-2
www.lutze.com • sales.gb@lutze.co.uk



SYSTEMATIC TECHNOLOGY

Technical data sheet · Metal fitting TOP-T

General

PU

50 Quantity

Dimensions

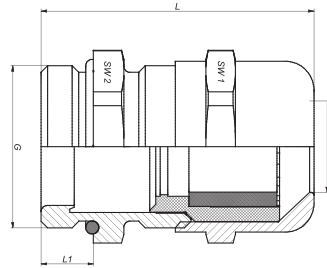

28.01.2017 – Subject to technical modification

Part-No. 600714

USA: LUTZE INC.

13330 South Ridge Drive · Charlotte, NC 28273, USA
Tel. +1 (704) 504-0222 · Fax +1 (704) 504-0223
www.lutze.com · info@lutze.com

United Kingdom: LÜTZE Ltd.

Unit 3, Sandy Hill Park
Sandy Way, Amington · GB-Tamworth, Staffs B77 4DU
Tel. +44 (0)1827 31333-0 · Fax +44 (0)1827 31333-2
www.lutze.com · sales.gb@lutze.co.uk



SYSTEMATIC TECHNOLOGY