

# Technical data sheet · Metal fitting TOP-T

Cable fittings and accessories



<b>Identification</b>	Type	TOP-T MS PG42
	Part-No.	600718

## Use/Application/Characteristics

Characteristics	<ul style="list-style-type: none"><li>• Cable fitting with hexagon base</li><li>• Strain relief</li><li>• Gasket and O-Ring</li></ul>
-----------------	---

## Technical data

Clamping range D	26 – 35 mm
Protection class	IP68
	Up to 5 bar
Thread form	PG
Thread G	PG 42
SW 1	57 mm
SW 2	57 mm
L	55 mm
L1	10 mm

## Construction

Description	TOP-T MS PG42
Material	Brass nickel-plated
Material O-ring	Perbunan®
Material sealing ring	NBR

28.01.2017 – Subject to technical modification

Part-No. 600718

USA: LUTZE INC.

13330 South Ridge Drive • Charlotte, NC 28273, USA  
Tel. +1 (704) 504-0222 • Fax +1 (704) 504-0223  
www.lutze.com • info@lutze.com

United Kingdom: LÜTZE Ltd.

Unit 3, Sandy Hill Park  
Sandy Way, Amington • GB-Tamworth, Staffs B77 4DU  
Tel. +44 (0)1827 31333-0 • Fax +44 (0)1827 31333-2  
www.lutze.com • sales.gb@lutze.co.uk



SYSTEMATIC TECHNOLOGY

# Technical data sheet · Metal fitting TOP-T

---

## General

---

PU

5 Quantity

---

## Dimensions

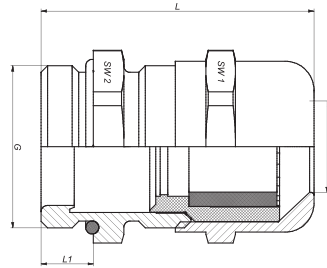

28.01.2017 – Subject to technical modification

Part-No. 600718

USA: LUTZE INC.

13330 South Ridge Drive · Charlotte, NC 28273, USA  
Tel. +1 (704) 504-0222 · Fax +1 (704) 504-0223  
www.lutze.com · info@lutze.com

United Kingdom: LÜTZE Ltd.

Unit 3, Sandy Hill Park  
Sandy Way, Amington · GB-Tamworth, Staffs B77 4DU  
Tel. +44 (0)1827 31333-0 · Fax +44 (0)1827 31333-2  
www.lutze.com · sales.gb@lutze.co.uk



SYSTEMATIC TECHNOLOGY