

Technical data sheet · Metal fitting TOP-T

Cable fittings and accessories



Identification	Type	TOP-T MS M25×1,5 SW30
	Part-No.	600762
Use/Application/Characteristics		
Characteristics	<ul style="list-style-type: none">• Cable fitting with hexagon base• Strain relief• Gasket and O-Ring	
Technical data		
Clamping range D	11 – 18 mm	
Protection class	IP68	
	Up to 5 bar	
Thread form	metric	
Thread G	M 25×1.5	
SW 1	30 mm	
SW 2	30 mm	
L	36 mm	
L1	7 mm	
Construction		
Description	TOP-T MS M25×1.5 SW30	
Material	Brass nickel-plated	
Material O-ring	Perbunan®	
Material sealing ring	NBR	

28.01.2017 – Subject to technical modification

Part-No. 600762

USA: LUTZE INC.

13330 South Ridge Drive • Charlotte, NC 28273, USA
Tel. +1 (704) 504-0222 • Fax +1 (704) 504-0223
www.lutze.com • info@lutze.com

United Kingdom: LÜTZE Ltd.

Unit 3, Sandy Hill Park
Sandy Way, Amington • GB-Tamworth, Staffs B77 4DU
Tel. +44 (0)1827 31333-0 • Fax +44 (0)1827 31333-2
www.lutze.com • sales.gb@lutze.co.uk



SYSTEMATIC TECHNOLOGY

Technical data sheet · Metal fitting TOP-T

General

PU

25 Quantity

Dimensions

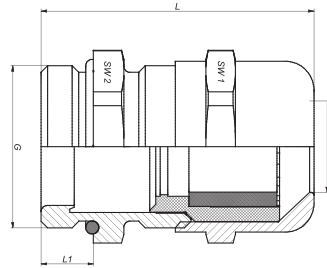

28.01.2017 – Subject to technical modification

Part-No. 600762

USA: LUTZE INC.

13330 South Ridge Drive • Charlotte, NC 28273, USA
Tel. +1 (704) 504-0222 • Fax +1 (704) 504-0223
www.lutze.com • info@lutze.com

United Kingdom: LÜTZE Ltd.

Unit 3, Sandy Hill Park
Sandy Way, Amington • GB-Tamworth, Staffs B77 4DU
Tel. +44 (0)1827 31333-0 • Fax +44 (0)1827 31333-2
www.lutze.com • sales.gb@lutze.co.uk



SYSTEMATIC TECHNOLOGY