

Technical data sheet -

Jumper combs



Identification	Type	LCIS-BKW-4-polig
	Part-No.	762813.1000
<hr/>		
Description	Insulated jumper combs white	
<hr/>		
Technical data	Rated current DC 6 A	
	Pole number 4	
<hr/>		
General	Connection device plug-in	
	Contact design Flat contact 0.5 mm Ribbing on the sides	
	Pin spacing 6.2 mm	
	Length 24.8 mm	
	Contact material CuZn	
	Material Vectra C 1330	
	Color white	
	Flamability according to UL 94 V0	
	Operation temperature range -40 °C ... +80 °C	
	Storage temperature range -40 °C ... +80 °C	
	Weight 0.0010 kg/piece	

25.08.2017 – Subject to technical modification

Part-No. 762813.1000

USA: LUTZE INC.

13330 South Ridge Drive • Charlotte, NC 28273, USA
Tel. +1 (704) 504-0222 • Fax +1 (704) 504-0223
www.lutze.com • info@lutze.com

United Kingdom: LÜTZE Ltd.

Unit 3, Sandy Hill Park
Sandy Way, Amington • GB-Tamworth, Staffs B77 4DU
Tel. +44 (0)1827 31333-0 • Fax +44 (0)1827 31333-2
www.lutze.com • sales.gb@lutze.co.uk



SYSTEMATIC TECHNOLOGY

Technical data sheet -

PU

10

Dimensions

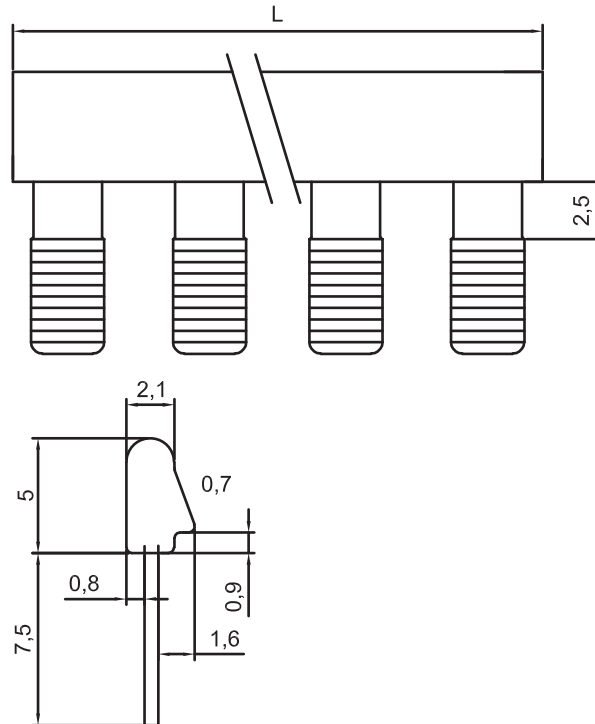

25.08.2017 – Subject to technical modification

Part-No. 762813.1000

USA: LUTZE INC.

13330 South Ridge Drive • Charlotte, NC 28273, USA

Tel. +1 (704) 504-0222 • Fax +1 (704) 504-0223

www.lutze.com • info@lutze.com

United Kingdom: LÜTZE Ltd.

Unit 3, Sandy Hill Park

Sandy Way, Amington • GB-Tamworth, Staffs B77 4DU

Tel. +44 (0)1827 31333-0 • Fax +44 (0)1827 31333-2

www.lutze.com • sales.gb@lutze.co.uk



SYSTEMATIC TECHNOLOGY