

## Technical data sheet -

Jumper combs

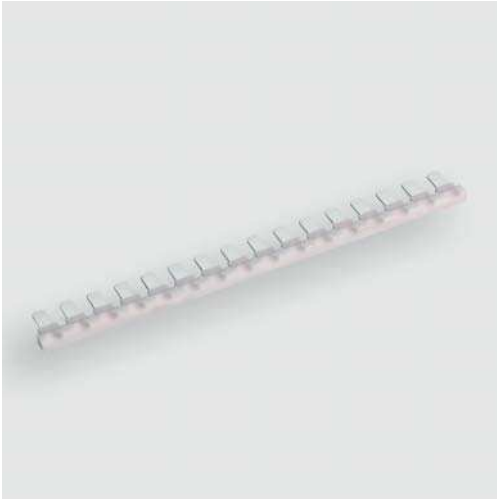

<b>Identification</b>	Type Part-No.	LCIS-BKW-16-polig 762833.1000
<b>Description</b>	Insulated jumper combs white	
<b>Technical data</b>	Rated current DC 6 A Pole number 16	
<b>General</b>	Connection device plug-in Contact design Flat contact 0.5 mm Ribbing on the sides Pin spacing 6.2 mm Length 99.2 mm Contact material CuZn Material Vectra C 1330 Color white Flamability according to UL 94 V0 Operation temperature range -40 °C ... +80 °C Storage temperature range -40 °C ... +80 °C Weight 0.0040 kg/piece	

25.08.2017 – Subject to technical modification

Part-No. 762833.1000

USA: LUTZE INC.

13330 South Ridge Drive • Charlotte, NC 28273, USA  
Tel. +1 (704) 504-0222 • Fax +1 (704) 504-0223  
www.lutze.com • info@lutze.com

United Kingdom: LÜTZE Ltd.

Unit 3, Sandy Hill Park  
Sandy Way, Amington • GB-Tamworth, Staffs B77 4DU  
Tel. +44 (0)1827 31333-0 • Fax +44 (0)1827 31333-2  
www.lutze.com • sales.gb@lutze.co.uk



SYSTEMATIC TECHNOLOGY

# Technical data sheet -

PU

10

## Dimensions

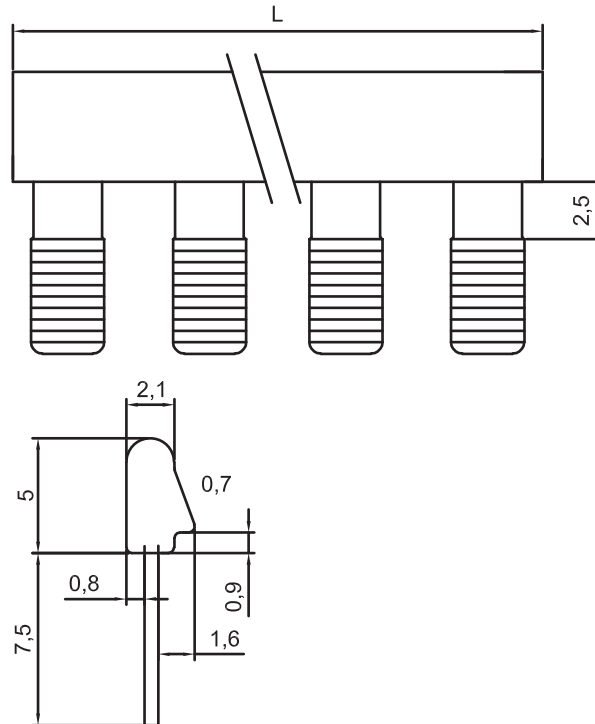

25.08.2017 – Subject to technical modification

Part-No. 762833.1000

USA: LUTZE INC.

13330 South Ridge Drive • Charlotte, NC 28273, USA

Tel. +1 (704) 504-0222 • Fax +1 (704) 504-0223

www.lutze.com • info@lutze.com

United Kingdom: LÜTZE Ltd.

Unit 3, Sandy Hill Park

Sandy Way, Amington • GB-Tamworth, Staffs B77 4DU

Tel. +44 (0)1827 31333-0 • Fax +44 (0)1827 31333-2

www.lutze.com • sales.gb@lutze.co.uk