

T0(3)-.../E
T0(3)-.../EZ
T0(3)-.../E/SVB
T0(3)-.../EA/SVB

T0(3)-.../E

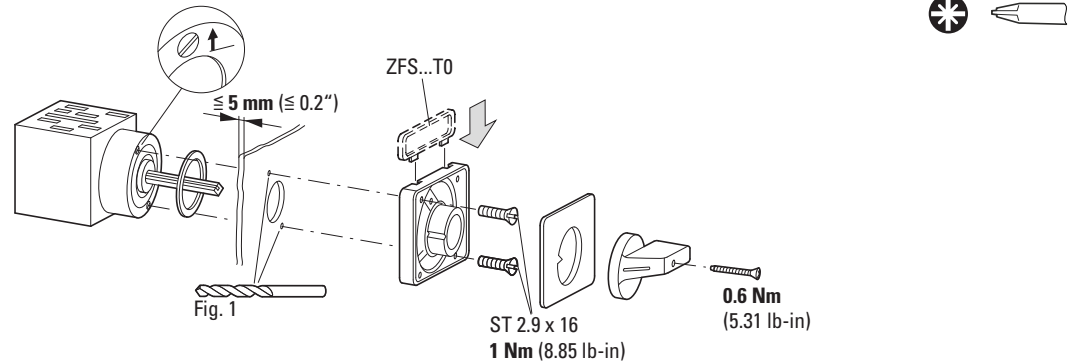

T0(3)-.../EZ/OFS
T0(3)-.../EZ

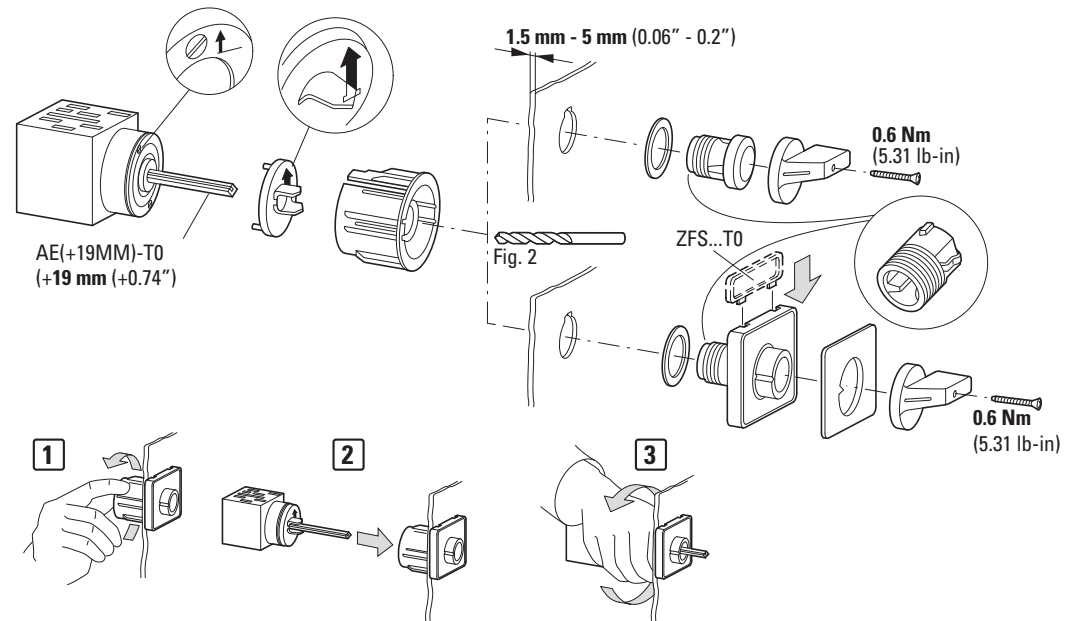

UL/CSA:

Suitable For Use As Motor Branch
Circuit Disconnecting Means With
Suffix SVB.
Break All Lines.

Short Circuit Withstand
10 kA RMS SYM 600 V AC
Max Fuse T0... - 20 A Class J
T3... - 40 A Class J

Standard Short Circuit
5 kA RMS SYM 600 V AC
Max Fuse T0... - 50 A
T3... - 40 A
Max Cir. Bkr. T0... - 50 A
T3... - 125 A

Switch or enclosure must be
padlockable if used as a Motor
Branch Circuit Disconnecter means.

Fig. 1
→ × 1 : 1

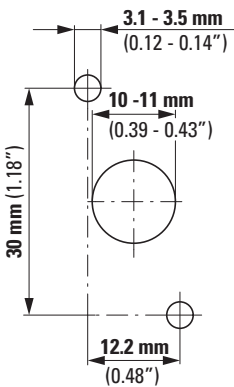
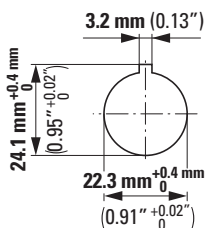
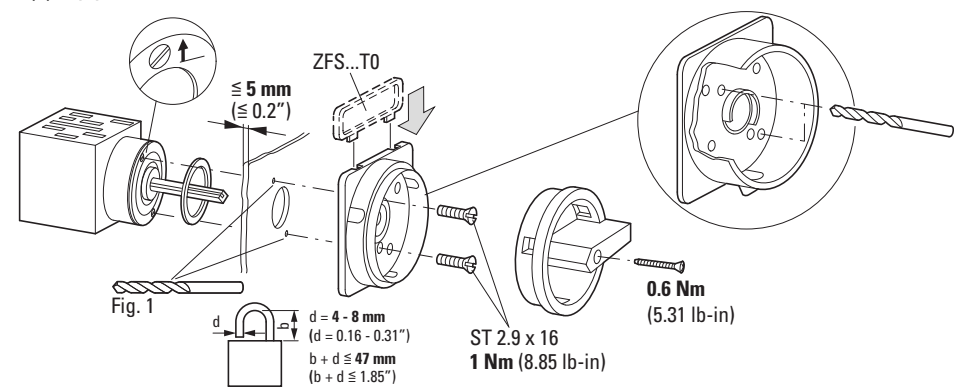

Fig. 2
→ × 1 : 1



T0(3)-.../E/SVB



T0(3)-.../EA/SVB

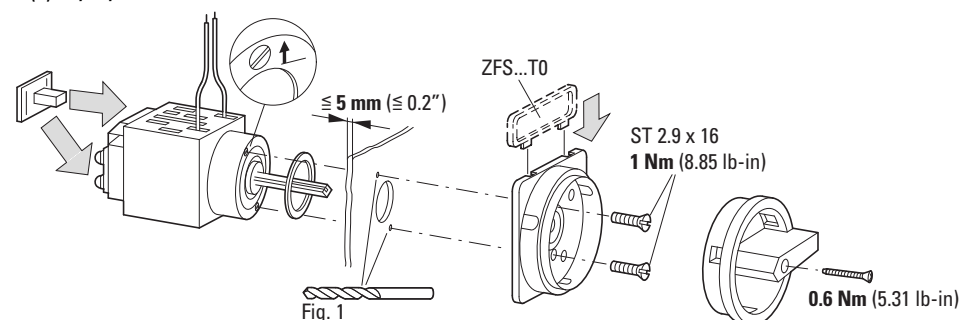

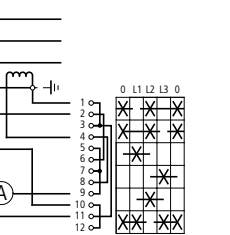
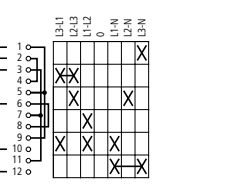
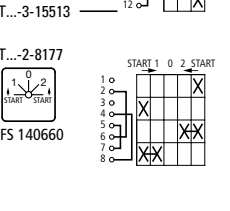
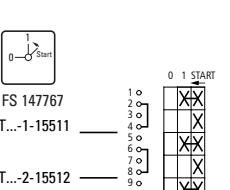
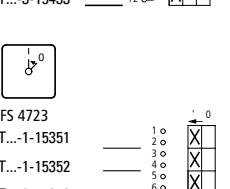
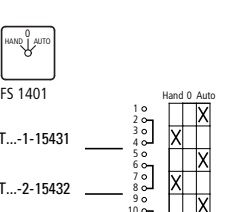
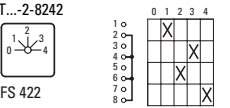
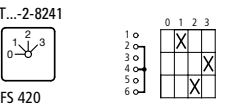
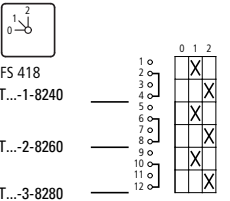
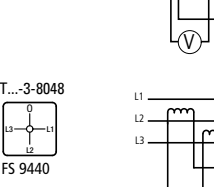
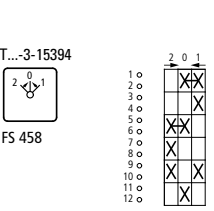
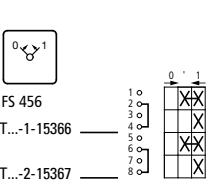
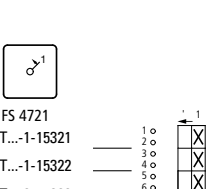
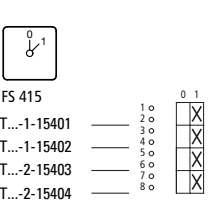
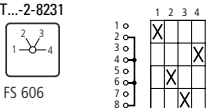
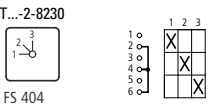
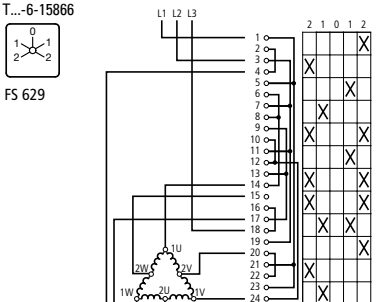
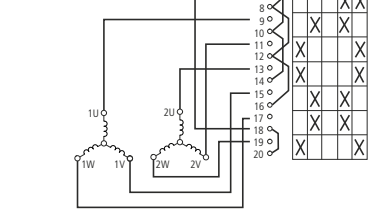
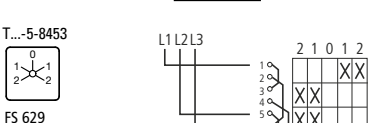
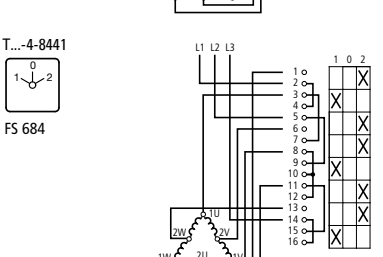
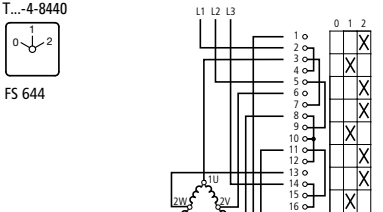
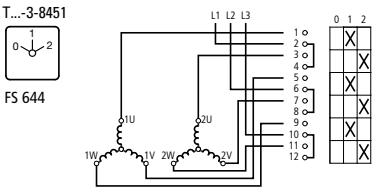
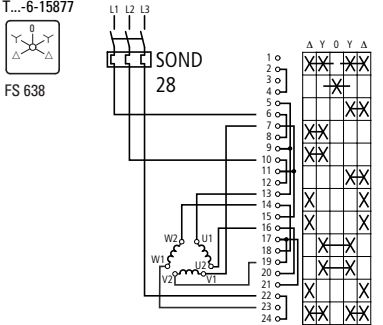
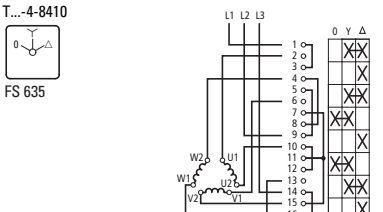
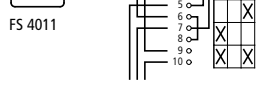
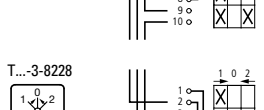
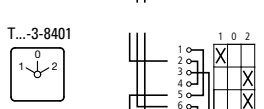
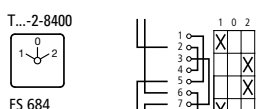
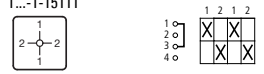
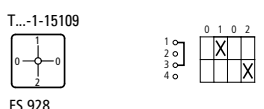
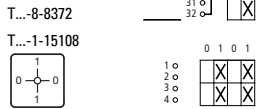
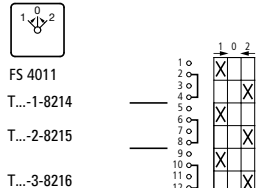
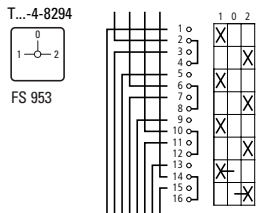
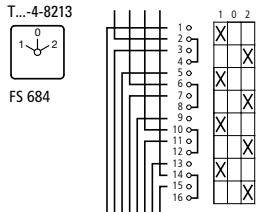
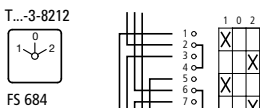
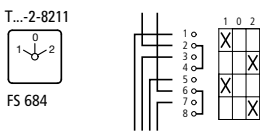
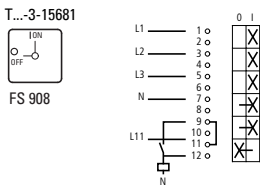
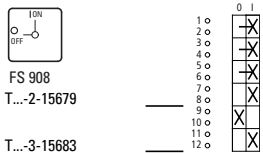
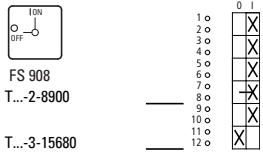
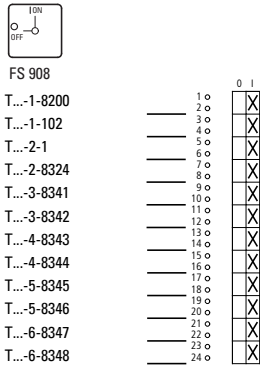

07/16 IL03801020Z