

M8 female 90° snap-in with cable

PUR 4x0.25 gy UL/CSA+robot+drag chain 1,5m

M8

Female 90°

4-pole

Snap In

Plastic housings with good resistance against chemicals and oils. The resistance to aggressive media should be individually tested for your application. Further details on request.

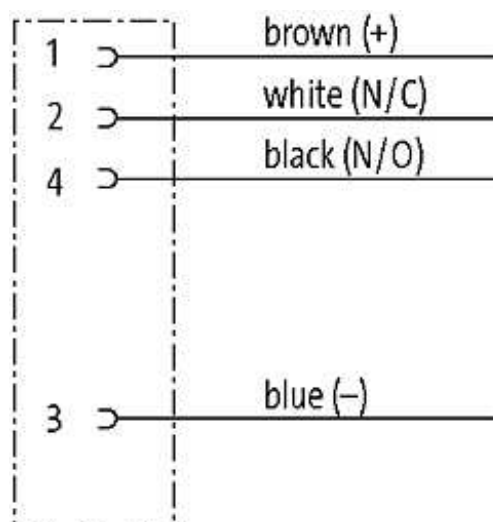
[**Link to Product**](#)**Illustration**

Female

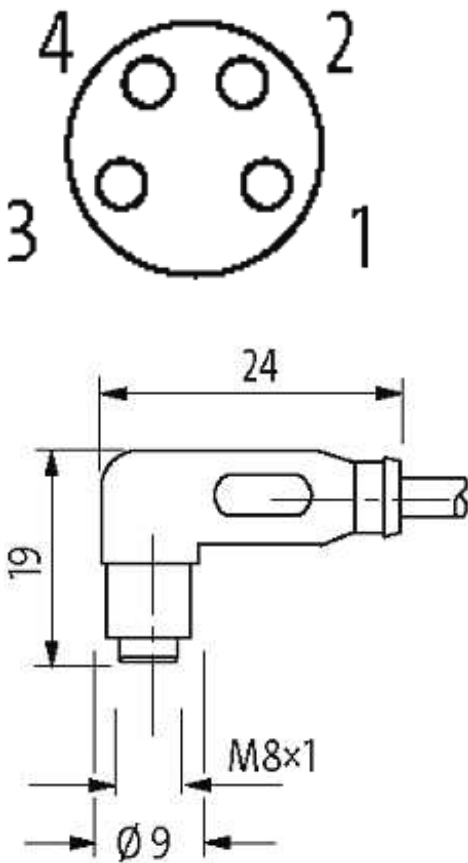

Product may differ from Image

Approvals

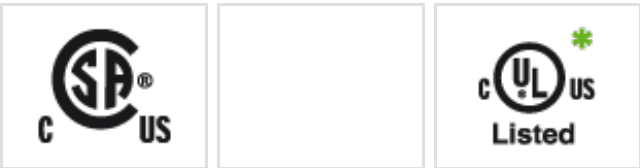

* only for products with UL/CSA approved cable

Form

Form 08261

Cables

Cable number	251
No./diameter of wires	4 × 0.25 mm²
Wire isolation	PP (br, wh, bl, bk)
C-track properties	10 Mio.
Torsion	1 Mio. ± 360°/m

Jacket Color	gray
Shore hardness outer jacket	58 ± 3D
Material (jacket)	PUR (UL/CSA), welding spark res.
Outer Ø	approx. 4.7 mm
Bend radius (fixed)	5 × outer Ø
Bend radius (moving)	10 × outer Ø
Temperature range (fixed)	-40...+90 °C
Temperature range (mobile)	-25...+90 °C

General data

Temperature range	-25...+85 °C, depending on cable quality
-------------------	--

Technical Data

Operating voltage	max. 30 V AC/DC
Operating current per contact	max. 4 A
Locking of ports	Snap In
Protection	IP65

Commercial data

country of origin	DE
customs tariff number	85444290
minimum order quantity	1