

M12 female receptacle 90° Y-cod. solder terminal

Flange M12 female
Mounting nut
Y-coded, 8-pole
Solder connection
90°
Front mounting

[Link to Product](#)**Illustration**

Female

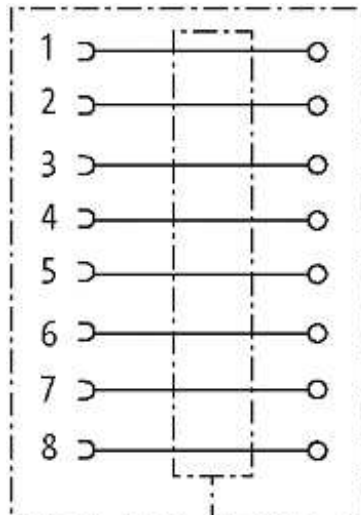
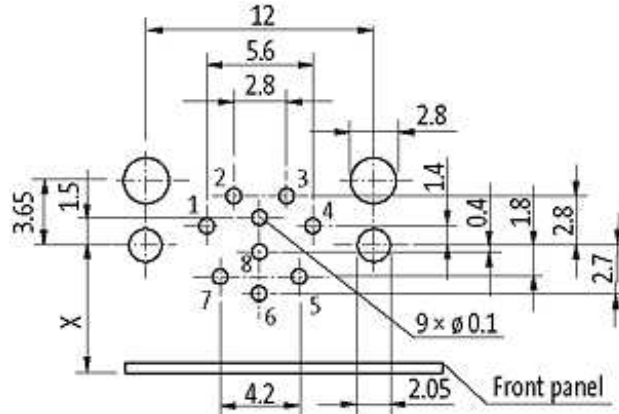
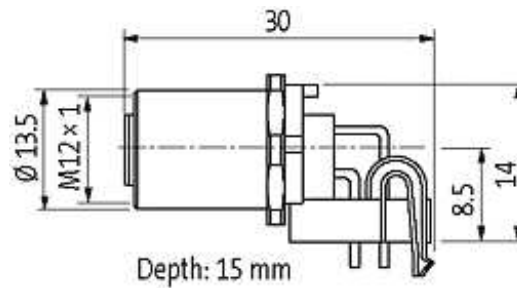
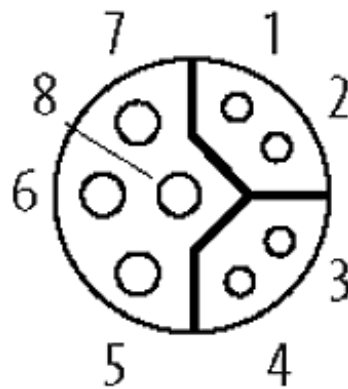

Product may differ from Image

Form

Form 15711

General data

Temperature range -40...+85 °C

Technical Data

Operating voltage max. 30 V DC

Operating current per contact 0.5 A (Data), 6 A (Power)

Locking of ports Screw thread M12 × 1 mm (recommended torque 0.6 Nm) self-securing

Protection IP67 inserted and tightened (EN 60529)

Commercial data

country of origin	DE
customs tariff number	85366990
minimum order quantity	1