

**M12 FEMALE 0° SHIELDED**

PUR 12x0,14 shielded black UL/CSA, drag ch 2m

M12

Female straight

12-pole, shielded

Plastic housings with good resistance against chemicals and oils. The resistance to aggressive media should be individually tested for your application. Further details on request. Further cable lengths on request.

**[Link to Product](#)****Illustration**

1	↷		brown
2	↷		blue
3	↷		white
4	↷		green
5	↷		pink
6	↷		yellow
7	↷		black
8	↷		gray
9	↷		red
10	↷		violet
11	↷		gray/pink
12	↷		red/blue
			shield

Female

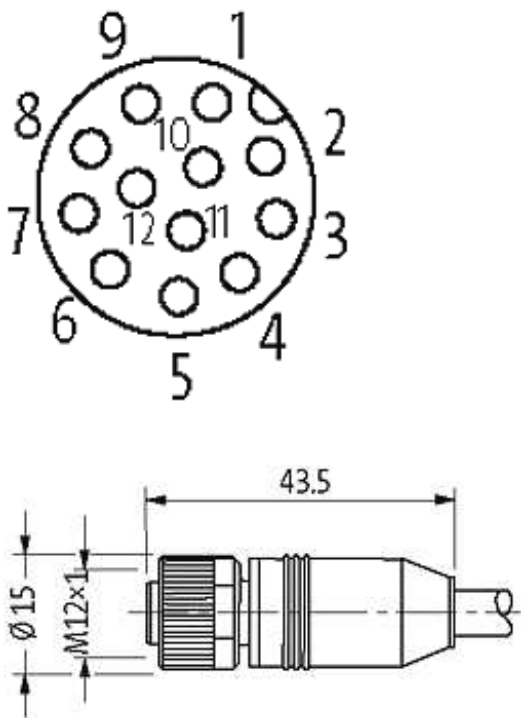

Product may differ from Image

Approvals



Form

Form 19341

Cables

Cable number	706
No./diameter of wires	12 × 0.14 mm²
Wire isolation	PP (br, bl, wh, gn, pk, ye, bk, gr, rd, vi, grpk, rdbl)
C-track properties	5 Mio.
Torsion	2 Mio. ± 30°/m
Jacket Color	black
Shore hardness outer jacket	90 ± 5A
Material (jacket)	PUR (UL/CSA)
Outer Ø	approx. 6.5 mm
Bend radius (fixed)	5 × outer Ø
Bend radius (moving)	10 × outer Ø
Temperature range (fixed)	-40...+80 °C
Temperature range (mobile)	-25...+80 °C

Shielded yes

**General data**

Temperature range -25...+85 °C, depending on cable quality

**Technical Data**

Operating voltage max. 30 V AC/DC

Operating current per contact max. 1.5 A

Locking of ports Screw thread M12 × 1 mm (recommended torque 0.6 Nm) self-securing

Protection IP66K, IP67 inserted and tightened (EN 60529)

**Commercial data**

country of origin DE

customs tariff number 85444290

minimum order quantity 1