

M23 FEMALE, 90° 12 POLE

PUR 8x0,34+3X0.75 GRAY, drag ch 25m

M23

Female 90°

12-pole

11-pole used

for 8-way distribution box, 4-pole

Further cable lengths on request. Plastic housings with good resistance against chemicals and oils. The resistance to aggressive media should be individually tested for your application. Further details on request.

[Link to Product](#)**Illustration**

1	white
2	green
3	yellow
4	gray
5	pink
6	red
7	black
8	violet
11	brown 0.75 mm ²
9	blue 0.75 mm ²
12	green/yellow 0.75 mm ²

Female

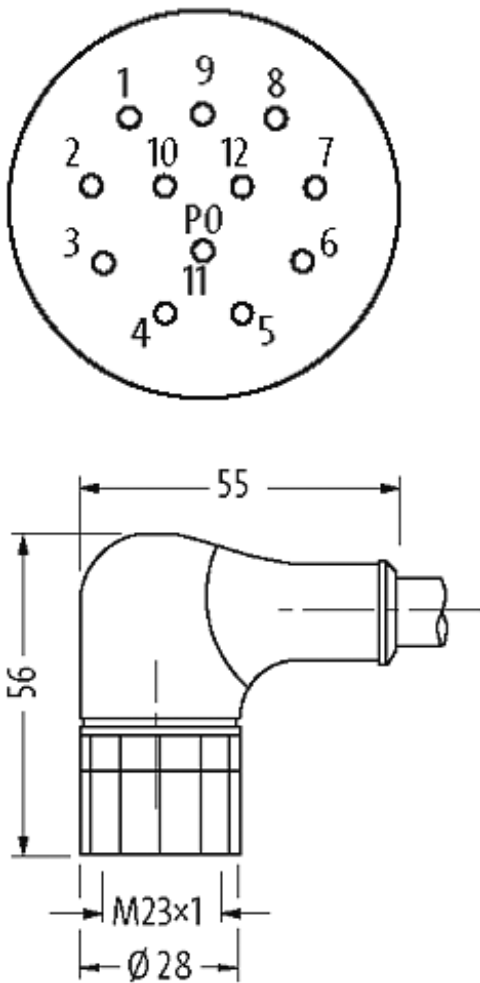

Product may differ from Image

Form	
Form	23151
Cables	
Cable number	362
No./diameter of wires	8×0.34 + 3×0.75 mm²
Wire isolation	PVC
C-track properties	2 Mio.
Jacket Color	gray
Shore hardness outer jacket	85 ± 5A
Material (jacket)	PUR/PVC
Outer Ø	approx. 9.1 mm
Bend radius (fixed)	10 × outer Ø
Bend radius (moving)	12 × outer Ø
Temperature range (fixed)	-30...+80 °C
Temperature range (mobile)	-5...+80 °C

General data

Temperature range	-25...+85 °C, depending on cable quality
-------------------	--

Technical Data

Operating voltage	max. 125 V AC/DC
Operating current per contact	max. 7.5 A
Locking of ports	Screw thread M23 × 1 mm (recommended torque 2.0 Nm) self-securing
Compression gland	M23 (SW27)
Protection	IP65 and IP67 when plugged and screwed down (EN 60529)
Locking material	CuZn, nickel plated
Material	PUR

Commercial data

customs tariff number	85444290
minimum order quantity	1