

M23 female 90° with cable

PUR 8x0.5+3x1.0 gy UL/CSA+drag chain 10m

M23

Female 90°

19-pole

11-pole used

for 4-way distribution boxes, 5-pole

Further cable lengths on request. Plastic housings with good resistance against chemicals and oils. The resistance to aggressive media should be individually tested for your application. Further details on request.

[Link to Product](#)**Illustration**

15	white
7	gray/pink
5	green
4	red/blue
16	yellow
8	white/green
3	gray
14	brown/green
19	brown 1.0 mm²
6	blue 1.0 mm²
12	green/yellow 1.0 mm²

Female

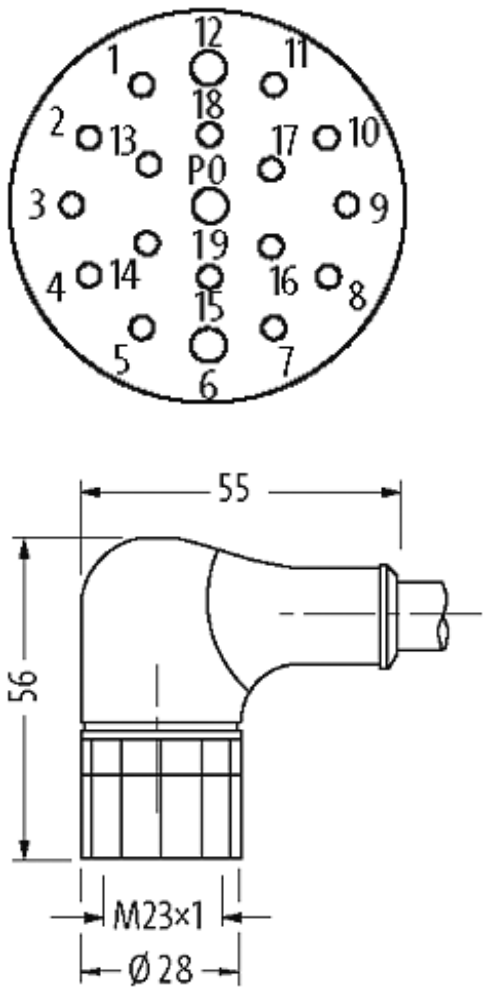

Product may differ from Image

Cables	
Cable number	448
No./diameter of wires	8×0.5 + 3×1.0 mm²
Wire isolation	TPE (grpk, wh, rdbl, gn, whgn, ye, brgn, gr, br, bl, gnye)
C-track properties	5 Mio.
Jacket Color	gray
Shore hardness outer jacket	94 ± 5A
Material (jacket)	PUR (UL/CSA)
Outer Ø	approx. 9.1 mm
Bend radius (fixed)	5 × outer Ø
Bend radius (moving)	10 × outer Ø
Temperature range (fixed)	-40...+90 °C
Temperature range (mobile)	-40...+90 °C
General data	
Temperature range	-25...+85 °C, depending on cable quality

Technical Data

Operating current per contact	max. 7.5 A
-------------------------------	------------

Commercial data

country of origin	DE
customs tariff number	85444290
minimum order quantity	1