

M23 female 90° with cable

PUR 16x0.34+3x0.75 gy drag chain 15m

M23

Female 90°

19-pole

19-pole used

for 8-way distribution boxes, 5-pole

Further cable lengths on request. Plastic housings with good resistance against chemicals and oils. The resistance to aggressive media should be individually tested for your application. Further details on request.

Link to Product**Illustration**

| | |
|----|---------------------------------|
| 15 | white |
| 7 | gray/pink |
| 5 | green |
| 4 | red/blue |
| | yellow |
| 16 | white/green |
| 8 | gray |
| 3 | brown/green |
| 14 | pink |
| 17 | white/yellow |
| 9 | red |
| 2 | yellow/brown |
| 13 | black |
| 11 | white/gray |
| 10 | violet |
| 1 | gray/brown |
| 18 | brown 1.0mm ² |
| 19 | blue 1.0mm ² |
| 6 | green/yellow 1.0mm ² |
| 12 | |

Female

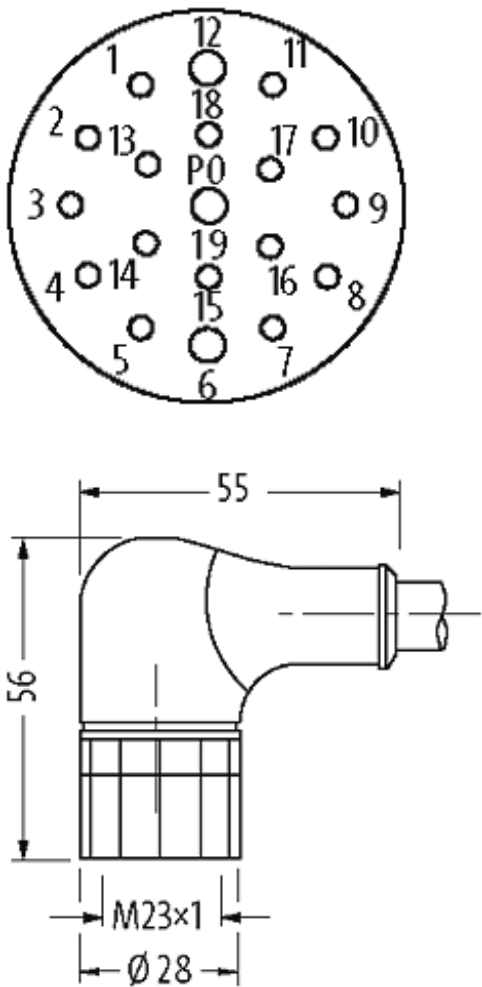

Product may differ from Image

| Form | |
|-----------------------------|----------------------|
| Form | 23351 |
| Cables | |
| Cable number | 398 |
| No./diameter of wires | 16×0.34 + 3×0.75 mm² |
| Wire isolation | PVC |
| C-track properties | 1 Mio. |
| Jacket Color | gray |
| Shore hardness outer jacket | 85 ± 5A |
| Material (jacket) | PUR/PVC |
| Outer Ø | approx. 10.6 mm |
| Bend radius (fixed) | 10 × outer Ø |
| Bend radius (moving) | 12 × outer Ø |
| Temperature range (fixed) | -30...+80 °C |
| Temperature range (mobile) | -5...+70 °C |

General data

| | |
|-------------------|--|
| Temperature range | -25...+85 °C, depending on cable quality |
|-------------------|--|

Technical Data

| | |
|-------------------|------------------|
| Operating voltage | max. 125 V AC/DC |
|-------------------|------------------|

| | |
|-------------------------------|------------|
| Operating current per contact | max. 7.5 A |
|-------------------------------|------------|

| | |
|------------------|-------------------------|
| Locking of ports | Screw thread M23 × 1 mm |
|------------------|-------------------------|

| | |
|------------|--|
| Protection | IP67 inserted and tightened (EN 60529) |
|------------|--|

Commercial data

| | |
|-------------------|----|
| country of origin | DE |
|-------------------|----|

| | |
|-----------------------|----------|
| customs tariff number | 85444290 |
|-----------------------|----------|

| | |
|------------------------|---|
| minimum order quantity | 1 |
|------------------------|---|