

**M12 male receptacle A-cod. front mount V2A**

PP-wires 12x0,14 0.5m

Flange M12 male  
Stainless Steel 1.4305 (V2A)  
12-pole  
Front mounting  
with multi-strand wire

[Link to Product](#)**Illustration**

1	■	brown
2	■	blue
3	■	white
4	■	green
5	■	pink
6	■	yellow
7	■	black
8	■	gray
9	■	red
10	■	violet
11	■	gray/pink
12	■	red/blue

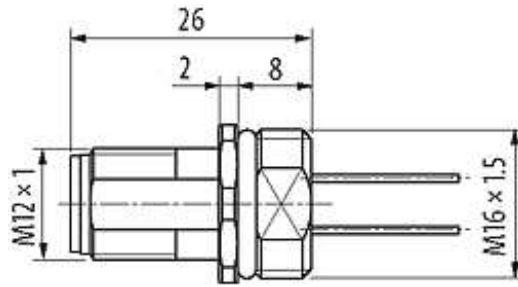

Product may differ from Image

### Form

Form 19161

### Cables

Cable number	979
No./diameter of wires	12 x 0.14 mm <sup>2</sup>
Wire isolation	PP (br, bl, wh, gn, pk, ye, bk, gr, rd, vi, grpk, rdbl)
Shore hardness outer jacket	74 ± 5D
Outer Ø	approx. 1.25 mm
Bend radius (fixed)	5 x outer Ø
Bend radius (moving)	15 x outer Ø
Temperature range (fixed)	-40...+85 °C
Temperature range (mobile)	-25...+85 °C

### General data

Temperature range -25...+85 °C

### Technical Data

Operating voltage	max. 30 V AC/DC
Operating current per contact	max. 1.5 A
Locking of ports	Screw thread M12 x 1 mm (recommended torque 0.6 Nm) self-securing
Locking material	Stainless Steel 1.4305 (V2A)
Protection	IP66K, IP67 inserted and tightened (EN 60529)

### Commercial data

country of origin	DE
customs tariff number	85444290
minimum order quantity	10