

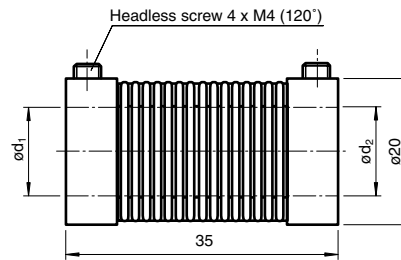

## Dimensions



## Model Number

**9409 6\*8**

Bellows coupling

## Features

- Bellows coupling

## Technical data

### Mechanical specifications

Shaft diameter	d1 = 6 mm , d2 = 8 mm
Material	CuZn20, nickel-plated
Mass	approx. 34 g
Rotational speed	max. 8000 min <sup>-1</sup>
Rated torque	0.8 Nm
Tightening torque, fixing screws	1.5 Nm
Radial offset	max. ± 0.3 mm
Axial offset	max. ± 0.5 mm
Angle error	max. ± 4 °
Moment of inertia	22 kg m <sup>2</sup> x 10 <sup>-7</sup>
Mounting	clamp screws