



**Model Number**

**UB500-30GM65-WS3-BHMS5**

Single head system

**Features**

- AC switchpoint output
- 330° high visibility LEDs
- Fingertip range adjustability

**Diagrams**

**Characteristic response curve**

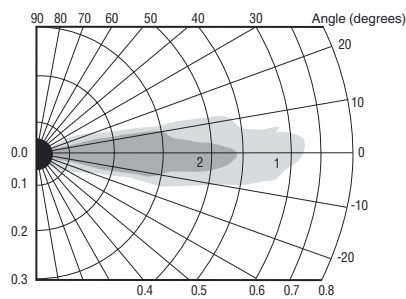

Curve 1: Flat surface 100 mm x 100 mm  
 Curve 2: Round bar,  $\varnothing$  25 mm

**Technical data**

**General specifications**

Sensing range	70 ... 500 mm
Unusable area	0 ... 70 mm
Standard target plate	100 mm x 100 mm
Transducer frequency	400 kHz
Response delay	$\leq$ 45 ms

**Indicators/operating means**

LED green	power
LED red	output

**Electrical specifications**

Operating voltage $U_B$	90 ... 140 V AC
Power consumption $P_0$	$\leq$ 75 mA

**Output**

Output type	Thyristor , 1 NO
Rated operating current $I_e$	700 mA
Voltage drop $U_d$	$\leq$ 1.5 V AC
Repeat accuracy	$\leq$ 5 mm
Switching frequency $f$	15 Hz
Range hysteresis H	approx. 15 mm
Temperature influence	$<$ 2 % of far switch point

**Standard conformity**

Standards	EN 60947-5-2
-----------	--------------

**Ambient conditions**

Ambient temperature	-25 ... 70 °C (-13 ... 158 °F)
Storage temperature	-40 ... 85 °C (-40 ... 185 °F)

**Mechanical specifications**

Connection type	5-pin , V95 connector
Protection degree	IP65
Material	
Housing	nickel plated brass; plastic components: PBT
Transducer	epoxy resin/hollow glass sphere mixture; polyurethane foam

**Approvals and certificates**

UL approval	cULus Listed, General Purpose
CSA approval	cCSAus Listed, General Purpose

**Dimensions**

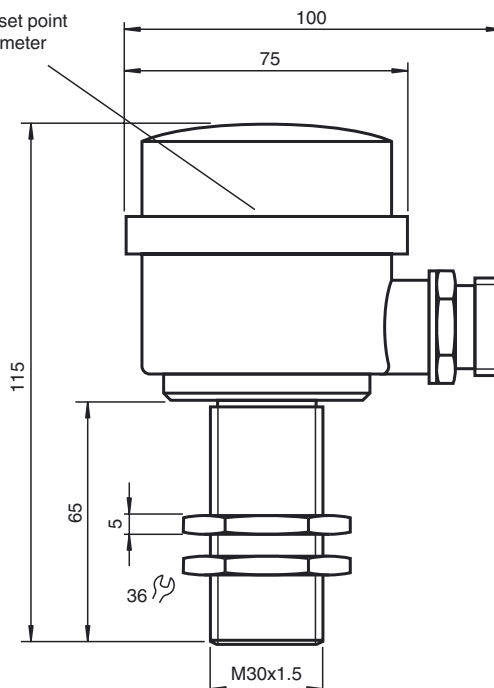

Release date: 2013-02-14 15:00 Date of issue: 2013-02-14 093950\_eng.xml

**Electrical Connection**

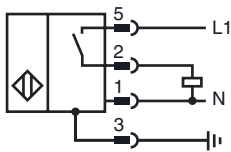

**Pinout**

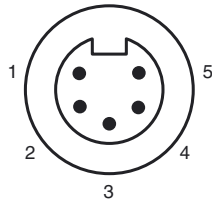

**Adjustment procedure**

The UB500 provides an N.O. switch point output between 70 mm (non-adjustable) and the potentiometer configured end point (70 - 500 mm). The sensing window end limit is adjusted as follows:

1. Place the target at the desired distance
2. Turn the sensing potentiometer (on the back of the unit) counterclockwise until the red output LED turns off.
3. Slowly turn the potentiometer clockwise. The sensing range is set when the red output LED turns on.

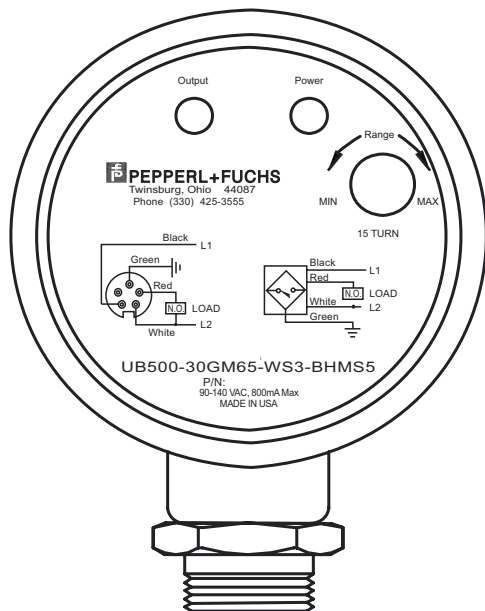

**Installation conditions**

If the sensor is installed in an environment where the temperature can fall below 0 °C, one of these mounting flanges must be used for mounting: BF30, BF30-F, or BF 5-30.

If the sensor is mounted in a through hole using the included steel nuts, it must be mounted at the middle of the threaded housing. If it must be mounted at the front end of the threaded housing, plastic nuts with centering ring (optional accessories) must be used.