



### Model Number

**V1S-G-DUO-PG11**

Field-attachable male connector,  
Duo version

### Features

- Screw terminal connection
- Metal locking
- Simple assembling of 2 signals to one M12 plug-in station
- Two double cable seals included in the delivery package
- Suitable for cable diameters 2 ... 3 mm und 4 ... 5 mm

### Dimensions

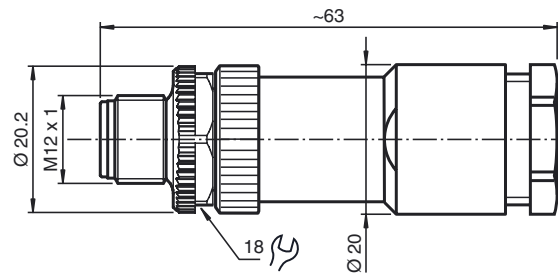

### Technical data

#### General specifications

Number of pins	4
Connection 1	Male connector
Construction type 1	straight
Threading 1	M12
UL File Number	E363587

#### Electrical specifications

Operating voltage	$U_B$	max. 250 V AC/DC
Operating current		max. 4 A
Volume resistance		< 8 m $\Omega$

#### Ambient conditions

Ambient temperature	-40 ... 85 °C (-40 ... 185 °F)
Pollution Degree	3

#### Mechanical specifications

Degree of protection	IP67
Connection	1 x M12 connector, straight Screw terminals for max. 0.75 mm <sup>2</sup>
Material	
Contacts	CuZn
Contact surface	CuSnZn
Body	PA
Cable	
Sheath diameter	2.1 ... 3 mm or 4 ... 5 mm

#### Compliance with standards and directives

Standard conformity	
Degree of protection	EN 60529:2000

### Electrical connection

