

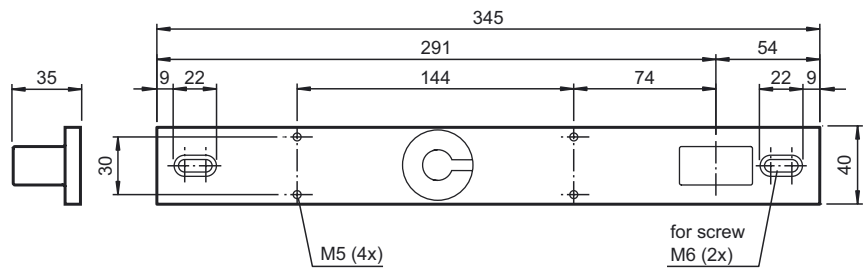

Dimensions



Model number

VAZ-IM1-BASE-S

Switch mount for mechanical safety switches (LIM1 and IM1)

Features

- For left and right-mounted doors
- Switch slot compatible with all mechanical safety switches

Function

In combination with VAZ-IM1-BASE-BOLT-S bar, the VAZ-IM1-BASE-S switch mount is a device for mounting safety switches onto commercially-available aluminum profiles and machine casings. The actuator is guided securely into the safety switch by the switch holder and the bar. The yellow color serves for quick recognition of the safety device. No further door handles are required because of the robust design. A slot enables the attachment of a lockout for additional security.

Matching system components

VAZ-IM1-BASE-BOLT-S

Latches for mechanical safety switches (LIM1 and IM1)

Technical data

Mechanical specifications

Material	GFK
Dimensions	Width 76 mm height 345 mm Depth 35 mm

Release date: 2008-11-13 11:00 Date of issue: 2014-01-13 210511_eng.xml