



Model Number

V3-GM-Q4

Female connector, M8, 3-pin, field attachable

Features

- Insulation displacement connection

Accessories

MH V3-SCREWDRIVER

torque screwdriver (0.2 Nm)

MH V3-BIT M8

plug-in cap for M8

Dimensions

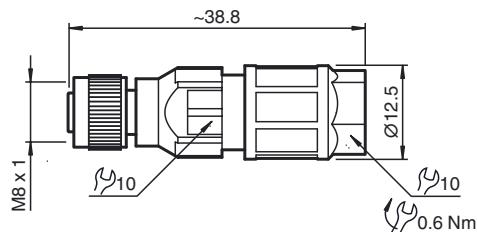

Technical data

General specifications

Number of pins	3
Connection 1	socket
Construction type 1	straight
Threading 1	M8

Electrical specifications

Operating voltage	U_B	max. 60 V AC/DC
Operating current		max. 4 A
Volume resistance		< 5 m Ω

Ambient conditions

Ambient temperature	-25 ... 80 °C (-13 ... 176 °F)
Pollution Degree	3

Mechanical specifications

Protection degree	IP65/IP67
Connection	1 x M8 socket, straight Insulation displacement connection for 0.25 ... 0.5 mm ²

Material

Contacts	CuSn
Contact surface	Ni/Au
Body	PA 6
Slotted nut	Zinc die-casting, nickel-plated
Seal	NBR
Core insulation	PVC/PE/PP
Cable	
Sheath diameter	2.5 ... 5 mm \pm 0.2 mm

Compliance with standards and directives

Standard conformity	
Protection degree	EN 60529:2000
Standards	IEC 61076-2-104:2008

Approvals and certificates

UL approval	UL Recognized
Maximum permissible operating voltage	\leq 29 V

Electrical connection

