



### Model Number

**V31-GM-Q4**

Female connector, M8, 4-pin, field attachable

### Features

- Insulation displacement connection

### Accessories

**MH V3-SCREWDRIVER**  
torque screwdriver (0.2 Nm)

**MH V3-BIT M8**  
plug-in cap for M8

## Dimensions

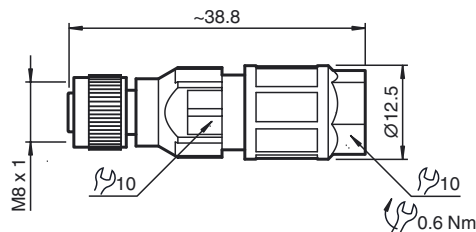

## Technical data

### General specifications

Number of pins	4
Connection 1	socket
Construction type 1	straight
Threading 1	M8

### Electrical specifications

Operating voltage	$U_B$	max. 30 V AC/DC
Operating current		max. 4 A
Volume resistance		< 5 m $\Omega$

### Ambient conditions

Ambient temperature	-25 ... 80 °C (-13 ... 176 °F)
Pollution Degree	3

### Mechanical specifications

Protection degree	IP65/IP67
Connection	1 x M8 socket, straight Insulation displacement connection for 0.25 ... 0.5 mm <sup>2</sup>

### Material

Contacts	CuSn
Contact surface	Ni/Au
Body	PA 6
Slotted nut	Zinc die-casting, nickel-plated
Seal	NBR
Core insulation	PVC/PE/PP
Cable	
Sheath diameter	2.5 ... 5 mm $\pm$ 0.2 mm

### Compliance with standards and directives

Standard conformity	
Protection degree	EN 60529:2000
Standards	IEC 61076-2-104:2008

### Approvals and certificates

UL approval	UL Recognized
Maximum permissible operating voltage	$\leq$ 29 V

## Electrical connection

