



Model Number

KLE-A16-2,2-2,0-K111

Plastic fiber optic - thru-beam

Features

- Wide sensing range

Series

Fiber optic amplifiers

Device series SU18 ; SU18/35 ; SU19 ; ML17-LL

Description

Attention:

Fiber optics must not be twisted or kinked. Excessive tensile loads will lead to destruction. Contact with petrol or organic solvents must be prevented.



Technical data

General specifications

Detection range	SU18: 100 mm SU18/35: 420 mm SU19: 100 mm
Fiber optic length	l 2000 mm , adjustable
Fiber optic diameter	d 2.2 mm
Adapter form	00
End piece	Array
Bending radius	min. 25 mm
Fiber configuration	Fv see dimensions
Angle of divergence	67 °
Accessories provided	Cutter for plastic fiber optics

Ambient conditions

Ambient temperature	-55 ... 70 °C (-67 ... 158 °F)
---------------------	--------------------------------

Mechanical specifications

Material	
Optical face	plastic
Sheathing	PVC
Core	plastic
End piece	brass, nickel-plated

General information

Scope of delivery	Fiber optic cables packaged in pairs
-------------------	--------------------------------------

Dimensions

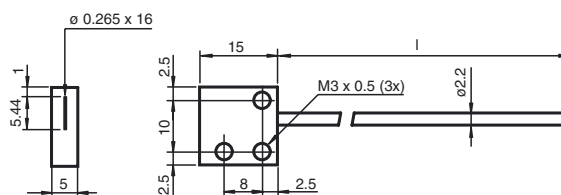

Release date: 2014-07-09 15:33 Date of issue: 2014-07-09 805848_eng.xml