



**EN** Operating instructions. . . . . pages 7 to 12  
Translation of the original operating instructions

**FR** Vous trouverez la version actuelle du mode d'emploi dans votre langue nationale officielle sur l'Internet, [www.schmersal.net](http://www.schmersal.net).

**ES** Encontrará el manual de instrucciones actual en su idioma oficial de la UE en nuestra página de Internet [www.schmersal.net](http://www.schmersal.net).

**NL** U vindt de huidige versie van de gebruikshandleiding in uw officiële landstaal op het Internet, [www.schmersal.net](http://www.schmersal.net).

**IT** Il manuale d'istruzioni aggiornato nella vostra lingua (lingua ufficiale UE) è scaricabile in Internet all'indirizzo [www.schmersal.net](http://www.schmersal.net).

**JP** EU公用語で書かれた最新の取扱説明書は、インターネット ([www.schmersal.net](http://www.schmersal.net)) からダウンロードできます。

**Content**

**1 About this document**

1.1 Function . . . . . 7

1.2 Target group: authorised qualified personnel. . . . . 7

1.3 Explanation of the symbols used . . . . . 7

1.4 Appropriate use . . . . . 7

1.5 General safety instructions . . . . . 7

1.6 Warning about misuse . . . . . 8

1.7 Exclusion of liability . . . . . 8

**2 Product description**

2.1 Ordering code . . . . . 8

2.2 Special versions. . . . . 8

2.3 Destination and use . . . . . 8

2.4 Technical data . . . . . 8

2.5 Safety classification . . . . . 8

**3 Mounting**

3.1 General mounting instructions . . . . . 9

3.2 Dimensions . . . . . 9

3.3 Axial misalignment. . . . . 9

3.4 Adjustment. . . . . 9

**4 Electrical connection**

4.1 General information for electrical connection. . . . . 9

4.2 Contact variants. . . . . 9

4.3 Connection. . . . . 10

**5 Set-up and maintenance**

5.1 Functional testing. . . . . 10

5.2 Maintenance . . . . . 10

**6 Disassembly and disposal**

6.1 Disassembly. . . . . 10

6.2 Disposal. . . . . 10

**7 Appendix**

7.1 EC Declaration of conformity . . . . . 11

**1. About this document**

**1.1 Function**

This operating instructions manual provides all the information you need for the mounting, set-up and commissioning to ensure the safe operation and disassembly of the safety switchgear. The operating instructions must be available in a legible condition and a complete version in the vicinity of the device.

**1.2 Target group: authorised qualified personnel**

All operations described in this operating instructions manual must be carried out by trained specialist personnel, authorised by the plant operator only.

Please make sure that you have read and understood these operating instructions and that you know all applicable legislations regarding occupational safety and accident prevention prior to installation and putting the component into operation.

The machine builder must carefully select the harmonised standards to be complied with as well as other technical specifications for the selection, mounting and integration of the components.

**1.3 Explanation of the symbols used**

 **Information, hint, note:**  
This symbol is used for identifying useful additional information.

 **Caution:** Failure to comply with this warning notice could lead to failures or malfunctions.  
**Warning:** Failure to comply with this warning notice could lead to physical injury and/or damage to the machine.

**1.4 Appropriate use**

The products described in these operating instructions are developed to execute safety-related functions as part of an entire plant or machine. It is the responsibility of the manufacturer of a machine or plant to ensure the correct functionality of the entire machinery or plant.

The safety switchgear must be exclusively used in accordance with the versions listed below or for the applications authorised by the manufacturer. Detailed information regarding the range of applications can be found in the chapter "Product description".

**1.5 General safety instructions**

The user must observe the safety instructions in this operating instructions manual, the country-specific installation standards as well as all prevailing safety regulations and accident prevention rules.

 Further technical information can be found in the Schmersal catalogues or in the online catalogue on the Internet: [www.schmersal.net](http://www.schmersal.net).

The information contained in this operating instructions manual is provided without liability and is subject to technical modifications.

There are no residual risks, provided that the safety instructions as well as the instructions regarding mounting, commissioning, operation and maintenance are observed.

### 1.6 Warning about misuse



In case of inadequate or improper use or manipulations of the safety switchgear, personal hazards or damage to machinery or plant components cannot be excluded. The relevant requirements of the standard EN 1088 must be observed.

### 1.7 Exclusion of liability

We shall accept no liability for damages and malfunctions resulting from defective mounting or failure to comply with this operating instructions manual. The manufacturer shall accept no liability for damages resulting from the use of unauthorised spare parts or accessories.

For safety reasons, invasive work on the device as well as arbitrary repairs, conversions and modifications to the device are strictly forbidden; the manufacturer shall accept no liability for damages resulting from such invasive work, arbitrary repairs, conversions and/or modifications to the device.

## 2. Product description

### 2.1 Ordering code

This operating instructions manual applies to the following types:

BNS 33S-12Z <sup>①</sup>		
No.	Option	Description
①	G	without LED with LED

### BPS 33S Actuator

### 2.2 Special versions

For special versions, which are not listed in the order code below 2.1, these specifications apply accordingly, provided that they correspond to the standard version.

### 2.3 Destination and use

The BNS 33S safety sensor is designed for application in safety circuits and is used for monitoring the position of movable safety guards to EN 1088 and IEC 60947-5-3. To actuate the safety sensors, only the BPS 33S actuators can be used.

The safety switches are used for applications, in which the hazardous situation is terminated without delay when the safety guard is opened.

Only the entire system consisting of the safety sensor (BNS 33S), the actuator (BPS 33S) and the safety-monitoring module (AES, SRB) meets the requirements of the standard IEC 60947-5-3.



Information for the selection of suitable safety-monitoring modules can be found in the Schmersal catalogues or in the online catalogue on the Internet: [www.schmersal.net](http://www.schmersal.net).

Technically, multiple safety sensors can be wired to one AES/SRB safety-monitoring module. To connect multiple safety sensors (check if authorised!), their NO contacts are wired in parallel and their NC contacts in series. The Protect-IE-11 or -02 or PROTECT-PE-11 (-AN) or -02 input expander module can be used to connect up to 4 safety sensors with NC/NC or NC/NO contacts.



In case of series-wiring at SRB max. 1 sensor with LED indication for  $U_N$ .

Except for the Protect IE or Protect PE expander module, safety sensors with LED must not be wired in series. The light intensity of the LED highly decreases due to the series-wiring and the voltage could drop below the minimum input voltage of the downstream safety-monitoring module. Please observe that the diagnostic coverage could decrease when multiple safety sensors are connected to one safety-monitoring module.



The user must evaluate and design the safety chain in accordance with the relevant standards and the required safety level.



If multiple safety components are wired in series, the Performance Level to EN ISO 13849-1 will be reduced due to the restricted error detection under certain circumstances.



The entire concept of the control system, in which the safety component is integrated, must be validated to the relevant standards.

### 2.4 Technical data

Standards:	IEC 60947-5-3, BG-GS-ET-14
Enclosure:	V4A stainless steel to DIN 1.3960
Protection class:	IP69K (to IEC/EN 60529)
Termination:	connecting cable LiYY (food-safe)
Connecting cable:	6 x 0.25 mm <sup>2</sup>
Operating principle:	magnetic
Actuator:	BPS 33S, coded
Limit distances:	
assured switching distance $s_{ao}$ :	8 mm
assured switch-off distance $s_{ar}$ :	18 mm
Switching condition indication:	LED only with ordering suffix G
Rated insulation voltage $U_i$ :	
- without LED:	125 VAC/DC
- with LED:	32 VAC/DC
Rated impulse withstand voltage $U_{imp}$ :	
-without LED:	1.5 kV
-with LED:	0.8 kV
Schaltspannung:	
-without LED:	max. 100 VAC/DC
-with LED:	max. 24 VDC
Switching current:	
- without LED:	max. 250 mA
- with LED:	max. 10 mA
Switching capacity:	
-without LED:	max. 3 W
-with LED:	max. 240 mW
Ambient temperature:	-25 °C ... +80 °C
Storage and transport temperature:	-25 °C ... +80 °C
Max. switching frequency:	5 Hz
Resistance to shock:	30 g / 11 ms
Resistance to vibration:	10 ... 55 Hz, amplitude 1 mm

### 2.5 Safety classification

Standards:	EN ISO 13849-1
$B_{10d}$ (NC/NO contact):	25,000,000 at max. 20 % contact load
Service life:	20 years

$$MTTF_d = \frac{B_{10d}}{0,1 \times n_{op}} \quad n_{op} = \frac{d_{op} \times h_{op} \times 3600 \text{ s/h}}{t_{cycle}}$$

(Specifications can vary depending on the application-specific parameters  $h_{op}$ ,  $d_{op}$  and  $t_{cycle}$  as well as the load.)

An individual switch can be used in a category 3 or 4 architecture up to PL e.

### 3. Mounting

#### 3.1 General mounting instructions

- Fitting is only authorised in a de-energised condition
- Do not use the sensor and the actuator as a mechanical backstop
- Any mounting position, provided that the active surfaces are opposite
- Inseparably fix the safety sensor and the actuator to the safety guard
- Ensure the safety sensor is mounted on a flat surfaces to avoid tensile stresses that could damage the sensor or lead to varying switching distances
- Do not install the safety sensor and the actuator in strong magnetic fields
- If possible, do not mount the sensor and the actuator on ferromagnetic material. When the sensor and the actuator are installed on ferromagnetic material, variations can be expected in the limit distances. The use of a non-magnetic spacer of at least 5 mm thick must be used. The use of non-magnetic fixing screws is recommended also.
- Do not subject the safety sensor and actuator to extreme vibrations and shocks.
- Keep away from metal chips
- The mounting distance between two sensors should always be at least 50 mm

#### 3.2 Dimensions

All measurements in mm.

##### Sensor with cable

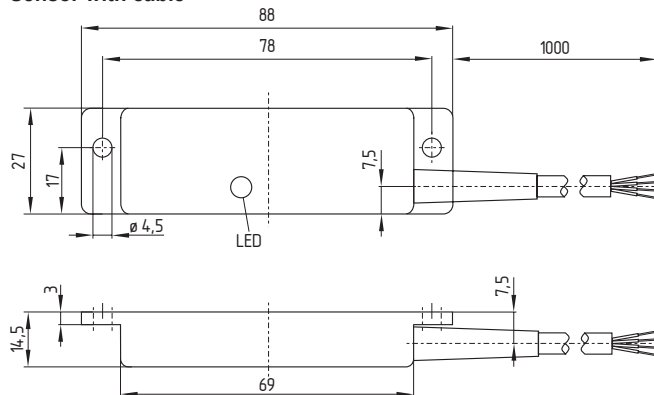

##### Actuator

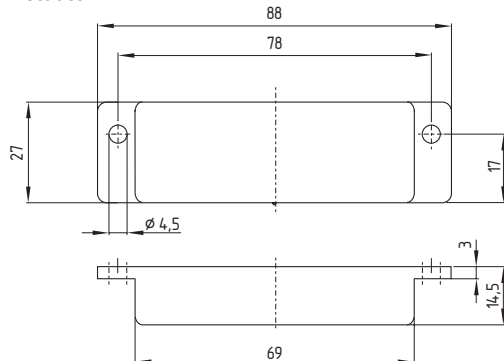

#### 3.3 Axial misalignment

A horizontal and vertical misalignment of the safety sensor and the actuator is tolerated. The possible misalignment depends on the distance of the active surfaces of the sensor and the actuator. The sensor remains active within the tolerance range.

The specified switching distances refer to oppositely mounted safety sensors and actuators.

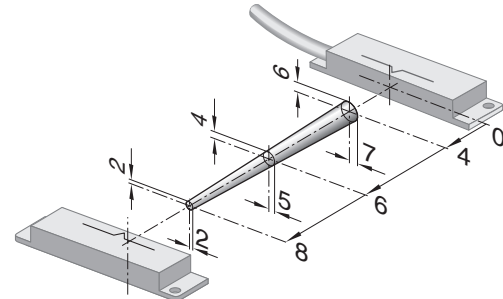

assured switching distance:  $s_{ao} = 8 \text{ mm}$

assured switch-off distance:  $s_{ar} = 18 \text{ mm}$

#### 3.4 Adjustment

The LED of the BNS 33S variants can only be used as a rough setting tool. The correct functionality of both safety channels must be checked by means of the connected safety-monitoring module.

### 4. Electrical connection

#### 4.1 General information for electrical connection



The electrical connection may only be carried out by authorised personnel in a de-energised condition.

The safety sensors must be wired in accordance with the specified wire colours.

#### 4.2 Contact variants

The contact position shows the actuated sensor function when the safety guard is closed. For safety sensors with LED, the LED is illuminated when the safety guard is closed. The contact configurations of the versions with or without LED are identical.

##### BNS 33S-12Z(G)

GY S13    S14 PK  
 GN S21    S22 YE  
 WH S31    S32 BN

### 4.3 Connection

The BNS 33S-12Z safety sensor is suitable for use in conjunction with safety-monitoring modules, which are controlled through NO/NC safety inputs or NC/NC safety inputs.

In these versions, the optional LED is integrated in the S21-S22 circuit.

#### Connection to safety-monitoring modules with NO / NC inputs:

NO: S13–S14 to the NO input of the safety-monitoring module  
(AES safety-monitoring module: terminal S13–S14)

NC: S21–S22 to the NC input S21–S22 of the safety-monitoring module

(AES safety-monitoring module: terminal S21–S22)

NC: S31 – S32 can be used as signalling contact

#### Connection to safety-monitoring modules with NC / NC inputs:

NC: S21–S22 to the 1st NC input of the safety-monitoring module  
(AES safety-monitoring module: terminal S11–S12)

NC: S31–S32 to the 2nd NC input of the safety-monitoring module  
(AES safety-monitoring module: terminal S21–S22)

NO: S13–S14 can be used as signalling contact

## 5. Set-up and maintenance

### 5.1 Functional testing

The safety function of the safety components must be tested. The following conditions must be previously checked and met:

1. Fitting of the sensor and the actuator
2. Fitting and integrity of the power cable
3. The system is free of dirt and soiling (in particular metal chips)

### 5.2 Maintenance

In the case of correct installation and adequate use, the safety sensor features maintenance-free functionality.

A regular visual inspection and functional test, including the following steps, is recommended:

- Check the fitting of the sensor and the actuator
- Remove possible metal chips
- Check the cable for damage.

**Damaged or defective components must be replaced.**

## 6. Disassembly and disposal

### 6.1 Disassembly



The safety switchgear must be disassembled in a de-energised condition only.

### 6.2 Disposal

The safety switchgear must be disposed of in an appropriate manner in accordance with the national prescriptions and legislations.

7. Appendix

7.1 EC Declaration of conformity

	
<h3>EC Declaration of conformity</h3>	
Translation of the original declaration of conformity	K. A. Schmersal GmbH & Co. KG Industrielle Sicherheitssysteme Mödinghofe 30, 42279 Wuppertal Germany Internet: www.schmersal.com
We hereby certify that the hereafter described safety components both in its basic design and construction conform to the applicable European Directives.	
<b>Name of the safety component:</b>	BNS 33S
<b>Description of the safety component:</b>	Coded safety-sensor with magnetic operating principle in combination with the AES / AZR / SRB safety-monitoring modules from Schmersal or an equivalent safety-oriented control system fulfilling the requirements of the IEC 60947-5-3.
<b>Relevant EC-Directives:</b>	2006/42/EC-EC-Machinery Directive
<b>Person authorized for the compilation of the technical documentation:</b>	Oliver Wacker Mödinghofe 30 42279 Wuppertal
<b>Place and date of issue:</b>	Wuppertal, November 9, 2012
BNS 33S-C-DE	
	Authorised signature <b>Philip Schmersal</b> Managing Director



The currently valid declaration of conformity can be downloaded from the internet at [www.schmersal.net](http://www.schmersal.net).



**K. A. Schmersal GmbH & Co. KG**  
**Industrielle Sicherheitssysteme**  
Möddinghofe 30, D - 42279 Wuppertal  
Postfach 24 02 63, D - 42232 Wuppertal

Phone: +49 - (0)2 02 - 64 74 - 0  
Telefax +49 - (0)2 02 - 64 74 - 1 00  
E-Mail: [info@schmersal.com](mailto:info@schmersal.com)  
Internet: <http://www.schmersal.com>