



EN Operating instructions. page 1
Original

Destination and use

! The actuator AZ/AZM300-B1 is not designed to be combined with the basic component of the EX-AZ/AZM300 series.

Dimensions

All measurements in mm.

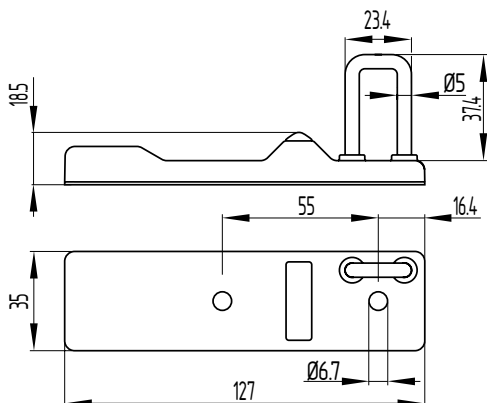

General mounting instructions

! Please observe the relevant requirements of the standards ISO 12100, EN 953 and ISO 14119.

To secure the solenoid interlock and the actuator, two securing holes for M6 bolts are provided in each case (tightening torque of securing bolts: 5 ... 6 Nm respectively).

! The safety component and the actuator must be permanently fitted to the safety guards and protected against displacement by suitable measures (tamperproof screws, gluing, drilling, pinning).

Any mounting position. The system must only be operated with an angle of $\leq 2^\circ$ between the safety component and the actuator.

Axial and horizontal misalignment

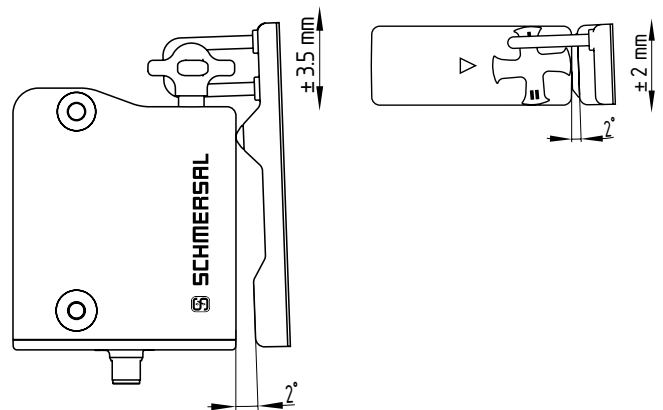

! Provide for a sufficient insertion of the actuator into the rotary handle.

Schematic diagram of installation situation

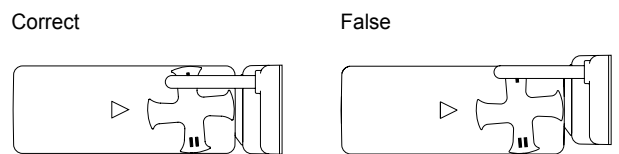

! The solenoid interlock can be used as an end stop. Depending on the door weight and the actuating speed, the mechanical life could be reduced.

K. A. Schmersal GmbH & Co. KG
Mödinghofe 30, D - 42279 Wuppertal
Postfach 24 02 63, D - 42232 Wuppertal

Phone: +49 - (0)2 02 - 64 74 - 0
Telefax: +49 - (0)2 02 - 64 74 - 1 00
E-Mail: info@schmersal.com
Internet: http://www.schmersal.com