



Main

| | |
|---------------------------------------|--------------------------------------------------------------------------------------------------------------------------------------------------------------------|
| Accessory / separate part destination | Ø 58 mm absolute single turn encoder with through shaft Ø 58 mm absolute multiturn encoder with through shaft Ø 58 mm incremental encoder with through shaft |
| Accessory / separate part category | Mounting and fixing accessories |
| Accessory / separate part type | Reduction collar |
| Product compatibility | XCC1514TS... XCC3514TS84... XCC2514TS81... |
| Diameter encoder side | 14 mm |
| Diameter machine side | 8 mm |

Complementary

| | |
|----------------|---------|
| Product weight | 0.01 kg |
|----------------|---------|

Offer Sustainability

| | |
|--------------------------|---------------------------------------------------------------------------------------|
| Sustainable offer status | Not Green Premium product |
| RoHS (date code: YYWW) | Compliant - since 0701 - Schneider Electric declaration of conformity |
| REACH | Reference not containing SVHC above the threshold |

The information provided in this documentation contains general descriptions and/or technical characteristics of the performance of the products contained herein. This documentation is not intended as a substitute for and is not to be used for determining suitability or reliability of these products for specific user applications. It is the duty of any such user or integrator to perform the appropriate and complete risk analysis, evaluation and testing of the products with respect to the relevant specific application or use thereof. Neither Schneider Electric Industries SAS nor any of its affiliates or subsidiaries shall be responsible or liable for misuse of the information contained herein.

Dimensions

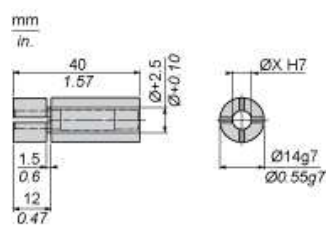

Ø

8 mm