



Main

Accessory / separate part destination	Ø 58 mm absolute single turn encoder with through shaft Ø 58 mm absolute multiturn encoder with through shaft Ø 58 mm incremental encoder with through shaft
Accessory / separate part category	Mounting and fixing accessories
Accessory / separate part type	Reduction collar
Product compatibility	XCC1514TS... XCC3514TS84... XCC2514TS81...
Diameter encoder side	14 mm
Diameter machine side	12 mm

Complementary

Product weight	0.01 kg
----------------	---------

Offer Sustainability

Sustainable offer status	Not Green Premium product
RoHS (date code: YYWW)	Compliant - since 0701 - Schneider Electric declaration of conformity
REACH	Reference not containing SVHC above the threshold

The information provided in this documentation contains general descriptions and/or technical characteristics of the performance of the products contained herein. This documentation is not intended as a substitute for and is not to be used for determining suitability or reliability of these products for specific user applications. It is the duty of any such user or integrator to perform the appropriate and complete risk analysis, evaluation and testing of the products with respect to the relevant specific application or use thereof. Neither Schneider Electric Industries SAS nor any of its affiliates or subsidiaries shall be responsible or liable for misuse of the information contained herein.

Dimensions

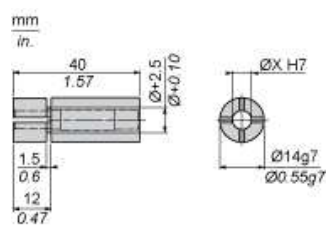

\varnothing
12 mm