



Switching automation light grids WLG

WLG12-V537



Model Name > **WLG12-V537**
Part No. > **1016045**



Illustration may differ

At a glance

- The direct output of individual beams for measuring and switching
- Response time 0.6 ms
- Eight visible transmission LEDs
- Eight PNP switching outputs and one alarm output
- Sensitivity can be set via a potentiometer
- Polarizing filter for reflective surfaces

Your benefits

- The WLG's fast response time keeps up with increased conveyor speeds, increasing throughput
- Detects translucent and semi-transparent objects for consistent detection of most objects
- Retro-reflective sensor saves space, installation time and cost
- Polarized retro-reflective light grids are designed to detect difficult reflective targets, such as stretch wrap and other thin films
- Visible red light reduces assembly time
- Multiple output versions indicate detection position and size of the object for closed loop process feedback and inspection



Features

Technology:	Retro-reflective light grid
Task:	Switching light grid
Minimum detectable object (MDO):	Parallel beam, 6 mm ... 12.5 mm
Beam separation:	12.5 mm
Number of beams:	8
Detection height:	87.5 mm
Resolution (adjustable) ¹⁾ :	6 mm ... 12.5 mm

¹⁾ Dependence of the range

Performance

Maximum range:	1.5 m
Minimum range:	≥100 mm
Working range:	1.5 m
Response time ¹⁾ :	Parallel beam: ≥0.6 ms

¹⁾ With resistive load

Interfaces

Output type: 1 x PNP (/Q)
Connection type: Connector M12, 5-pin

Mechanics/electronics

Wave length: 650 nm
Supply voltage V_s ¹⁾: DC 18 V ... 30 V
Power consumption sender: 80 mA
Ripple: < 5 Vpp
Output current $I_{max.}$: 100 mA
Output load capacitive: 100 nF
Output load inductive: 1 H
Initialization time: 0.6 s
Dimensions (W x H x D): 62 mm x 106 mm x 46.6 mm
Housing material: Plastic
Indication: LED
Enclosure rating: IP 67
Circuit protection: Output Q short-circuit protected
Interference suppression
VS connections reverse-polarity protected

Weight: 230 g
Front screen: PMMA
Output mode ²⁾: Q dark switching
Teach input: PNP

¹⁾ Typical value ²⁾ Q = active in case one beam is interrupted, /Q = active in case all beam are free

Ambient data

Protection class: II
EMC: EN 60947-5-2
Ambient temperature: Operation: -25 ... +55 °C
Storage: -20 ... +70 °C
Vibration resistance: 5 g, 10 Hz ... 55 Hz (IEC 68-2-6)
Shock load: 10 g/DIN EN 60068-2-29/16 ms

Dimensional drawing

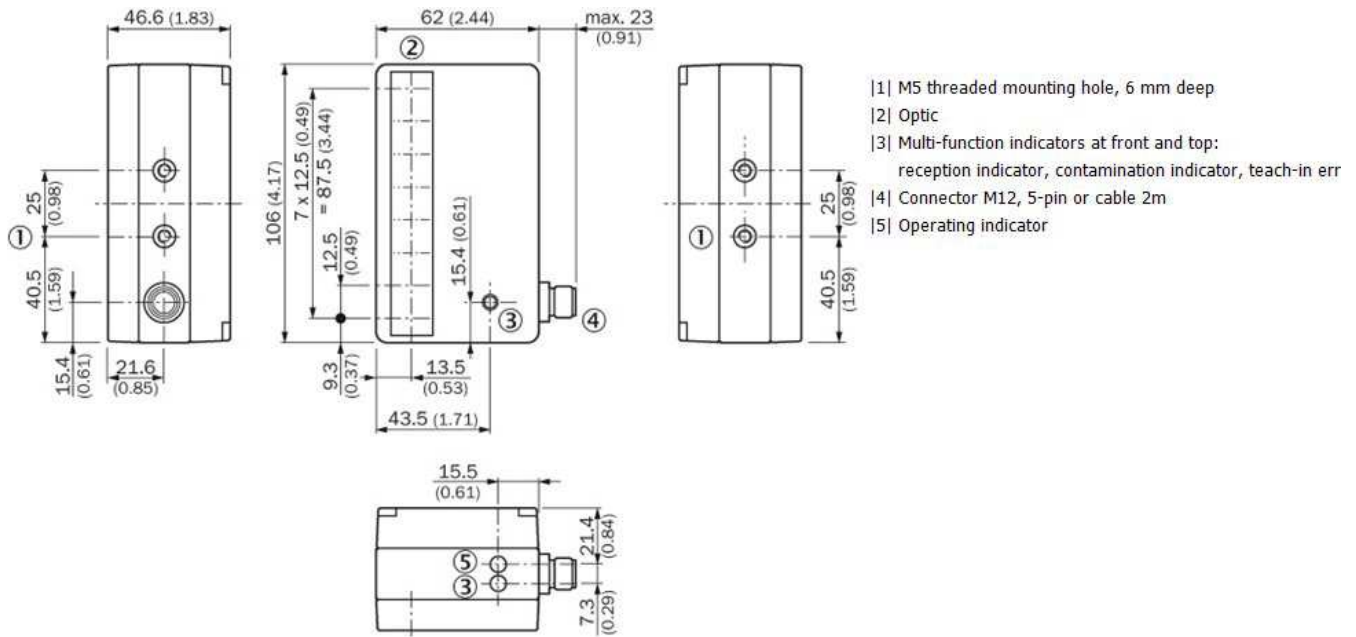

Adjustments



Choice of sensitivity range, dimensions in mm/m (inch)

Potentiometer setting	Resolution	Working range	Reflector
1	> 12.5 mm (0.49)	1.5 m (59.06)	2 x PL80A/PL40A
2	> 10 mm (0.39)	1.2 m (47.24)	2 x PL80A/PL40A
3	> 9 mm (0.35)	1.0 m (39.37)	PL180E01
4	> 7 mm (0.28)	0.8 m (31.50)	PL180E01
5	> 6 mm (0.24)	0.4 m (15.75)	PL180E01

1] Potentiometer for sensitivity adjustment

Connection type and diagram

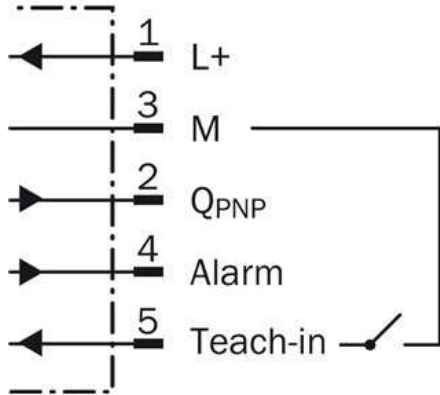
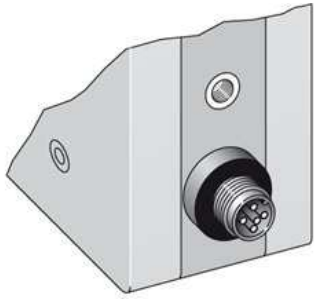

Australia

Phone +61 3 9457 0600
1800 33 48 02 – tollfree
E-Mail sales@sick.com.au

Belgium/Luxembourg

Phone +32 (0)2 466 55 66
E-Mail info@sick.be

Brasil

Phone +55 11 3215-4900
E-Mail marketing@sick.com.br

Canada

Phone +1 905 771 14 44
E-Mail information@sick.com

Česká republika

Phone +420 2 57 91 18 50
E-Mail sick@sick.cz

China

Phone +86 4000 121 000
E-Mail info.china@sick.net.cn
Phone +852-2153 6300
E-Mail ghk@sick.com.hk

Danmark

Phone +45 45 82 64 00
E-Mail sick@sick.dk

Deutschland

Phone +49 211 5301-301
E-Mail info@sick.de

España

Phone +34 93 480 31 00
E-Mail info@sick.es

France

Phone +33 1 64 62 35 00
E-Mail info@sick.fr

Great Britain

Phone +44 (0)1727 831121
E-Mail info@sick.co.uk

India

Phone +91-22-4033 8333
E-Mail info@sick-india.com

Israel

Phone +972-4-6881000
E-Mail info@sick-sensors.com

Italia

Phone +39 02 27 43 41
E-Mail info@sick.it

Japan

Phone +81 (0)3 5309 2112
E-Mail support@sick.jp

Magyarország

Phone +36 1 371 2680
E-Mail office@sick.hu

Nederland

Phone +31 (0)30 229 25 44
E-Mail info@sick.nl

Norge

Phone +47 67 81 50 00
E-Mail sick@sick.no

Österreich

Phone +43 (0)22 36 62 28 8-0
E-Mail office@sick.at

Polska

Phone +48 22 837 40 50
E-Mail info@sick.pl

România

Phone +40 356 171 120
E-Mail office@sick.ro

Russia

Phone +7-495-775-05-30
E-Mail info@sick.ru

Schweiz

Phone +41 41 619 29 39
E-Mail contact@sick.ch

Singapore

Phone +65 6744 3732
E-Mail sales.gsg@sick.com

Slovenija

Phone +386 (0)1-47 69 990
E-Mail office@sick.si

South Africa

Phone +27 11 472 3733
E-Mail info@sickautomation.co.za

South Korea

Phone +82 2 786 6321/4
E-Mail info@sickkorea.net

Suomi

Phone +358-9-25 15 800
E-Mail sick@sick.fi

Sverige

Phone +46 10 110 10 00
E-Mail info@sick.se

Taiwan

Phone +886 2 2375-6288
E-Mail sales@sick.com.tw

Türkiye

Phone +90 (216) 528 50 00
E-Mail info@sick.com.tr

United Arab Emirates

Phone +971 (0) 4 88 65 878
E-Mail info@sick.ae

USA/México

Phone +1(952) 941-6780
1 (800) 325-7425 – tollfree
E-Mail info@sickusa.com

More representatives and agencies
at www.sick.com